

TELESCOPIC LADDER

PTL-3200, 3800, 4100, 4400, 4900, 5200

OWNERS MANUAL

EN

This manual has been produced by Parker Products Ltd. and should be kept with the product and referenced for operation, maintenance and troubleshooting.

This manual contains an overall description of the product, together with all the necessary information for using the product correctly and safely. It is highly recommended that this manual is read prior to any operation or maintenance of this product. The safety precautions and warnings are to ensure your safety and protect you from harm or damage to the product.

All photographs and drawings in this manual are supplied by Parker Products Ltd. to help you with the operation and maintenance of the product. The information contained in this manual was accurate at the time of production, however Parker Products Ltd. may make modifications to the product without notification. This Telescopic ladder has been designed for personal and private use only.

The product is to be used only for its prescribed purpose, any other use is deemed to be a case of misuse. The user/operator and not the manufacturer will be liable for any damage or injuries of any kind caused as a result of this.

Please note that our equipment has not been designed for use in commercial, trade or industrial applications. Our warranty will be voided if the machine is used in commercial, trade or industrial businesses or for equivalent purposes.

DESCRIPTION OF PARTS 4

SAFETY INFORMATION 6-10

PRE-OPERATION CHECKLIST 9

OPERATION 10-11

EXTENDING THE LADDER 12-13

CLOSING THE LADDER 14-15

GUARANTEE 17

SPECIFICATIONS 18

DECLARATION OF CONFORMITY 19

DESCRIPTION OF PRODUCT PARTS

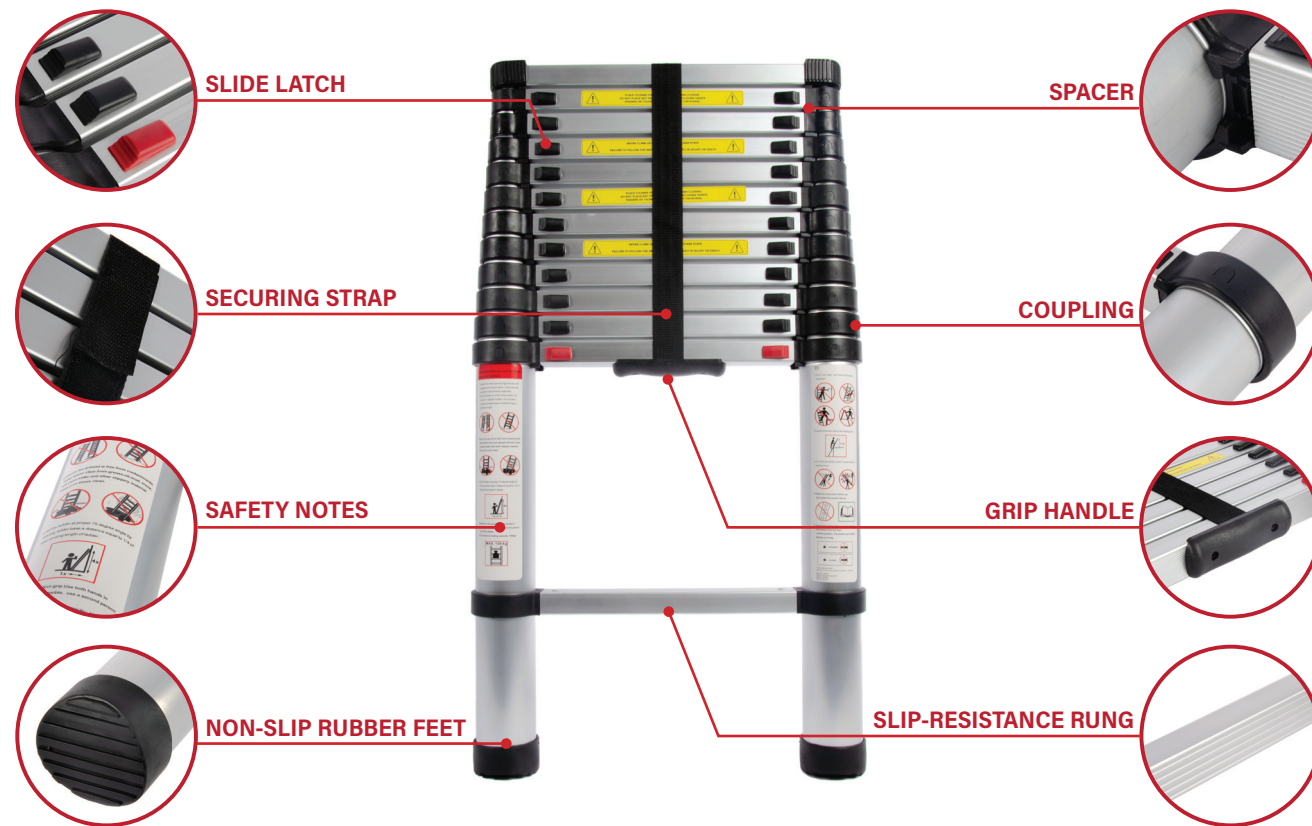

THIS PAGE HAS INTENTIONALLY BEEN LEFT BLANK

- Always extend the ladders from the bottom.
- Do not exceed the maximum total load.
- Do not overreach, users should keep both feet on the same step throughout the task.
- Do not step off a leaning ladder at a higher level without additional security, such as tying off or use of a suitable stability device.
- Do not use standing ladders for access to another level.
- Do not stand on the top three steps/rungs of a leaning ladder.
- Ladders should only be used for light work of a short duration.
- Do not use the ladder outside in adverse weather conditions, such as a strong wind.
- Take precautions against children playing on the ladder.
- Face the ladder when ascending and descending.
- Do not use the ladder as a bridge.
- Wear suitable footwear when climbing a ladder.
- Avoid excessive side loadings e.g. drilling brick or concrete.
- Do not spend long periods on a ladder without regular breaks (tiredness is a risk).
- Leaning ladders used for access to a higher level should be extended at least 1m above the landing point.
- Equipment carried while using a ladder should be light and easy to handle.

**PLEASE READ THESE INSTRUCTIONS FULLY BEFORE USE/OPERATING****Description Of Symbols.**

Symbols are used in this manual to attract your attention to possible risks. The safety symbols and the explications which accompany them must be perfectly understood. The warning themselves do not prevent the risks and cannot be a substitute for proper methods of avoiding accidents.



WARNING- To reduce the risk of injury, user must read instruction manual.



This symbol, before a safety comment, indicates a precaution, a warning or a danger. Ignoring this warning can lead to an accident for yourself or for others. To limit the risk of injury, fire, or electrocution always apply the recommendations indicated.



PLACE LADDER ON A FIRM AND LEVEL SURFACE



DO NOT OVERREACH



ENSURE GROUND AND LADDER IS FREE FROM CONTAMINANTS



DO NOT STEP OFF THE SIDE OF THE LADDER



ERECT AND PLACE LADDER AT PROPER 75° ANGLE



EXTEND LADDER 1M ABOVE LANDING POINT



**MAX LOADING CAPACITY
150KG / 330lbs**



BEWARE OF ELECTRICAL HAZARDS WHEN TRANSPORTING LADDER

BEFORE USE

- Ensure that you are fit enough to use the ladder. Certain medical conditions or medication, alcohol or drug abuse could make the ladder unsafe.
- When transporting ladders on roof bars or in a truck, ensure they are suitably placed to prevent damage.
- Inspect the ladder after delivery and before first use to confirm condition and operation of all parts.
- Visually check the ladder is not damaged and is safe to use at the start of each working day when the ladder is to be used.
- Regular periodic inspection is required.
- Ensure the ladder is suitable for the task.
- Do not use a damaged ladder.
- Remove any contamination from the ladder such as wet paint, mud, oil or snow.
- Before using a ladder at work a risk assessment should be carried out respecting the legislation in the country of use.

POSITIONING AND ERECTING THE LADDER

- Always extend the ladder from the bottom.
- Inclination angle should not exceed 75 degrees.
- The ladder should be on an even, level and unmovable base.
- The ladder should lean against a flat non-frangible surface and should be secured before use, e.g. tied or use of a suitable stability device.
- When positioning the ladder take into account the risk of collision with the ladder e.g. from pedestrians, vehicles or doors (no fire exits) and windows where possible in the work area.
- Identify any electrical risks in the work area, such as overhead lines or other exposed electrical equipment.
- The ladder should be stood on its feet, not the rungs or steps.
- Ladders should not be positioned on a slippery surface (such as ice, shiny surface or significantly contaminated solid surface) unless additional effective measures are taken to prevent the ladder slipping or ensuring contaminated surfaces are sufficiently clean.

EN 131 is a certification which confirms a product meets the European minimum safety standards expected of manufacturers. It governs aspects of construction, performance and the clarity of the attached instructions, ultimately resulting in ladders which are reliably built and easy to use.

In accordance with the EN 131 certification all ParkerBrand Telescopic Ladders **MUST** be extended from the bottom rung upwards. Please follow this user guide closely to ensure not only the proper use of this product but also for your own personal safety whilst in use.

EXTEND THE LADDERS FROM THE BOTTOM

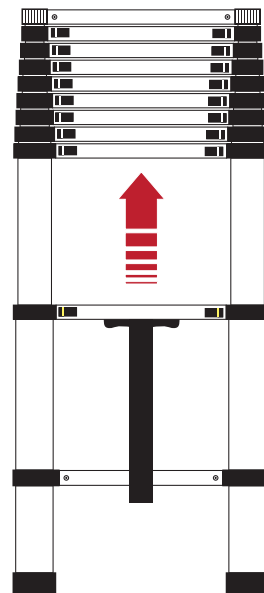
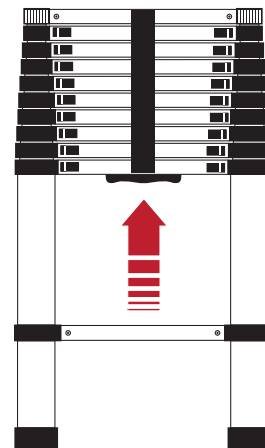

NOTE: Always use your ladders as described within the guidelines of this user manual.
WARNING!: When partially extending your telescopic ladders always extend from the bottom rung upwards.

AUTOMATIC LOCKING MECHANISM

Automatic Locking: each rung of your ladder has 2 locking pins that are automatically inserted into slots on the uprights when the ladder is extended.

The status of the lock is indicated by the two black slide latches on the side of each rung.

- The slide latch is in the unlocked when positioned furthest away from the coupling (see Fig 1)
- The slide latch is in the locked position when positioned closest to the coupling (see Fig 2)
- Always check that slide latches are located in the exact position "locked", before you climb the ladder.



WARNING! Under no circumstances should you attempt to 'UNLOCK' slide latches whilst ladders are in use.



Fig 1.

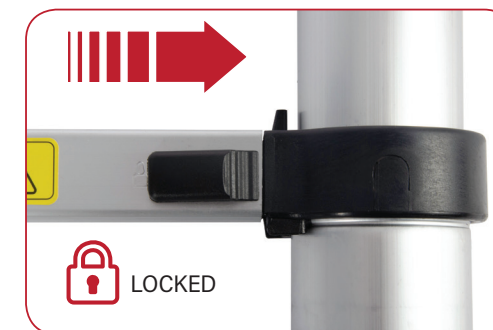
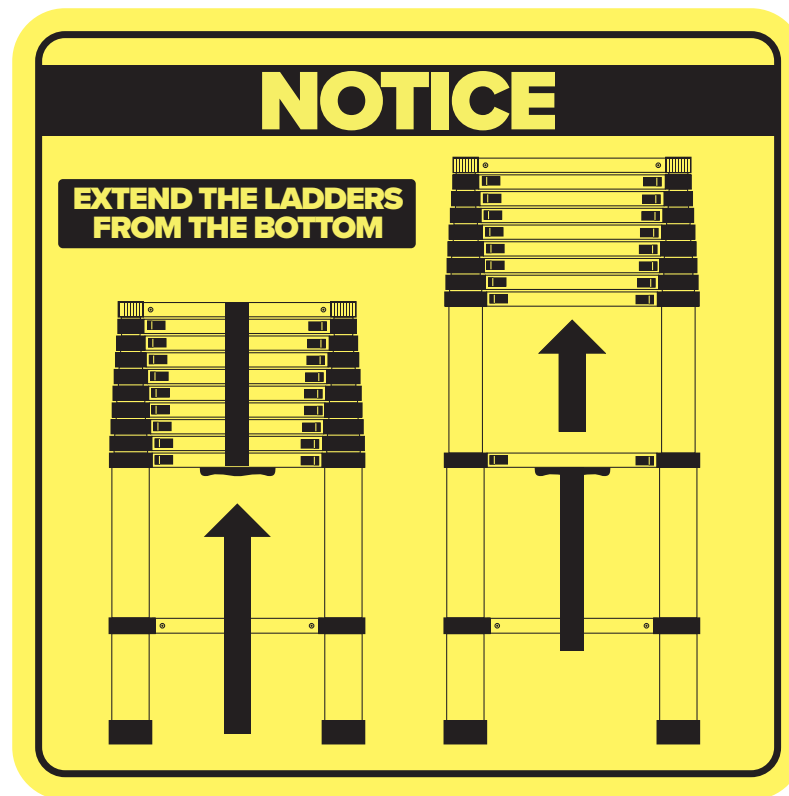
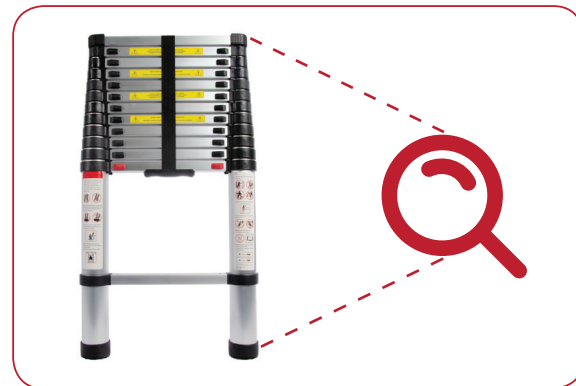

Fig 2.



1 INSPECT THE LADDER



Check the ladder is not damaged and all components are in good working order before use. Regular periodic inspection is required to ensure the ladder is suitable for the task.

Before using the ladder a risk assessment should be carried out respecting the legislation in the country of use.

2 STABILIZE BASE



Place Ladder on a dry, firm and level surface. Stabilize by placing a foot on the bottom rung.

3 EXTEND & LOCK



Hold the couplings on the section to be extended and pull upwards. Remember to extend from the bottom.

After every section is fully extended the slide latches will lock into place. (See step 4)

4 CHECK SLIDE LATCHES

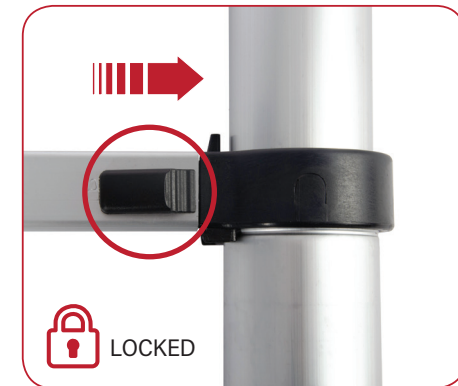

Before using the extended ladder check that all the slide latches are in the correct 'LOCKED' position.

The latches are spring loaded and should lock automatically on extension.

1 A PARTIALLY CLOSING LADDER



To reduce the height of the ladder - slide the latches on the level to which you want to reduce the height to.

Ensure your hands are not between the rungs when collapsing the ladder, follow the above safety guidelines at all times.

1 B FULLY CLOSING LADDER



To fully collapse the ladder regardless of the height set, hold the ladder firmly and slide the two red latches to the unlock position.

The red latches are at the bottom of the ladder and should only be used to fully collapse the ladder.

2 SECTION SOFT CLOSE



The ladder will collapse from the bottom upwards. As an added safety feature each section will 'Soft Close'.

When the ladder has collapsed - check all the slide latches on the other levels to ensure they are in the fully locked position.

3 CHECK SLIDE LATCHES

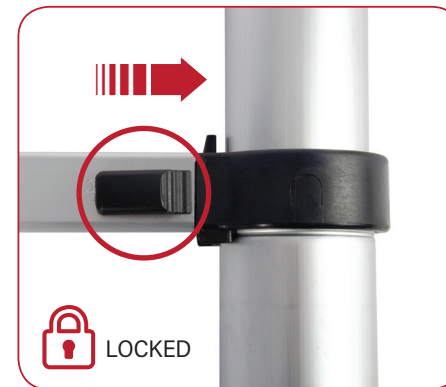

Make sure all slide latches are in the 'LOCKED' position (shown above). Take time to check all latches.

For your own safety it is essential that the slide latches are in the 'LOCKED' position before use.

4 INSPECTION & MAINTENANCE



After use check the condition of the ladder. Clean surfaces of any contaminants that may have come into contact during use.

Regular periodic inspection is required to maintain the ladder.

5 STORAGE



When the ladder is in the fully closed position you can now secure the strap and pack away until next required.

Please remember that when the ladder is in the fully closed position always carry from the grab handle to prevent opening.

THIS PAGE HAS INTENTIONALLY BEEN LEFT BLANK

Parker Products Ltd Guarantees the product against defective material or damage for a period of 12 months from the date of purchase. A proof of purchase must be provided with the product.

In case of any fault please return the product to Parker Products Ltd or an authorised repair agent.

If any fault is caused by defective materials or quality of build, repair will be carried out free of charge. However, this guarantee does not apply in the case of normal wear and tear, nor any damage caused by misuse, accident or any repair from an unauthorised agency.

NOTE: In order for you to effect this guarantee you must provide proof of purchase in the form of a dated receipt or invoice within a 12 month period of purchase. If repairs are outside of the warranty period a quote will be made accordingly.

Parker Products Limited

SPECIFICATIONS

TECHNICAL SPECIFICATION PTL-3200

Folded Height	0.8m (80cm)
Fully Extended Height	3.2m (3,200cm)
Width	470mm (47cm)
Number. of Rungs	11
Width of Rungs	39mm (3.9cm)
Weight	8KG
Grab handle	Plastic
Securing Strap	Velcro
Construction	Aluminium

TECHNICAL SPECIFICATION PTL-4400

Folded Height	0.92m (92cm)
Fully Extended Height	4.4m (4,400cm)
Width	480mm (48cm)
Number. of Rungs	15
Width of Rungs	39mm (3.9cm)
Weight	12.3KG
Grab handle	Plastic
Securing Strap	Velcro
Construction	Aluminium

TECHNICAL SPECIFICATION PTL-3800

Folded Height	0.86m (86cm)
Fully Extended Height	3.8m (3,800cm)
Width	480mm (48cm)
Number. of Rungs	13
Width of Rungs	39mm (3.9cm)
Weight	10KG
Grab handle	Plastic
Securing Strap	Velcro
Construction	Aluminium

TECHNICAL SPECIFICATION PTL-4900

Folded Height	0.94m (94cm)
Fully Extended Height	4.9m (4,900cm)
Width	480mm (48cm)
Number. of Rungs	14
Width of Rungs	39mm (3.9cm)
Weight	12.8KG
Grab handle	Plastic
Securing Strap	Velcro
Construction	Aluminium

TECHNICAL SPECIFICATION PTL-4100

Folded Height	0.89m (89cm)
Fully Extended Height	4.1m (4,100cm)
Width	480mm (48cm)
Number. of Rungs	14
Width of Rungs	39mm (3.9cm)
Weight	11.1KG
Grab handle	Plastic
Securing Strap	Velcro
Construction	Aluminium

TECHNICAL SPECIFICATION PTL-5200

Folded Height	0.97m (97cm)
Fully Extended Height	5.2m (5,200cm)
Width	480mm (48cm)
Number. of Rungs	15
Width of Rungs	39mm (3.9cm)
Weight	14.2KG
Grab handle	Plastic
Securing Strap	Velcro
Construction	Aluminium

Description & Function:
Telescopic Ladder

Model/Type:
PTL-3200/3800/4100/4400/4900/5200

Manufacturing Date/Serial Number:
2018

Conforms to the following Directives:

☒ EN131

Manufacturer's authorised representative within the EC:

Parker Products Ltd.
Richmond Park
Richmond Road
Louth
LN11 0FU

DECLARATION OF CONFORMITY

Confirmed and completed by:
Parker Products Ltd

Being the responsible person appointed by the manufacturer.

Signed:



Date: 01/01/18
Name: Jason Parker
Position: Managing Director
Company: Parker Products Ltd.



PTL-3200, 3800, 4100, 4400, 4900, 5200

WWW.PARKERBRAND.CO.UK