

PRESSURE WASHER

PPPW-3100

OWNERS MANUAL

EN

This manual has been produced by Parker Products Ltd. and should be kept with the product and referenced for operation, maintenance and troubleshooting.

This manual contains an overall description of the product, together with all the necessary information for using the product correctly and safely. It is highly recommended that this manual is read prior to any operation or maintenance of this product. The safety precautions and warnings are to ensure your safety and protect you from harm or damage to the product.

All photographs and drawings in this manual are supplied by Parker Products Ltd. to help you with the operation and maintenance of the product. The information contained in this manual was accurate at the time of production, however Parker Products Ltd. may make modifications to the product without notification.

*Parker Products Ltd.
Richmond Park
Richmond Road
Louth
LN11 0FU*

FOR SAFE OPERATION	4-7
PARTS ASSEMBLY	8-9
FEATURES	10-11
ASSEMBLY	12-15
STARTING THE ENGINE	16-19
TURNING OFF THE ENGINE	20-21
OPERATING THE SPRAY GUN	22
USING SPRAY NOZZLE	24
APPLYING DETERGENT	25
MAINTENANCE	26-28
TROUBLESHOOTING	30-32
MAINTANENCE SCHEDULE	33
DIAGRAM	34
SPECIFICATIONS	36
DECLARATION OF CONFORMITY	37

FOR SAFE OPERATION



GLOVES

Gloves should be worn where appropriate.



HEARING PROTECTION

Hearing protection should be worn to prevent damage to your ears. Ensure your hearing protection provides adequate noise reduction.



EYE PROTECTION

Approved eye protection should be worn at all times during operation.



BOOTS

Wear sturdy, non-slip boots.



CLOTHING

Appropriate clothing should be worn during operation. Ensure clothing is made of strong fabric and is not baggy or loose.

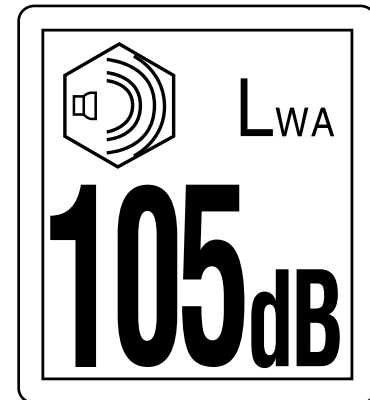

- Read and understand this manual in its entirety before operating this pressure washer. Improper use of this pressure washer could result in serious injury or death.
- This machine has been designed for use with the cleaning agent supplied or recommended by the manufacturer. The use of other cleaning agents or chemicals may adversely affect the safety of the machine.
- Do not use the machine within range of persons unless they wear protective clothing.
- Spray from this unit has extreme pressure and can ricochet back splashing water or propelling objects towards eyes.
- Never substitute eye protection with dry condition goggles.
- Pressure washer can create puddles and slippery surfaces. Never wear sandals, always wear protective footwear.
- Operate pressure washer from a level and stable surface.
- Do not operate from a ladder, scaffolding, or uneven surface as recoil from spray gun could cause you to fall.
- Do not over-extend yourself in attempt to reach a little further.
- Do not direct the jet against yourself or others in order to clean clothes or foot-wear.
- Risk of explosion - do not spray flammable liquids.
- High pressure cleaners shall not be used by children or untrained personnel.

FOR SAFE OPERATION

- High pressure hoses, fitting and couplings are important for the safety of the machine. Use only hoses, fittings and couplings recommended by the manufacturer.
- To ensure machine safety, use only original spare parts from the manufacturer or approved by the manufacturer.
- **Water that has flowed through backflow preventers is considered to be non-potable.**
- The machine shall be disconnected from its power source during cleaning or maintenance and when replacing parts or converting the machine to another function.
- Do not use the machine if a supply cord or important parts of the machine are damaged e.g. safety devices, high pressure hoses, trigger gun.
- Do not use combustion engine powered machines indoors unless adequate ventilation is assessed by national labour authorities.
- Carbon monoxide gas is a poisonous, odorless gas that can cause headache, confusion, fatigue, nausea, fainting, sickness, seizures, or death. If you start to experience any of these symptoms **IMMEDIATELY** get fresh air and seek medical attention.
- Never use indoors, in a covered area, or in a confined space, even if doors and windows are open.
- Ensure that any exhaust emissions are not in the vicinity of air intakes.

FOR SAFE OPERATION

- For gas or oil-heated machines it is important to provide adequate ventilate and make sure that the flue gases are properly discharged.
- Incorrect fuels shall not be used as they may prove hazardous.
- Never spray near a power source such as an electrical outlet. Making contact with a power source could cause an electric shock or burn.
- Stay alert and use common sense. Do not operate this unit if you are under the influence of alcohol, drugs, medication or you feel tired.
- High pressure jets can be dangerous if subject to misuse. The jet must not be directed at persons, live electrical equipment or the machine itself.
- The high pressure stream of water produced can cut through skin and underlying tissue. Never squeeze the trigger or point the spray gun at other people, animals, plants, or fragile objects such as glass, even if the engine is stopped.
- This unit is not a toy. Keep it away from children and pets.
- Do not leave spray gun unattended while unit is running.
- Make sure the spray gun, nozzle, and accessories are attached correctly.
- Never attempt to repair high pressure hose, always replace.
- Never attempt to repair leaks with sealant, always replace O-ring or seal.
- Never attempt to connect or disconnect hose from pump or spray gun while system is pressurised.
- Always release water pressure from unit every time you stop the engine.
- Avoid contacting hot areas of this unit.
- Use caution around the muffler and other engine parts as they can be extremely hot.
- Allow hot components to cool before touching.
- Moving parts can catch clothing, jewelry and hair.
- Do not wear loose clothing or gloves.
- Remove jewellery or anything else that could be caught in moving parts.
- Tie back or wear protective head covering to contain long hair.
- Keep engine away from flammable objects and other hazardous materials.
- The fuel and its vapours used to power this unit are highly flammable and could explode resulting in serious injury or death.
- Never overfill fuel tank. If fuel spills, move the unit at least 30 feet away from the spill and wipe up any remaining fuel on the unit before starting the engine.
- Never smoke while operating or fuelling this unit.
- Never operate or store this unit near an open flame, heat, or any other ignition source.
- Keep engine free of grass, leaves, or grease which are flammable.

FOR SAFE OPERATION

- When adding or draining fuel, unit should be turned off for at least 2 minutes to cool before removing fuel cap. If unit has been running the cap is under pressure, remove slowly.
- To keep fuel from spilling, secure unit so it cannot tip while operating or transporting.
- When transporting unit, disconnect the spark plug wire and make sure the fuel tank is empty with the fuel shutoff valve turned to the off position.
- The machine can be used by people with reduced physical, sensory or mental capabilities or lack of experience and knowledge if they have been given supervision or instruction concerning use of the machine in safe way and understand the hazards involved.

PARTS ASSEMBLY

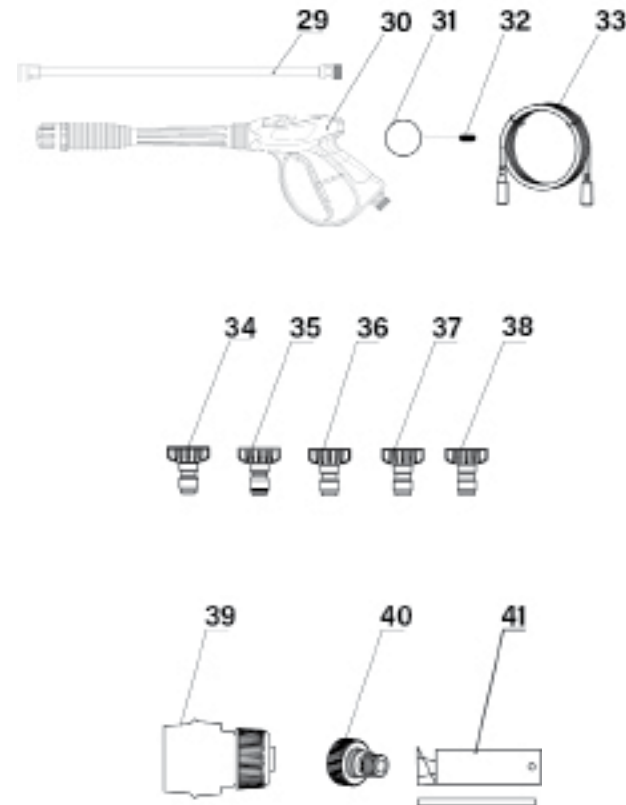
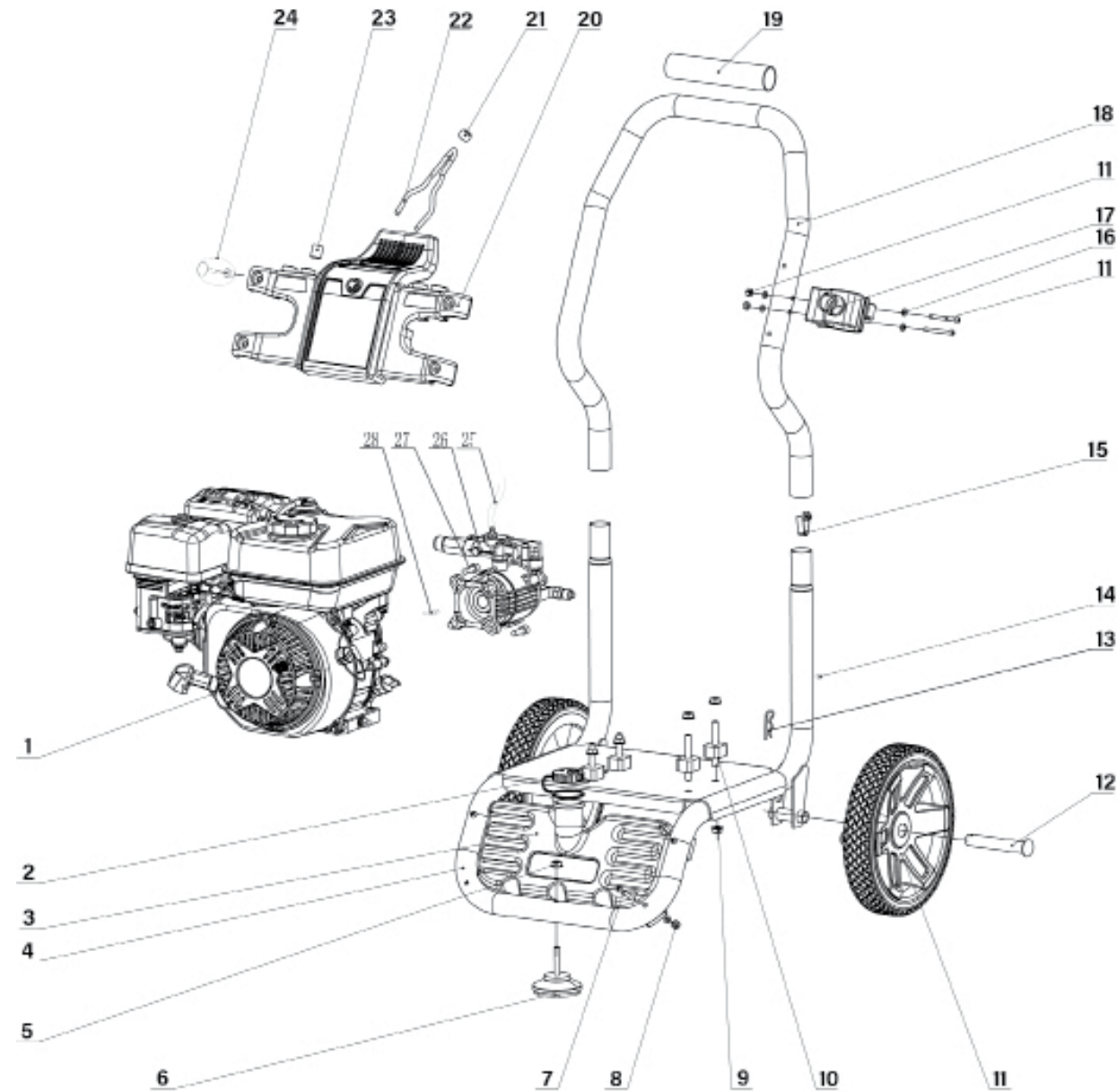



PARTS ASSEMBLY

NUMBER	ITEM NAME	QTY	NUMBER	ITEM NAME	QTY
1	ENGINE	1	22	WIRE	1
2	DETERGENT TANK CAP	1	23	NOZZLE HOLDER	5
3	DETERGENT TANK	1	24	ROTATIONAL SCREW	4
4	LOWER FRAME ASSEMBLY	1	25	PIPE	1
5	NUT M8	1	26	WATER PUMP	1
6	RUBBER FEET	1	27	BOLT M8*25	4
7	ROUND HEAD BOLT GB/T 818-76 M6X45	6	28	FLAT KEY	1
8	NUT M6	6	29	LANCE	1
9	NUT	8	30	GUN	1
10	ISOLATOR	4	31	PIN	1
11	WHEEL	2	32	PIN COVER	1
12	AXLE	2	33	HIGH PRESSURE HOSE	1
13	HAIR PIN	2	34	NOZZLE RED	1
14	CLIP Q	3	35	NOZZLE YELLOW	1
15	PLASTIC RIVET	2	36	NOZZLE GREEN	1
16	WASHER	6	37	NOZZLE WHITE	1
17	UPPER HOOK	1	38	NOZZLE SOAP	1
18	HANDLE FRAME	1	39	CONNECTOR FEMALE	1
19	FOAM COTTON HANDLE	1	40	CONNECTOR MALE	1
20	PANEL	1	41	SPARK WRENCH	1
21	FASTENER	1			

PACKING LIST

- Pressure washer
- Quick start guide
- Operator's manual
- Engine manual
- Spray gun
- Extension wand with quick-connect fitting
- High pressure hose
- 5 spray nozzles - 0°, 15°, 25°, 40° and soap nozzle
- Accessory hook
- Foot
- Nozzle cleaner

 Do not operate this pressure washer if any of the parts are damaged or missing until the part is replaced. Using this product with damaged or missing parts can cause damage to the machine or result in serious injury or death.

 Do not attempt to assemble or operate this pressure washer until you have read and understood this entire manual. If you have any problems assembling or operating this unit contact your dealer or a qualified service center.

FEATURES



FEATURES



1

ATTACH FOOT ASSEMBLY

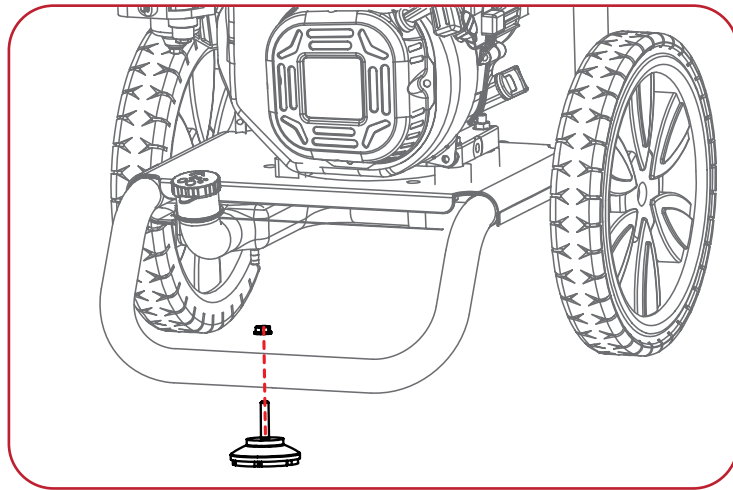

Parts needed: 1 x foot + 1 x M8 lock nut.

Raise or tilt pressure washer so you can line up foot with the hole located at the centre of the frame.

Align the rubber foot with the hole in the frame where the foot is to be located. Attach foot by inserting the bolt from the bottom up and install the acorn nut.

Wrench tighten until there is a slight crush on the frame tube - do not over tighten.

2

INSTALL HANDLE

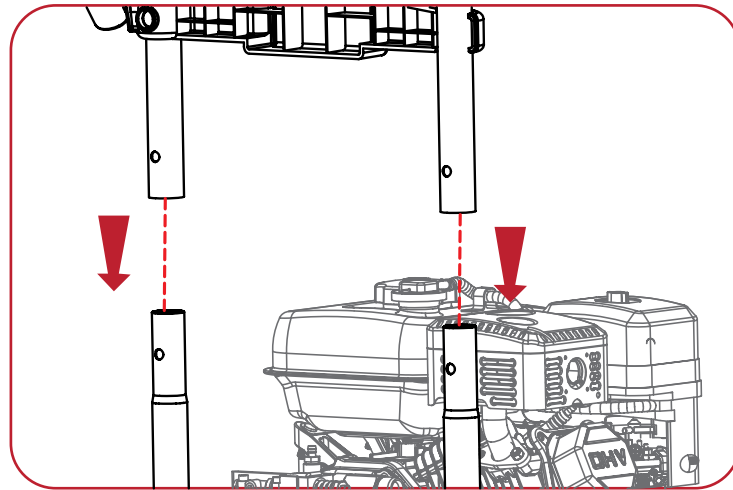

Install the upper frame (handle) onto the lower frame by sliding the handle over the two upright tubes on the lower frame and pressing down firmly until the handle is seated, and the two pins snap in place.

3

ATTACH ACCESSORY HOOK

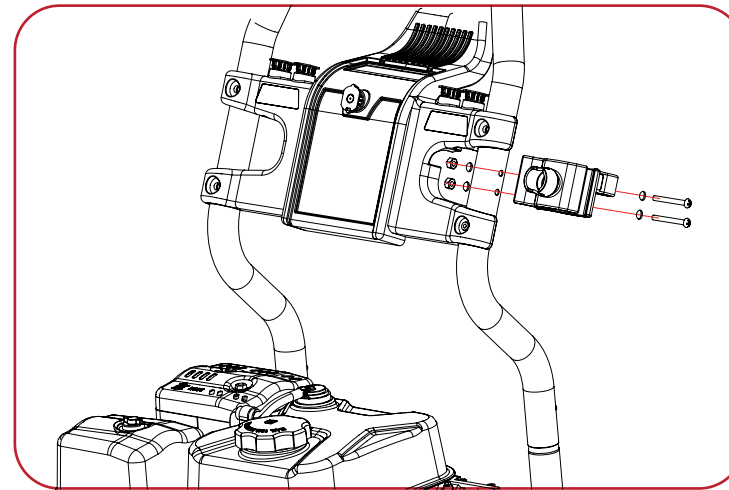

Attach the accessory hook.

Install two plastic rivets until the plastic rivet is snug.

Note: You may need to tap with a mallet or small hammer to seat the lock pin.

4 A

ATTACH SPRAY GUN

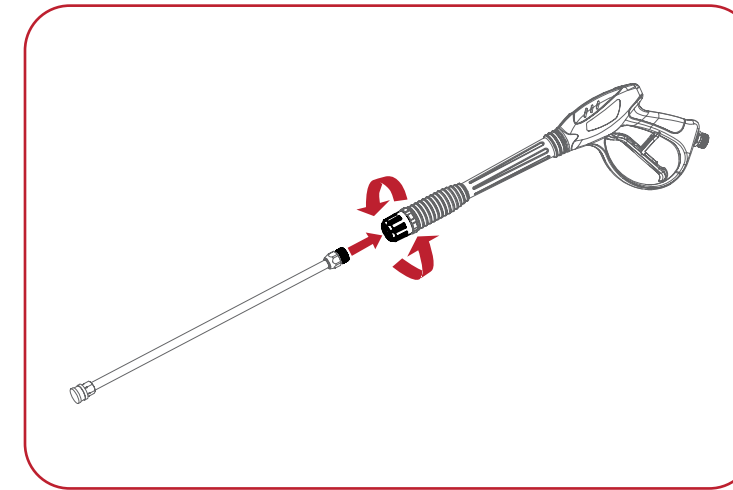

Screw the spray wand and the trigger handle together until they are secure.

4 B

ATTACH THE HOSE

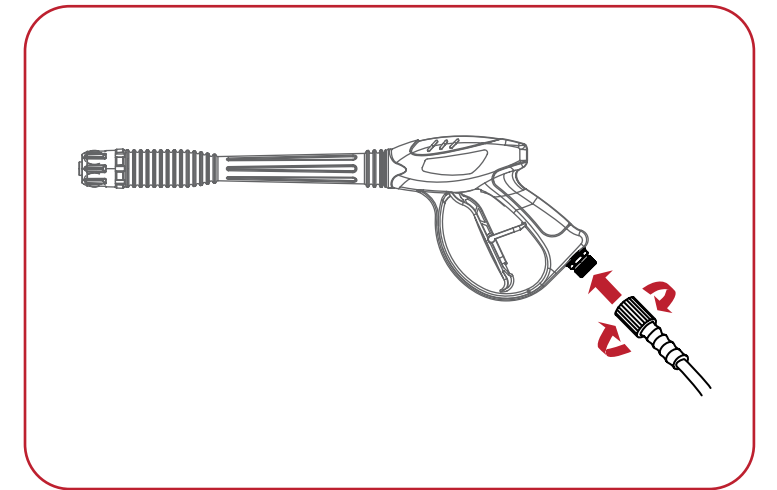

Insert the inlet coupler of the spray hose into the threaded fitting on the high pressure spray gun and thread the black nut on by turning clockwise until it is hand tight.



Be careful not to crossthread the fitting as the threads are extremely fine. Take extra care throughout this step.

5

ADD / CHECK OIL

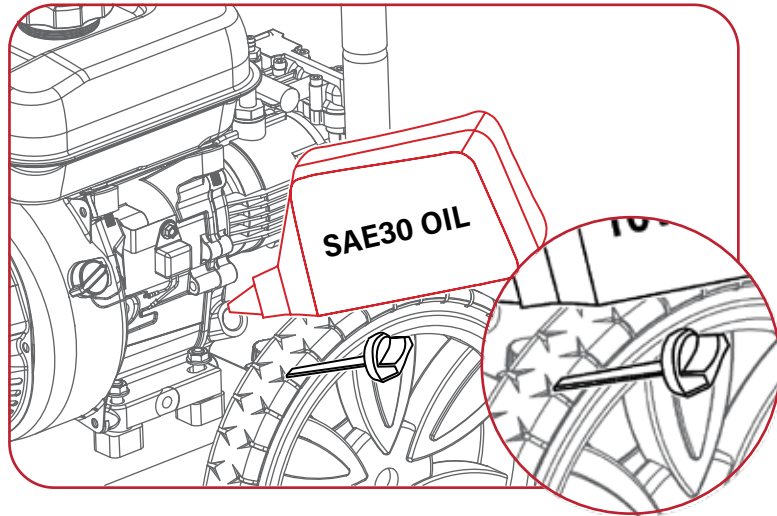

1. Place pressure washer on a level surface.
2. Remove the dipstick to ensure you do not overfill the engine.
3. Carefully add between 520 ml (17.6 oz) of 4-Cycle engine oil (SAE30) to empty reservoir until oil reaches the out edge of the oil fill hole (crankcase dipstick hole)

Be sure to replace both dipsticks before attempting to start the engine.

6

ADD FUEL

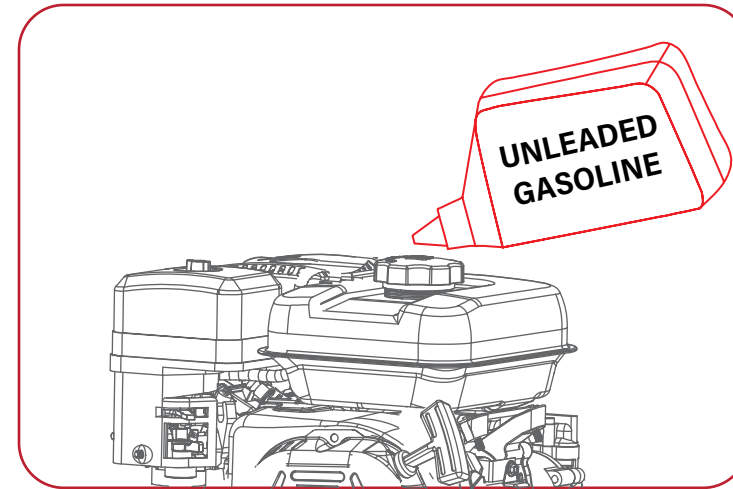

1. Set pressure washer on a clean and level surface in an area that is well ventilated.
2. Remove fuel cap.
3. Insert a funnel into the fuel tank and carefully pour gasoline into the tank until fuel level reaches 1 1/2 inches below the neck.



Oil and fuel must be added to unit prior to first use. To avoid spillage, do not overfill fuel tank as gasoline expands.

7

CONNECT GARDEN HOSE

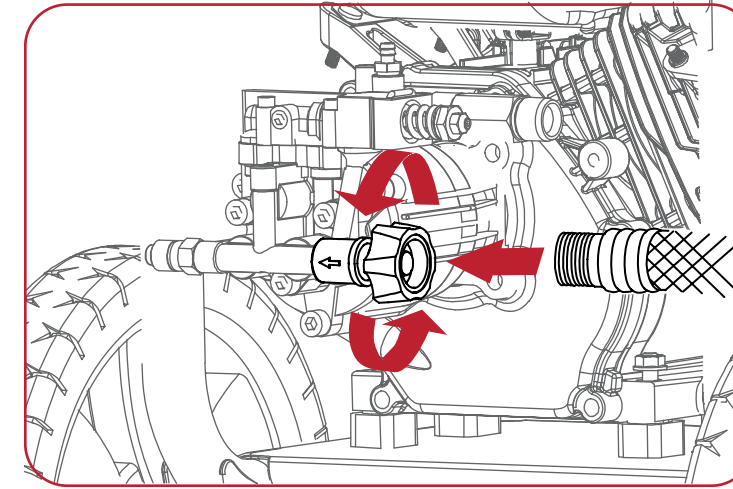

1. Attach the water inlet/hose lock if not already installed
2. Connect hose to water inlet and tighten by hand.

8

CONNECT HIGH PRESSURE HOSE

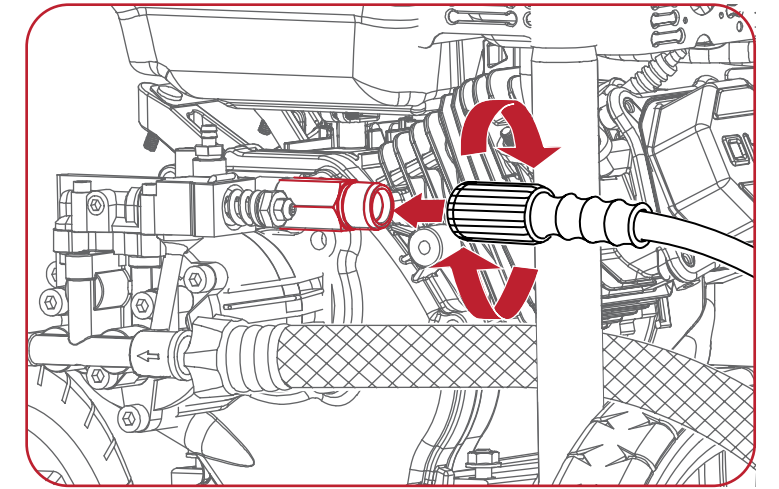

1. Attach end of high pressure hose to the high pressure outlet on pump.
2. Care should be taken to ensure the the threads are not crossed when connecting the hose.



- ✓ Read and understand this operator manual in its entirety before operating pressure washer
- ✓ Check oil level and add oil to the proper level if low
- ✓ Check fuel level and add fuel if needed
- ✓ Check connections of handle and all hoses to make sure they are secure
- ✓ Check all hoses for kinks and damage
- ✓ Check flow of water supply and make sure it is adequate (2.8 - 5.6 bar)



Do not operate indoors or in a confined space preventing dangerous carbon monoxide gas from dissipating.

Carbon monoxide gas is a poisonous, odourless gas that can cause headache, confusion, fatigue, nausea, fainting, sickness, seizures or death. If you start to experience any of these symptoms **IMMEDIATELY** get fresh air and seek medical attention.

Never use indoors, in a covered area, or in a confined space, even if doors and windows open. Keep exhaust from this unit from entering a confined area through windows, doors, vents or other openings. When working in areas where vapours could be inhaled, use a respirator mask according to all of its instructions.

PRE-OPERATION CHECKLIST

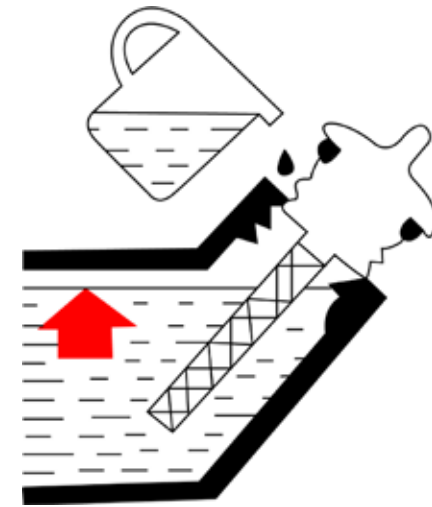

This machine is equipped with a low oil sensor which will prevent the engine from running in the event the oil level is too low.

Your machine is delivered **EMPTY** of all fluids, however trace elements of oil may be present inside your engine. Do not mistake these trace elements of oil for a full oil reservoir.

Please fill the machine with oil as illustrated above. Your oil should be level with the threads on the oil fill hole.

1

TURN FUEL VALVE TO "ON"

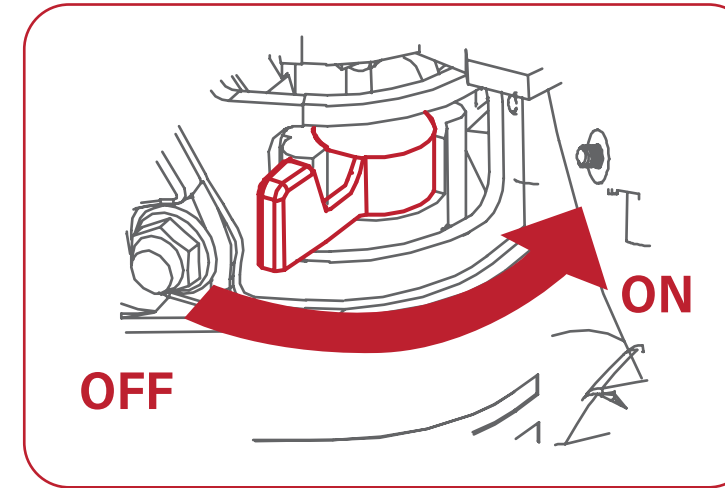

1. Place pressure washer on a level surface.
2. Purge the system's water pump of air by releasing the safety and squeezing the trigger of the spray gun.
3. Turn the fuel on by sliding the fuel valve to the right (ON position)



The fuel valve is the bottom one of the two levers and can be identified by the **FUEL** icon sticker

2

SLIDE CHOKE TO LEVER TO "CHOKE"

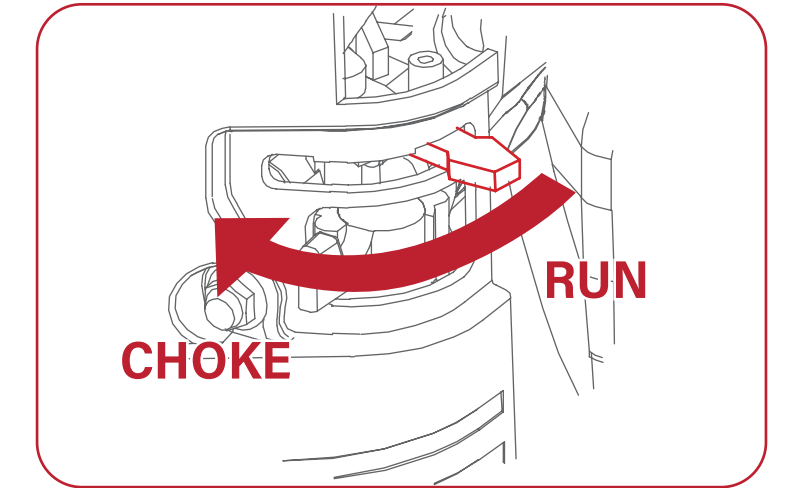

1. Close the choke by sliding the choke lever to the left (OFF position)

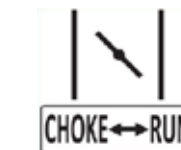

The choke lever is the top one of the two and can be located by the **"CHOKE"** sticker.

3 TURN ENGINE OFF/ON SWITCH TO "ON"

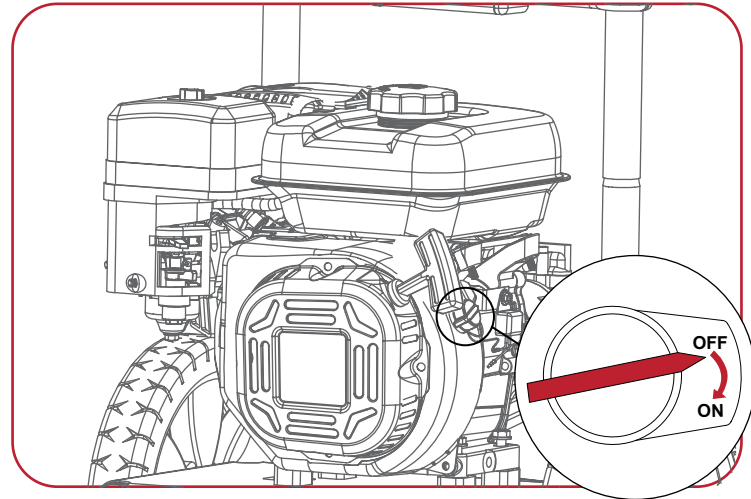

1. Turn the engine OFF/ON switch the "ON" position.

4 PULL RECOIL

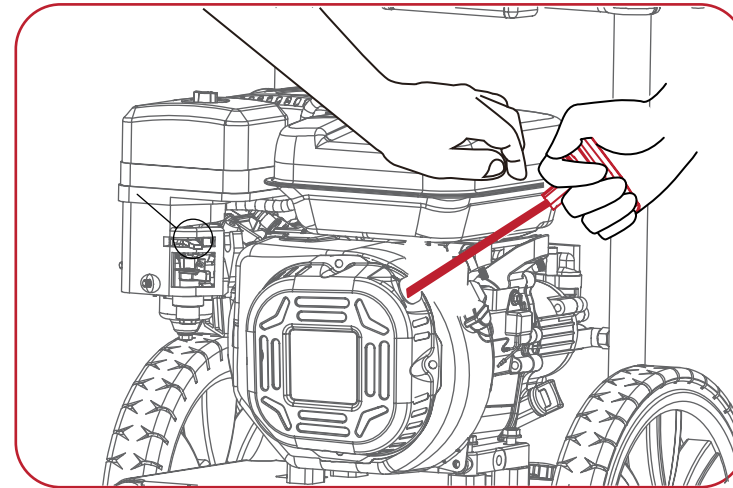

1. Holding the machine with your hand, pull the recoil handle (start cord) slowly until resistance is felt, then pull rapidly
2. Squeeze the gun trigger and release pressure after every failed attempt to start the pressure washer (this will reduce back pressure)



Exhaust gets extremely hot.
Ensure your body and parts of the machine avoid contact with this area.

5 SLIDE CHOKE TO RUN POSITION

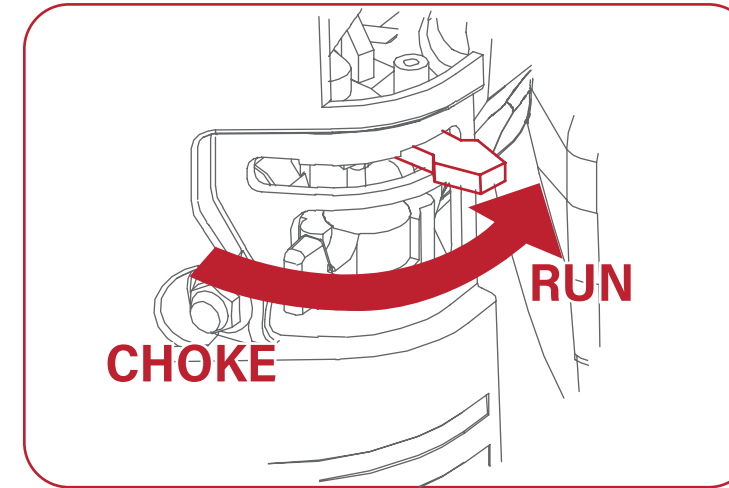

1. Slide choke lever to the right (RUN position)
2. The machine will run normally when the lever is fully moved to the "RUN" position.
3. If the engine cuts out during this step please repeat steps 2, 4 + 5.

6 TURN ON WATER SUPPLY



1. As soon as your pressure washer is running, turn on your water supply immediately.



Using the machine for an extended period of time without water supply will cause premature damage to your high pressure pump.

TURNING OFF THE ENGINE

1

TURN OFF THE ENGINE

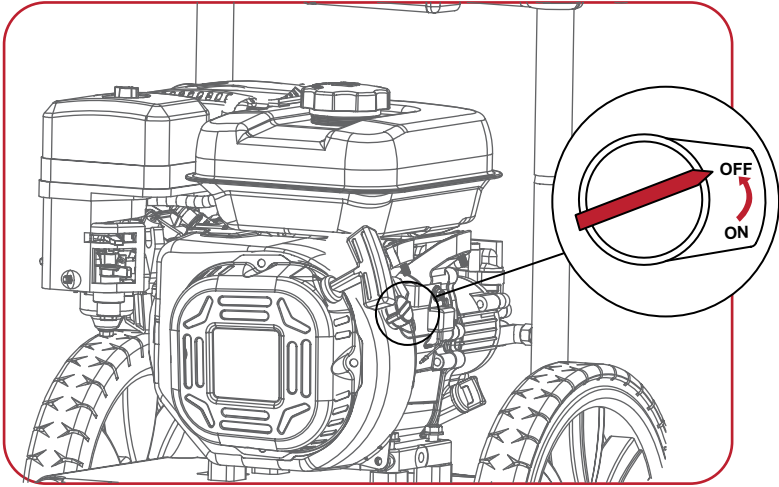

1. Turn the ON/OFF switch to the "OFF" position.
2. The engine should immediately stop.



In the event the engine does not stop when the switch is moved to the "OFF" position, slide the choke lever to the left allowing the engine to flood and stop.

2

TURN FUEL VALVE OFF

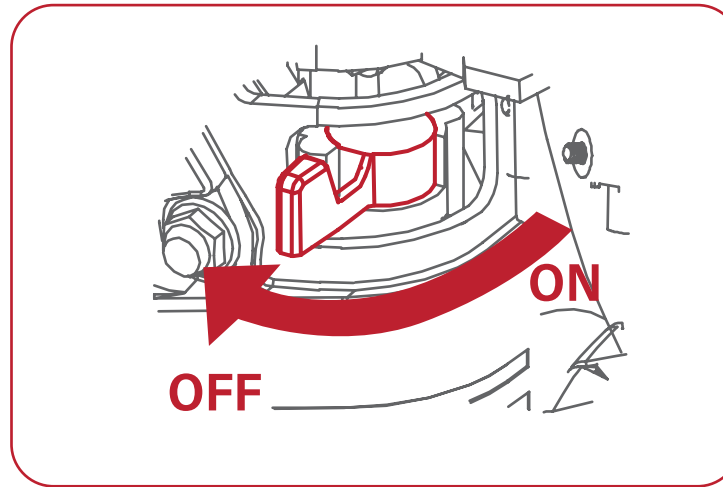

1. Slide the fuel valve to the left (OFF position).

3

TURN OFF WATER SUPPLY

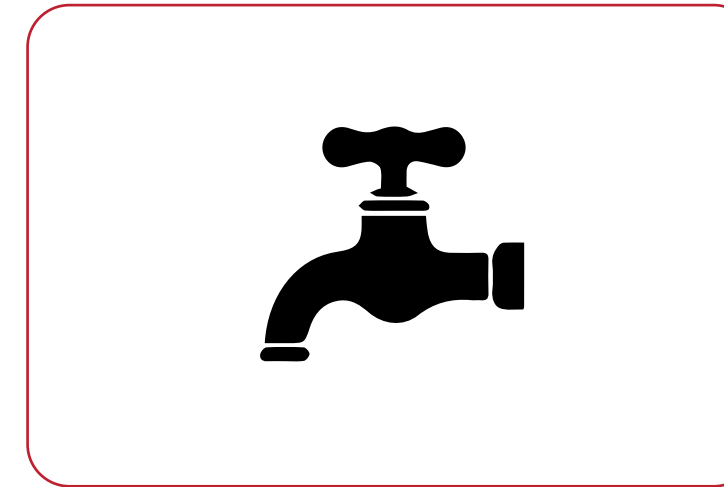

1. Ensure your water supply is turned off to prevent premature engine damage.



It is important to ensure that all water is fully drained from the machine prior to storage. Failure to drain the pump properly could result in damage to your pump. Examples of such damage is water freezing inside the pump and cracking the pump casting.

4

RELEASE WATER PRESSURE

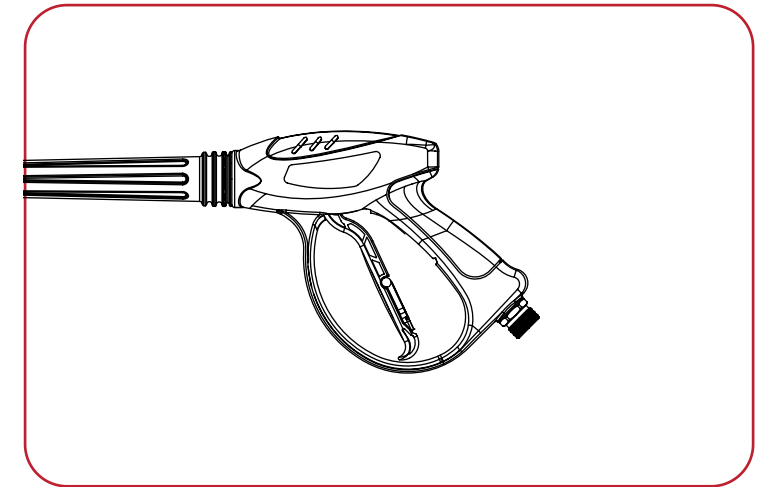

1. Squeeze the trigger handle to release all water pressure

OPERATING THE SPRAY GUN

1

START WATER FLOW

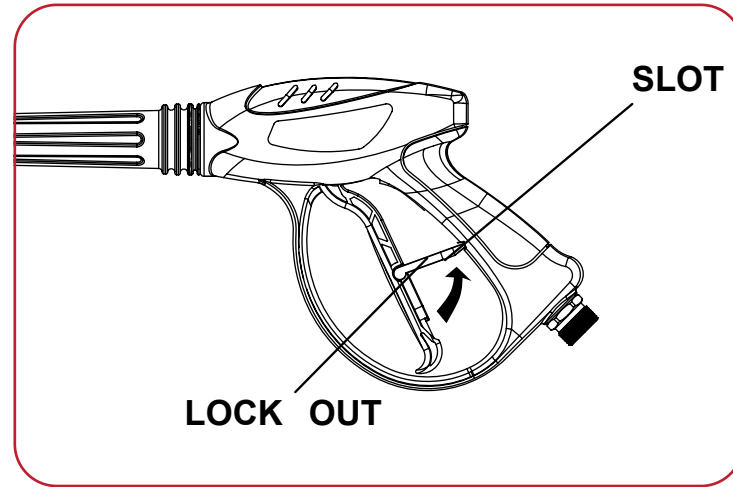

1. Flip the lock tab behind the trigger up or down until it clicks to apply or remove the safety.
2. Pull back on trigger to begin operating pressure washer.



Kickback forces result from pressing the trigger. Therefore, always hold the spray gun with both hands. Pay attention to safe posture. Improper handling can lead to injuries.

2

STOP WATER FLOW

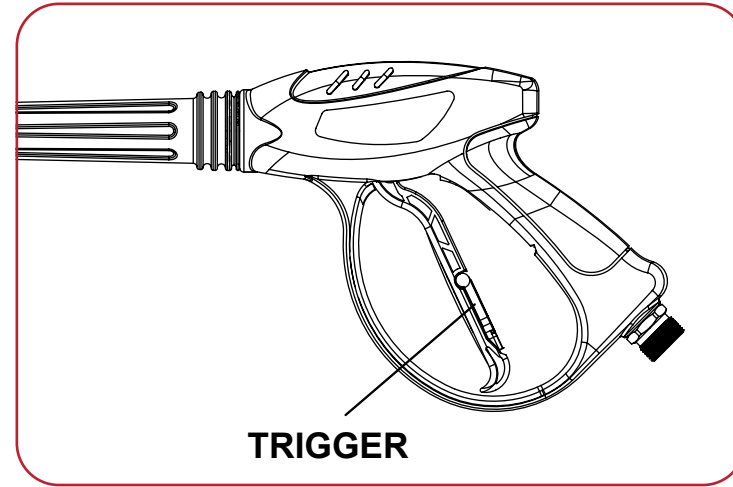

1. Release trigger to stop water flow.

THIS PAGE HAS INTENTIONALLY BEEN LEFT BLANK

1 CHANGING NOZZLES

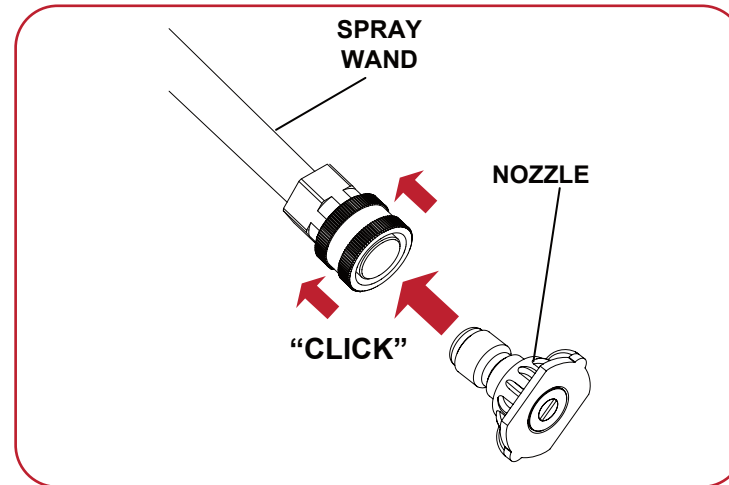

1. To connect or disconnect spray tip, pull back on the quick-connect collar.
2. Insert or remove spray tip then release collar.
3. Release the trigger to stop water flow.

2 USING SPRAY NOZZLE

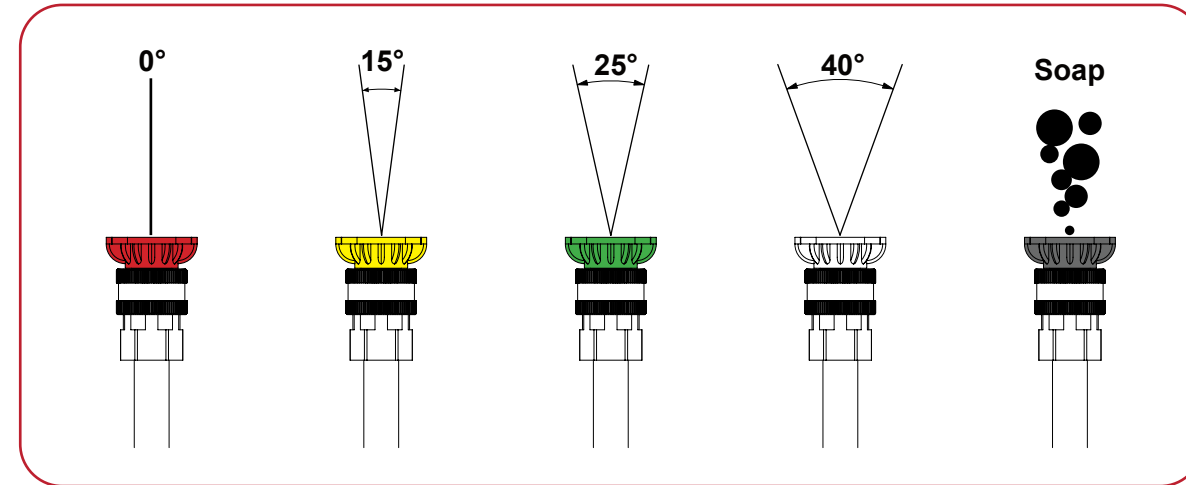

For general cleaning use the 40° spray tip.

For stripping, spot cleaning, blasting, and hard to reach areas use the 15° spray tip. This option is for removing paint, rust mildew, marine growth off boats, or grease stains. This option can be used for reaching second story surfaces, or for the removal of paint, rust, oil stains, tar, gum and other stubborn substances. **Use extreme caution when using this nozzle.**

For applying pressure washer safe detergent, use the black soap nozzle.

The angle of the nozzles shown indicates the spray "fan shape" projected from the nozzle when the trigger of the spray gun is pulled and high pressure water is passing through the nozzle. The pressure and flow will not change significantly due to the various fan patterns.

APPLYING DETERGENT

- Rinse surface with cool water before applying cleaner.
- Prepare detergent as required for job. For best results follow detergent directions as supplied from manufacturer.
- Remove cap from detergent container and fill.
- Spray detergent on surface. For best results use long, even, and overlapping strokes. Allow detergent to set for about 3 minutes before rinsing, but do not allow detergent to dry on surface or it may cause streaking or cause damage to the surface. Use good judgment.
- To clean equipment after use, flush water through the spray nozzle for 1-2 minutes then shut off engine. Soak nozzle in bucket of clean water to remove detergent.



Avoid skin contact with detergents, in particular contact with eyes.

If detergent gets in your eyes flush your eyes with clean water and seek immediate medical attention.



Only use mild, environmentally friendly detergents intended for use in pressure washers. Ask at your specialist dealer about these special products.

Never use aggressive chemicals (e.g. bleach), abrasive detergents or similar to avoid damage to your health, the product and environment.

RINSING WITH THE PRESSURE WASHER

- Test a small area first to avoid surface damage.
- Rinse from top to bottom using long, overlapping strokes.

MOVING THE PRESSURE WASHER

- Turn the pressure washer off.
- Tilt unit towards you until it is balanced on its wheels.
- Roll machine to desired location.

MAINTANENCE

CHECKING THE SPARK PLUG

1. Disconnect the spark plug wire from the spark plug.
2. Before removingthe spark plug, clean the area around its base to prevent debris from entering the engine.
3. Clean carbon deposits off the electrode with a wire brish.
4. Check the electrode gap and slowly adjust to 0.80mm (0.031in) if neccessary.
5. Reinstall spark plug and lighten to torque 22.0 - 26.9 Nm (16-20ft-lb)
6. Reconnect spark plug wire
7. If spark plug is worn replace only with an equivalent replacement part. Spark plug should be replaced anually.



Water pressure produced by this unit can cut through skin and tissue leading to serious injury and possible amputation.

Never attempt to repair high pressure hose, always replace.

Never attempt to repair leaks with sealant, always replace O-ring or seal.

REPAIRING LEAKING CONNECTIONS

Purchase O-rings/seals and replace damaged or worn seals on the pressure washer.

AIR FILTER

A dirty air filter will reduce the life span of the engine, make starting the engine difficult, and reduce the unti's performance. To clean:

1. Remove air filter cover
2. Carefully pull the air filter out by lifting up along the edges.
3. Remove dirt from filter by tapping on it or having it blown out.
4. Reinstall air filter so that it seal and replace air filter cover.

STORING PRESSURE WASHER

If storing pressure washer for 30+ days follow the procedures below:

1. Add fuel stabiliser to gasoline to keep gasoline from going stale and to prevent gum deposits from forming on the carburettor. Run engine for a couple of minutes to circulate the fuel stabiliser.
2. Empty fluid from all hoses and pump.
3. Disconnect the spark plug wire and clean the spark plug. Leave spark plug wire disconnected.
4. Cover & store in a frost free area.

THIS PAGE HAS INTENTIONALLY BEEN LEFT BLANK

Regular maintenance will extend the life of your pressure washer and improve its performance. The warranty does not cover items that result from operator negligence, misuse or abuse. To receive full value from the warranty the operator must maintain the pressure washer as instructed in this manual, including proper storage.



Before inspecting or servicing this machine, make sure the engine is off and no parts are moving. Disconnect the spark plug wire and move it away from the spark plug.

PRE-OPERATION STEPS

Before starting the engine perform the following pre-operation steps:

1. Check the level of the engine oil and the fuel tank level.
2. Make sure the air filter is clean.
3. Remove any debris that has collected on the pressure washer.
4. Check water inlet screen for damage. Clean inlet screen if it is clogged.
5. Check high pressure hose for damage.
6. Briefly run garden hose to flush out any debris or insects.
7. Inspect the work area for hazards.

REMOVE DEBRIS

1. Clean any debris that has collected around or behind the muffler, cleaning systems and controls.
2. Use a damp cloth to wipe exterior surfaces. If dirt is caked on, use a soft bristle brush.

AFTER EACH USE

Follow the following procedure after each use:

1. Shut off engine and turn off water supply, Release water pressure by pointing spray gun in a safe direction and squeezing the trigger.
2. Disconnect high pressure hose, spray gun and nozzle. Drain water from items and use a rag to wipe down the outside of the hose and spray gun.
3. Empty the water from the pump by pulling the recoil starter 6 times.
4. Empty the water from the pump by pulling the recoil starter 6 times.
5. Store unit in a clean and dry area.

CHECKING DETERGENT SIPHONING TUBE

1. Check the detergent siphoning tube for clogs, leaks or tears
2. Make sure the tube fits tightly to the pump fitting
3. Replace siphoning tubes if damaged

CHANGING ENGINE OIL

1. Shut off the engine
2. Clean the area around the oil fill cap/dipstick to keep out debris then remove oil fill cap/dipstick.
3. Place an oil pan on the ground to catch oil. Remove oil plug then tilt pressure washer back and to the side to empty out the oil from the crankcase.
4. Once oil is completely drained, return the pressure washer to a level position and install drain plug. Refill the engine with new oil as instructed earlier in this manual under Adding/Checking oil.

OIL DRAIN PLUG

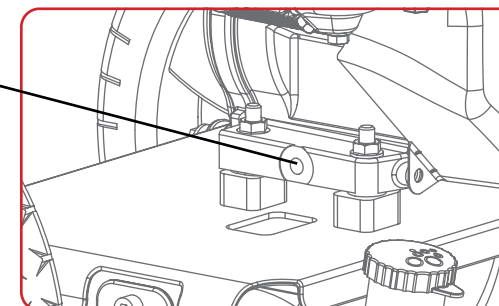

SPRAY GUN

1. Make sure the spray gun is connected securely.
2. Inspect the spray gun safety and make sure the spray gun trigger springs back on release.

HIGH PRESSURE HOSE



Never repair high pressure hose or use unit if hose is damaged. If damaged replace with identical Parker part.

1. Inspect the hose for cuts, bulges or leaks which can develop from kinking or wear. If damage is found immediately replace hose.
2. Inspect couplings for damage. Immediately replace hose if damage is found.

SPRAY NOZZLE

If a pulsing sensation is felt while squeezing the trigger, the spray nozzle may be dirty or clogged and should be cleaned immediately.

1. Shut off engine and turn off water
2. Remove nozzle from the wand
3. Use nozzle cleaner to dislodge anything which is clogging the tip



NOZZLE CLEANER

4. Flush debris out of the nozzle by back flushing with a garden hose for 30-60 seconds
5. Reconnect the nozzle to the spray wand
6. Turn the water supply back on and start engine

TROUBLESHOOTING

PROBLEM	POSSIBLE CAUSE	SOLUTION
Engine will not start	<i>Out of fuel</i>	Fill fuel tank
	<i>Engine oil low</i>	Add engine oil
	<i>Spark plug wire disconnected</i>	Connect spark plug wire
	<i>Bad spark plug</i>	Replace
	<i>Spark plug wire has shorted</i>	Contact ParkerBrand
	<i>Clogged fuel filter</i>	Contact ParkerBrand
Engine hard to start	<i>Stale fuel or water in fuel</i>	Drain fuel and refill with fresh gasoline
	<i>Spark plug producing weak spark</i>	Contact ParkerBrand
	<i>Excessively rich fuel mixture</i>	Contact ParkerBrand
Engine lacks power and vibrates excessively	<i>Dirty air filter</i>	Clean air filter

TROUBLESHOOTING

PROBLEM	POSSIBLE CAUSE	SOLUTION
Engine loses power when load is added	<i>Engine speed is too low</i>	Contact ParkerBrand
Water pressure is weak	<i>Water supply is restricted</i>	Inspect garden hose for kinksor leaks. Make sure you are using a large enough garden hose (min. ¾ inch diameter)
	<i>Water not turned on to full power</i>	Open water source all the way
	<i>Not using high pressure nozzle</i>	Change nozzle
Detergent and spray do not mix	<i>Detergent hose is not submerged or has disconnected</i>	Make sure hose is connected and submerged in the detergent
	<i>Black soap nozzle needed</i>	Install soap nozzle
Engine stops during operation	<i>Out of fuel</i>	Fill fuel tank

TROUBLESHOOTING



PROBLEM	POSSIBLE CAUSE	SOLUTION
Pump fails to produce pressure or pressure is inconsistent	Water supply is restricted	Inspect garden hose for kinks or leaks. Make sure you are using a large enough garden hose (min. ¾ inch diameter)
	Water not turned on full power	Open water source all the way
	Nozzle is clogged	Clean nozzle
	Spray gun leaks	Check spray connection or replace spray gun
	Air in line	Squeeze trigger handle to remove air
	Water supply is over 100°F	Use cool water supply
	Pump is faulty	Contact ParkerBrand

MAINTENANCE SCHEDULE

	Before starting work	After finishing work or daily	Monthly / 20 hours	Every season / 50 hours	6 months / 100 hours	If problem	If damaged	As required
Check engine oil		X						
Check and clean water inlet screen		X						
Check high pressure hose		X						
Check and clean detergent siphoning tube		X						
Check spray gun for leaks		X						
Clean debris		X						
Check engine oil level			X					
Clean air filter				X				
Check muffler and spark arrester				X				
Service or Replace spark plug					X	X		X

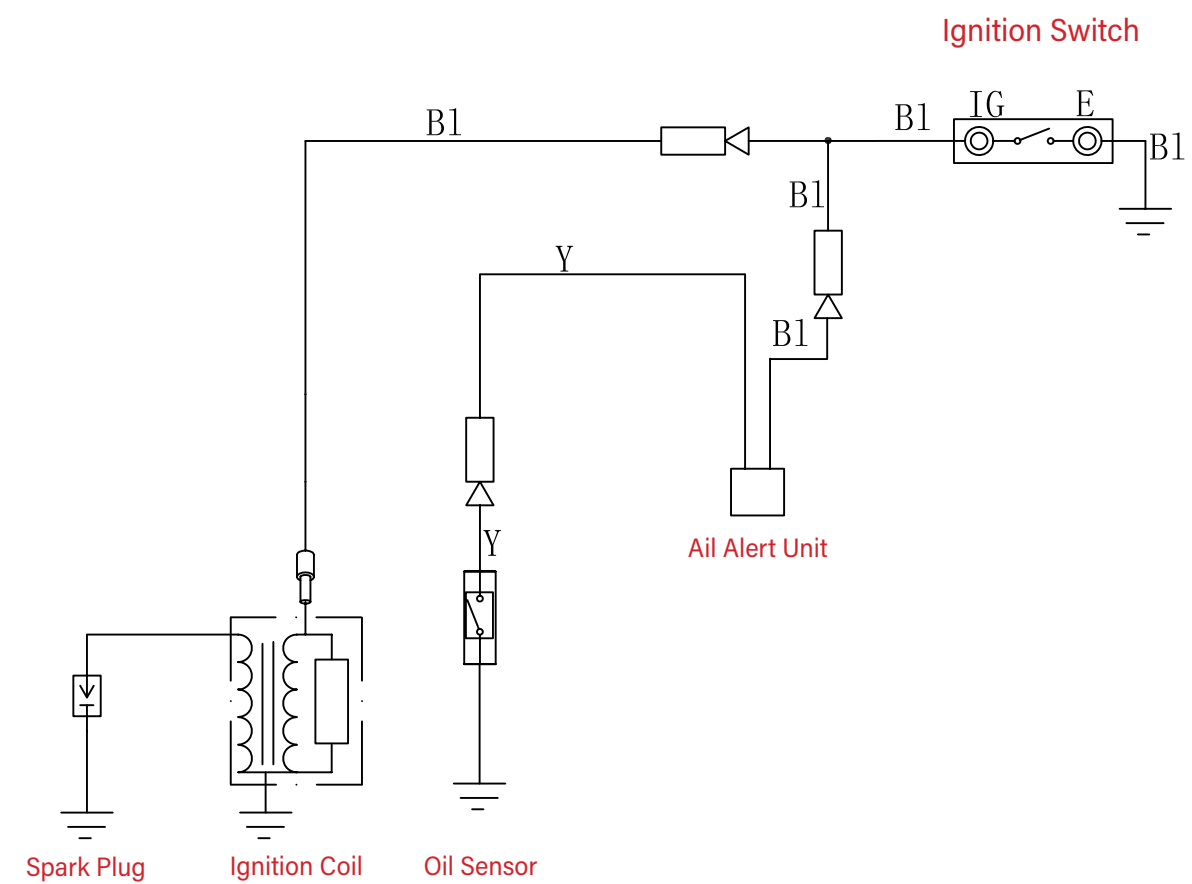
DIAGRAM



	E	IG
OFF		
ON		

B1	Black
Y	Yellow

THIS PAGE HAS INTENTIONALLY BEEN LEFT BLANK

SPECIFICATIONS

Model Number	PPPW-3100
Rated Pressure	21.3 MPa
Allowable Pressure	23.3 MPa
Rated Flow	568 l/h
Max. Flow	568 l/h
Max. Water Intake Temperature	50°C
Max. Inlet Water Pressure	1 MPa
Net Weight	30kg
Water Hose Diamter	Min. ø 12.7mm
Kickback Force on Lance	33 N
Engine	DH212
Displacement	2212cc
Power	4.5kW / 3600 RPM
Fuel Tank Capacity	3.6 L
Oil Type	SAE30
Spark Plug	F7RTC

The emissions control system for this pressure washer is compliant with all standard set by the Enviromental Protection Agency.

This product is designed to remove dirt and mold from house siding, decks, garage floors, brick pations and cement walkways. This unit can be used to clean cars, motorcycles, boats, RV's, outdoor furniture, lawn equipment and grills.

Declared Single-Number Noise Emission Values in accordance with EN ISO 4871:1996	
A Weighted Sound Power Level	105 dB(A)
<i>Values determined according to noise test code given in Annex CC of EN 60335-2-79:2012, using the basic standard EN ISO 3744:2010.</i>	
<i>NOTE: Declared single-number noise emission values are the sum of measured values and the associated uncertainty, and they represent upper boundaries of the range of values which is likely to occur in measurements.</i>	

Delcared Vibration Emission Values of a Single Machine in accordance with EN ISO 12096:1997	
Handle of Trigger Gun	2.584 m/s ²
Middle of Trigger Gun	6.522 m/s ²
Values determined according to vibration test code given in Annex DD of EN 60335-2-79:2012, using the basic standard ISO 5349-1:2001.	

DECLARATION OF CONFORMITY

Description & Function:
Gasoline Pressure Washer - High Press Cleaner

Model/Type:
PPPW-3100

Manufacturing Date/Serial Number:
2017

Conforms to the following Directives:

- ☒ 2006/42/EC Machine Directive (MD)
- ☒ Electromagnetic Compatibility Directive (2014/30/EU)
- ☒ Noise Emission Directive by equipment for use outdoors (2000/14/EC+2005/88/EC)

and to the harmonised standard have been complied with:

- ☒ EN 60335-1:2012
- ☒ EN 60335-1:2012/A11
- ☒ EN 60335-2-79:2012
- ☒ EN 61000-6-1:2007
- ☒ EN 55012:2007+A1

Conformity Assessment Procedure: 2000/14/EC amended by 2005/88/EC - Annex VI

Measured Sound Power Level - LwA: 102dB(A)
Guaranteed Sounds Power Level - LwA: 105dB(A)

Manufacturer's authorised representative within the EC:

Parker Products Ltd.
Richmond Park
Richmond Road
Louth
LN11 0FU

Technical file complied by:
Parker Products Ltd.
Richmond Park
Richmond Road
Louth
LN11 0FU

Being the responsible person appointed by the manufacturer.

Signed:



Date: 01/01/17
Name: Jason Parker
Position: Managing Director
Company: Parker Products Ltd.



PPPW-3100

WWW.PARKERBRAND.CO.UK

April 2022

Rev 1.3