



PETROL LAWNMOWER

PPLM-21196

OWNERS MANUAL

This manual has been produced by Parker Products Ltd. and should be kept with the product and referenced for operation, maintenance and troubleshooting.

This manual contains an overall description of the product, together with all the necessary information for using the product correctly and safely. It is highly recommended that this manual is read prior to any operation or maintenance of this product. The safety precautions and warnings are to ensure your safety and protect you from harm or damage to the product.

All photographs and drawings in this manual are supplied by Parker Products Ltd. to help you with the operation and maintenance of the product. The information contained in this manual was accurate at the time of production, however Parker Products Ltd. may make modifications to the product without notification.

This Petrol Lawn Mower has been designed for lawn areas in private house and hobby gardens.

The machine is to be used only for its prescribed purpose, any other use is deemed to be a case of misuse. The user / operator and not the manufacturer will be liable for any damage or injuries of any kind caused as a result of this.

Please note that our equipment has not been designed for use in commercial, trade or industrial applications. Our warranty will be voided if the machine is used in commercial, trade or industrial businesses or for equivalent purposes.

**Thank you
ParkerBrand**

WHAT'S IN THE BOX	4-5
PRODUCT FEATURES	6-7
SAFETY INFORMATION	8-9
SAFETY INSTRUCTIONS	10-12
ASSEMBLY	14-27
PRE-OPERATION	28-29
ENGINE STARTING PROCEDURE	30-31
FLOODED ENGINE PROCEDURE	32-33
OPERATION	34-36
MAINTENANCE	38-43
STORING YOUR MOWER	44
TRANSPORTING YOUR MOWER	45
TROUBLESHOOTING	46-47
ONLINE RESOURCE LIBRARY	48-49
EXPLODED DIAGRAMS	50-53
SPECIFICATIONS	56
DECLARATION OF CONFORMITY	57

WHAT'S IN THE BOX



WHAT'S IN THE BOX



PRODUCT FEATURES



PRODUCT FEATURES



SAFETY INFORMATION



IMPORTANT

PLEASE READ THESE INSTRUCTIONS FULLY BEFORE ASSEMBLING AND OPERATING

Description Of Symbols.

Symbols are used in this manual to attract your attention to possible risks. The safety symbols and the explications which accompany them must be perfectly understood. The warning themselves do not prevent the risks and cannot be a substitute for proper methods of avoiding accidents.



WARNING- To reduce the risk of injury, user must read instruction manual.



This symbol, before a safety comment, indicates a precaution, a warning or a danger. Ignoring this warning can lead to an accident for yourself or for others. To limit the risk of injury, fire, or electrocution always apply the recommendations indicated..



KEEP BY STANDERS AWAY.

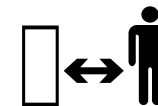

HOT SURFACES WILL BURN FINGERS OR PALMS

SAFETY INFORMATION

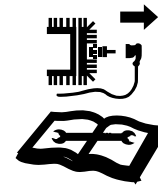

REMOVE SPARK PLUG LEAD BEFORE MAINTENANCE

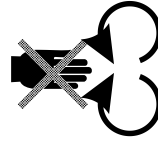

RISK OF INJURY. DO NOT OPEN OR REMOVE SAFETY SHIELDS WHILE ENGINE IS RUNNING.



WEAR EAR PROTECTION & EYE PROTECTION WHEN OPERATING.



BEWARE OF SHARP BLADES



WARNING! EXHAUST GAS CONTAINS TOXIC SUBSTANCES. DO NOT RUN THE ENGINE IN CLOSED OR POORLY VENTILATED AREAS.



NEVER REFUEL WHILE THE ENGINE IS RUNNING



DO NOT TOUCH THE MOVING PARTS OF THE MACHINE UNTIL THEY ARE COMPLETELY STOPPED.

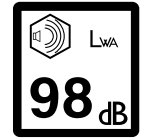

GUARANTEED SOUND POWER LEVEL



CONFORMS TO CURRENT SAFETY STANDARDS



WASTE ELECTRICAL PRODUCTS SHOULD NOT BE DISPOSED OF WITH HOUSEHOLD WASTE. PLEASE RECYCLE WHERE FACILITIES EXIST CHECK YOUR LOCAL AUTHORITY OR RETAILER FOR RECYCLING ADVICE

TRAINING

- Read the instructions carefully. Be familiar with the controls and the proper use of the equipment.
- Never allow children or people unfamiliar with these instructions to use the lawnmower. Local regulations can restrict the age of the operator.
- Never mow while people, especially children, or pets are nearby.
- Keep in mind that the operator or user is responsible for accidents or hazards occurring to other people or their property.

PREPARATION

- While mowing, always wear substantial footwear and long trousers. Do not operate the equipment when barefoot or wearing open sandals.
- Thoroughly inspect the area where the equipment is to be used and remove all objects which can be thrown by the machine e.g. stones, sticks etc.

- Warning - petrol is highly flammable.

Store fuel in containers specifically designed for this purpose;
Refuel outdoors only and do not smoke while refuelling;
Add fuel before starting the engine. Never remove the cap of the fuel tank or add petrol while the engine is running or when the engine is hot;
If petrol is spilled, do not attempt to start the engine but move the machine away from the area of spillage and avoid creating any source of ignition until petrol vapours have dissipated;
Replace all fuel tank and container caps securely;
- Replace faulty silencers.
- Before using, always visually inspect to see that the blades, blade bolts and cutter assembly are not worn or damaged. Replace worn or damaged blades and bolts in sets to preserve balance.

OPERATION

- Do not operate the engine in a confined space where dangerous carbon monoxide fumes can collect.
- Mow only in daylight or in good artificial light.
- Avoid operating the equipment on wet grass, where feasible.
- Always be sure of your footing on slopes.
- Walk, never run.
- For wheeled rotary machines, mow across the face of slopes, never up and down.
- Exercise extreme caution when changing direction on slopes.
- Do not mow excessively steep slopes.
- Do not mow slopes over 15-20 degrees.
- Use extreme caution when reversing or pulling the lawnmower towards you.
- Stop the blade(s) if the lawnmower has to be tilted for transportation when crossing surfaces other than grass, and when transporting the lawnmower to and from the area to be mowed.
- Never operate the lawnmower with defective guards, or without safety devices, for example deflectors and/or grass catchers, in place.
- Do not change the engine governor settings or over speed the engine.
- Disengage all blade and drive clutches before starting the engine.
- Start the engine or switch on the motor carefully according to instructions and with feet well away from the blade(s).
- Do not tilt the lawnmower when starting the engine or switching on the motor, except if the lawnmower has to be tilted for starting. In this case, do not tilt it more than absolutely necessary and lift only the part which is away from the operator.
- Do not start the engine when standing in front of the discharge chute.

SAFETY INSTRUCTIONS.

- Do not put hands or feet near or under rotating parts. Keep clear of the discharge opening at all times.
- Never pick up or carry a lawnmower while the engine is running.
- Stop the engine and disconnect the spark plug wire , make sure that all moving parts have come to a complete stop and, where a key is fitted remove the key:
Before clearing blockages or unclogging chute;
Before checking, cleaning or working on the lawnmower;
After striking a foreign object. Inspect the lawnmower for damage and make repairs before restarting and operating the lawnmower;
If lawnmower starts to vibrate abnormally (check immediately);
- Stop the engine and disconnect the spark plug wire, make sure that all moving parts have come to a complete stop and, where a key is fitted remove the key:
Whenever you leave the lawnmower;
Before refuelling;
- Reduce the throttle setting during engine shut down and, if the engine is provided with a shut-off valve, turn the fuel off at the conclusion of mowing.

- Go slow when using a trailing seat.

MAINTENANCE AND STORAGE

- Keep all nuts, bolts and screws tight to be sure the equipment is in safe working condition.
- Never store the equipment with petrol in the tank inside a building where fumes can reach an open flame or spark.
- Allow the engine to cool before storing in any enclosure.
- To reduce the fire hazard, keep the engine, silencer, battery compartment and petrol storage area free of grass, leaves, or excessive grease.
- Check the grass catcher frequently for wear or deterioration.
- Replace worn or damaged parts for safety.
- If the fuel tank has to be drained, this should be done outdoors.

THIS PAGE HAS INTENTIONALLY BEEN LEFT BLANK

1 LOWER HANDLE ASSEMBLY

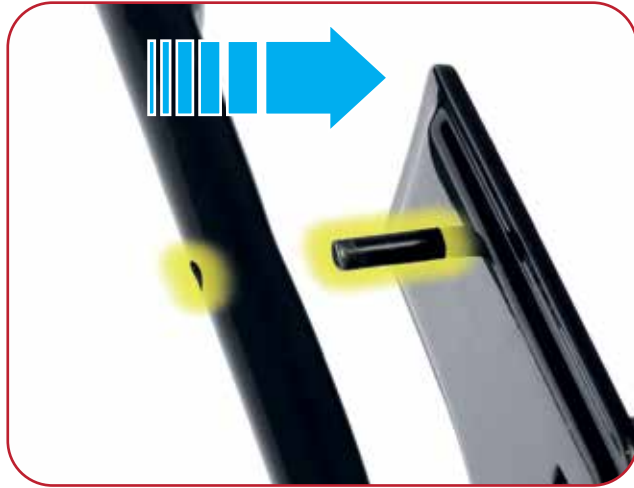

Align the locating pin on the mower frame with the upper hole in the lower handle.

2 LOCATE HANDLE ON TO PIN



Locate the lower handle on to the locating pin on the mower frame. This process will need to be repeated on both sides of the handle.

3 ADJUST HANDLE ANGLE

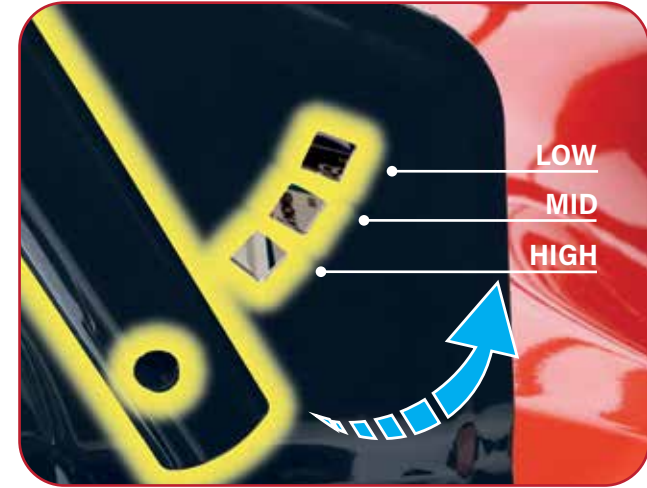

To adjust the handle angle pivot the lower handle on the locating pins. There is a choice of 3 angles to set the handle to, HIGH, MID & LOW. Set at an angle that is most comfortable for the user.



NOTE: The handle angle must be adjusted correctly to suit the user, this will ensure that use of the mower is as comfortable as possible.

4 ALIGN HANDLE WITH FRAME

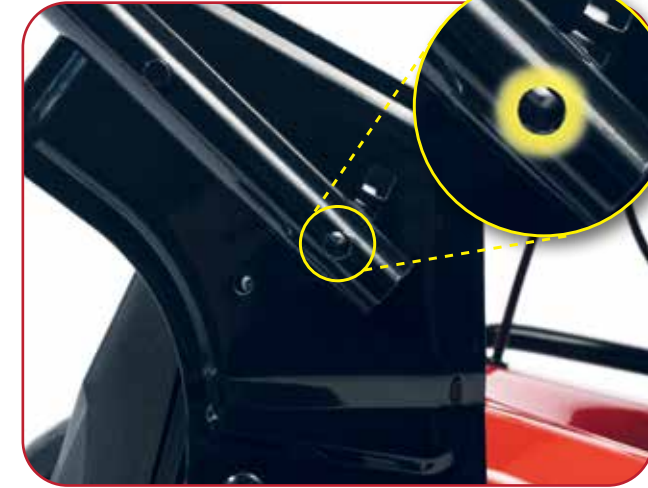

Align the lower round hole located on the lower handle with one of the square holes on the mower frame.

5 THREAD LOCKING KNOB



Thread the bolt through the square hole in the mower frame and through the lower round hole on the lower handle. Slide the washer on to the bolt and up against the lower handle followed by the red locking knob.

6 SECURE LOCKING KNOB



Tighten the red locking knob on to the bolt by turning it in a clockwise direction. Tighten until the lower handle is secured in place. This process will need to be repeated on both sides of the handle.



WARNING: Do Not operate the machine with a loose handle, ensure that the lower handle is fully secured in place before commencing use.

7 ALIGN TOP & BOTTOM HANDLES

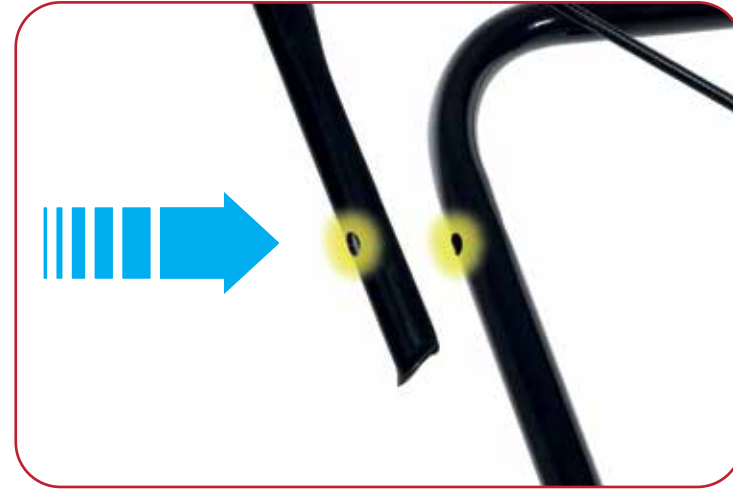

Align the holes in the bottom of the upper handle with the holes located at the top of the lower handle. This process will need to be repeated on both sides of the handle.

8 ASSEMBLE LOCKING KNOB

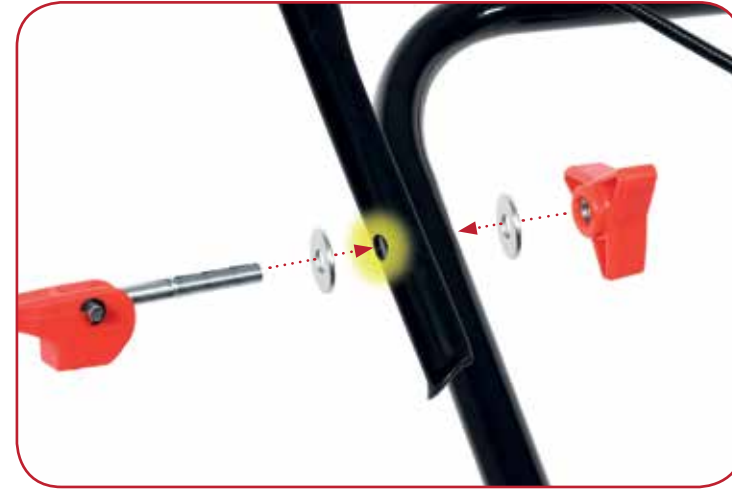

Assemble the locking knob as shown above. Thread the locking lever through both the upper and lower handle and secure in place by tightening the locking knob. This process will need to be repeated on both sides of the handle.

9 TIGHTEN LOCKING KNOB

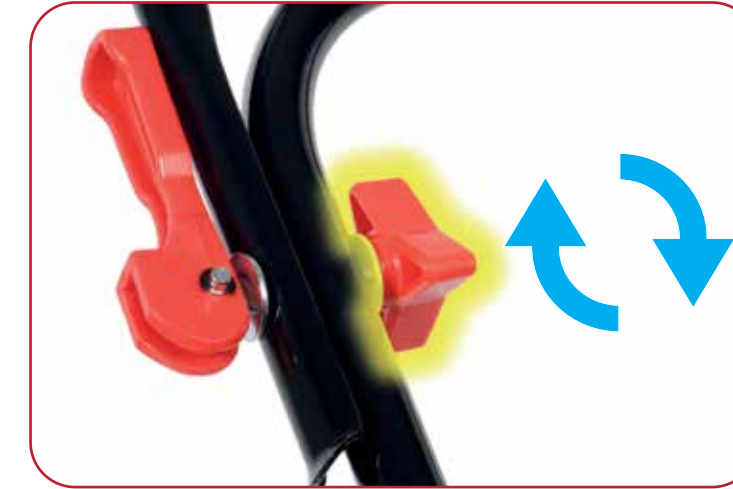

Tighten the locking knob by turning it in a clockwise direction. This process will need to be repeated on both sides of the handle.

10 LOCK LOCKING KNOB



Lock the the assembly in position by pulling the lever into the downward position. This process will need to be repeated on both sides of the handle.



WARNING: Do Not operate the machine with a loose handle, ensure that the upper handle is fully secured in place before commencing use.

11

REMOVE THROTTLE LEVER



Remove the throttle lever from the upper handle.

12

PULL THROTTLE LEVER FREE

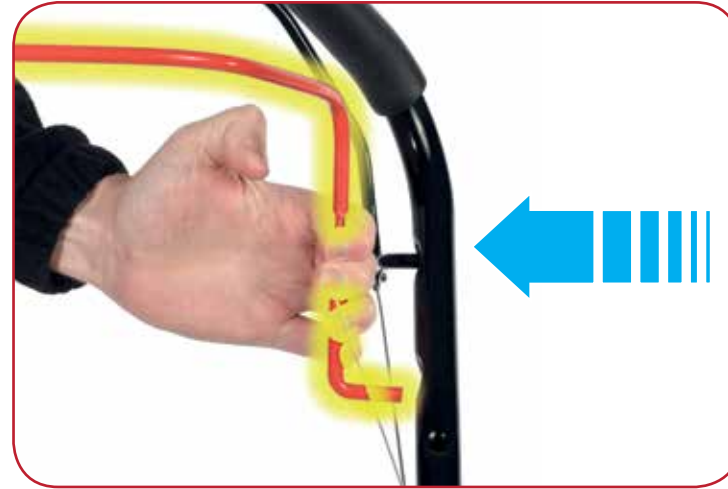

Pull the throttle lever away from the upper handle. The lever will pull free from the upper handle very easily, simply slide it free from the opposite side.

13

DISCONNECT THROTTLE CABLE

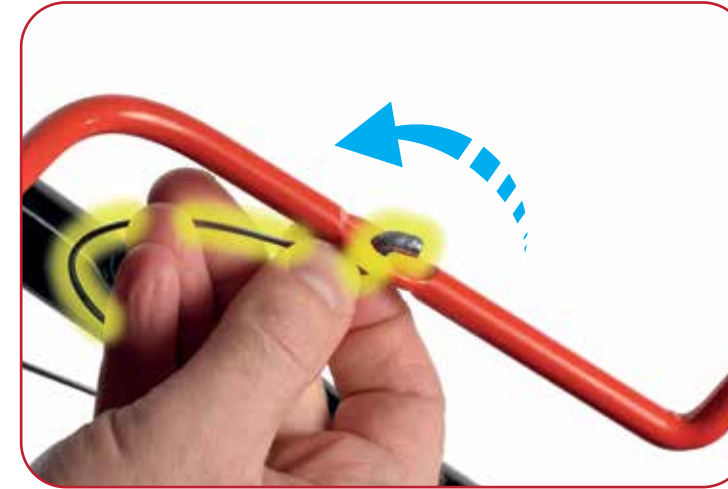

Disconnect the throttle cable by simply sliding the dog leg cable end in a curved motion through the hole on the lever.

14

PULL THROTTLE CABLE FREE



The throttle cable will now pull free from the throttle lever.

15

ATTACH DRINKS HOLDER



There are three location holes situated on the upper handle to attach the drinks holder to, these are illustrated above.

16

POSITION DRINKS HOLDER



To attach the drinks holder to the upper handle correctly position it as shown above.

17

THREAD THROTTLE CABLE



Thread the throttle cable through the cable guide hole located in the top of the drinks holder.

18

FIX DRINKS HOLDER IN PLACE



Carefully place the drinks holder over the throttle adjuster and align with the three holes on the upper handle. Attach utilizing the three screws and wing nuts provided.

19

RE-ATTACH THROTTLE LEVER



The throttle lever can now be reattached to the upper handle on the throttle adjuster side of the machine. Guide the pivot point of the throttle lever into the hole located on the upper handle.

20

INSERT THROTTLE LEVER INTO HANDLE



The image above shows the the pivot point of the throttle lever inserted correctly into the upper handle.

21

RE-THREAD THROTTLE CABLE



Re-thread the throttle cable through the hole on the throttle lever on the side where the cable has been threaded through the drinks holder.

22

SECECURE THROTTLE CABLE

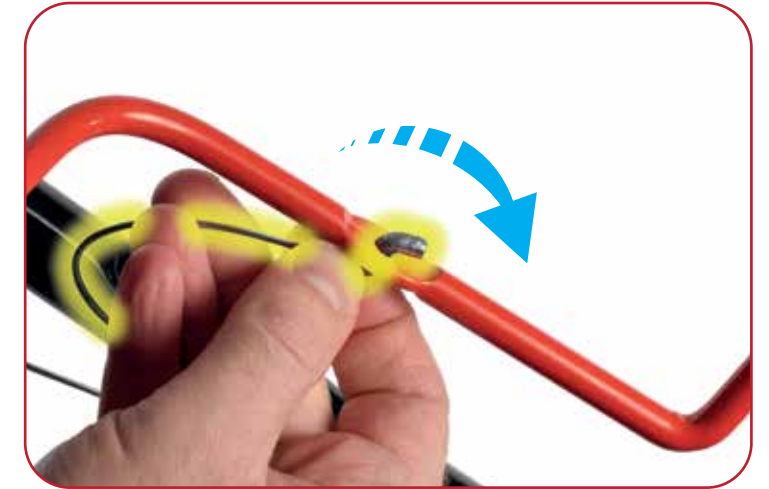

Secure the throttle cable by simply sliding the dog leg cable end in a curved motion through the hole on the lever.

23 RE-ATTACH THROTTLE LEVER

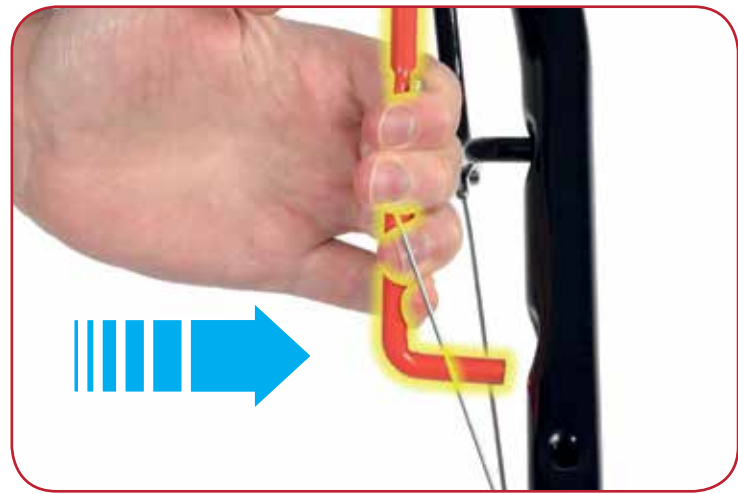

Guide the other pivot point of the throttle lever into the hole located on the upper handle on the cable side of the machine.

24 THROTTLE LEVER SECURED



The throttle lever is now secured in place with the drinks holder and the throttle cable re-attached to the machine.

ACCESSORY SETTINGS

This lawn mower has four functions, these functions can be converted by changing the accessory setting. Please refer to the following chart for setting requirements. The chart indicates which accessory is required for the desired function. A solid black circle indicates when an accessory is needed for the mower to perform the desired function as and when required.

ACCESSORY SETTING			
			
	MULCHING PLUG	GRASS BAG	SIDE DISCHARGE DUCT
FUNCTION	REAR BAGGING	<input checked="" type="radio"/>	<input type="radio"/>
	MULCHING	<input type="radio"/>	<input type="radio"/>
	REAR DISCHARGING	<input type="radio"/>	<input type="radio"/>
	SIDE DISCHARGING	<input type="radio"/>	<input checked="" type="radio"/>

 **NOTE:** When installing an accessory please follow the required steps provided on pages 26 and 27 of this manual carefully.

25 BAG TO MOWER ASSEMBLY



Lift the rear discharge cover with one hand and hook on the grass bag. Release the rear discharge cover to secure the grass bag in position.

26 MULCHING PLUG ASSEMBLY



Remove the grass bag. Push the plastic mulching plug into the rear discharge chute until it is locked in place. Release the flap, it will close back to cover the mulching plug.

27 A LOCATE DISCHARGE COVER



Locate the side discharge cover on the side of the metal deck of the machine.

27 B UNLOCK DISCHARGE COVER



Unlock the side discharge cover by moving the locking mechanism in an upward direction.

27 C ATTACH DISCHARGE CHUTE



Lift the side discharge cover with one hand and hook the side discharge duct on to the spaces on the hinge. Then release the side discharge cover to secure the duct in position.



NOTE: When using the side discharge function, remove grass bag and plug the mulching plug into place.

PRE-OPERATION

CAUTION! THE FOLLOWING PROCEDURES AND ADJUSTMENTS MUST BE PERFORMED BEFORE THE ENGINE IS STARTED.

DO NOT ATTEMPT TO MAKE ANY OF THESE ADJUSTMENTS WHILE THE ENGINE IS RUNNING.

CAUTION! To prevent engine damage the engine is shipped without oil or petrol. The engine must be filled with the correct grade of oil and petrol before starting the engine.

NOTE! Running the engine with a low oil level will cause engine damage. It is recommend that high detergent, premium quality 4-stroke engine oil is used. Using non-detergent oil can shorten the engine's service life and using 2-stroke oil will damage the engine.

CAUTION! Always use high quality detergent oil classified SAE30 oil (or equivalent e. g SAE 10W/30, often termed as 4 Stroke lawn mower oil). Never use additives with recommended oil. To prolong the life of your engine it is important that the oil is changed after the first 5 hours of use.

NOTE! To Check the engine oil level ,stop engine and place the mower on a level surface.

CAUTION! Always use clean, fresh unleaded petrol. Purchase fuel in quantities that can be used within 30 days. Never mix oil with petrol.

CAUTION! Do not fill into the base of neck to allow for fuel expansion. Do not overfill the fuel tank.

CAUTION! WARNING! Petrol is highly flammable and extreme precaution must be taken when handling or working with it. Keep out of reach of children.

WARNING! Refuel in a well-ventilated area with the engine stopped. Do not smoke or allow flame or sparks in the area where the engine is refuelled or where petrol is stored. Avoid repeated or prolonged contact with skin or inhalation of vapour



NOTE: To start the engine, make sure that the HT lead is located on the spark plug and the machine is filled with sufficient oil and petrol.

PRE-OPERATION

1

CHECK OIL

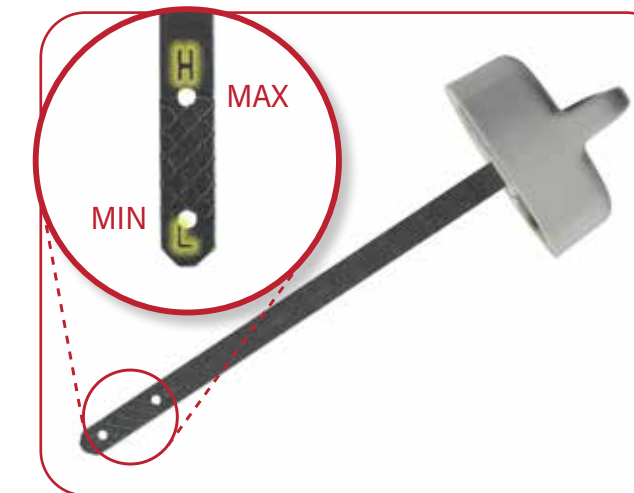

Remove the oil filler dipstick and wipe oil from it with a clean cloth, Insert the dipstick into the oil filler neck, but do not tighten.

Remove dipstick and check the oil Level, the oil level must be between the Min and Max marks on the dipstick.

The engine will not start without sufficient oil. If near the lower level, fill to upper level with the recommended oil (SAE30 or equivalent).



NOTE: Please be aware there maybe trace elements of oil on the dipstick from factory testing and calibration.

NOTE: Clean around filler caps before removing. Clean any overflow or splashes of petrol/oil before starting.

2

CHECK FUEL



Remove the cap, check the fuel level. Refill the tank if the fuel level is low. Pour fuel carefully to avoid overfilling or spilling fuel.

There should be no fuel in the filler neck. Tighten the filler cap finger tight.

ENGINE STARTING PROCEDURE

1 SET DECK HEIGHT

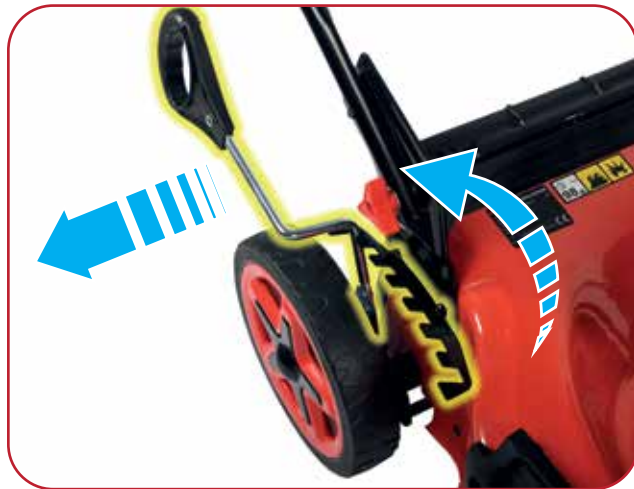

Before attempting to start the engine set the deck height to the highest setting. This will prevent the blade from catching on any uneven ground and make the machine much easier to start.

2 PRIMING THE ENGINE

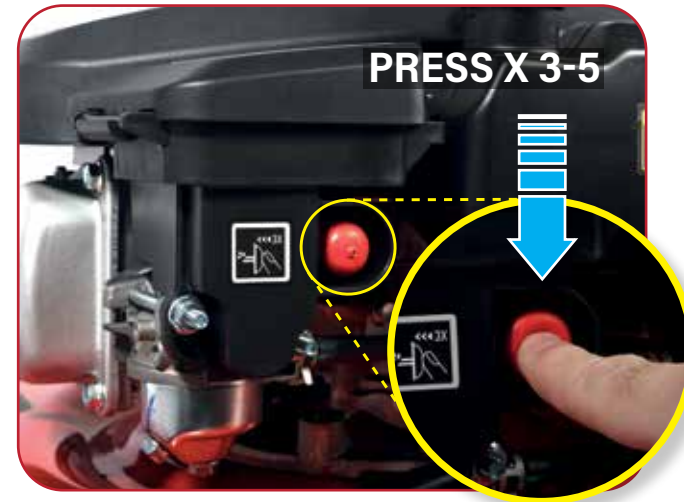

When starting a cold engine, press down the Primer fully 3-5 times.

3 SETTING THE THROTTLE



Put the throttle control lever in the START position before starting



WARNING! Using the primer too many times may cause the engine to flood. When starting a warm engine, the primer does not need to be used. If the engine stops due to a lack of petrol, refill and press down the primer 3-5 times.

ENGINE STARTING PROCEDURE

4 START/STOP LEVER



Stand behind the mower, pull the engine Start/Stop lever toward the upper handle. Place your other hand on the starter handle, pull the starter handle out approx. 10-15cm until you feel a resistance and then start the Engine with a sharp pull.

5 SECURING THE STARTER ROPE

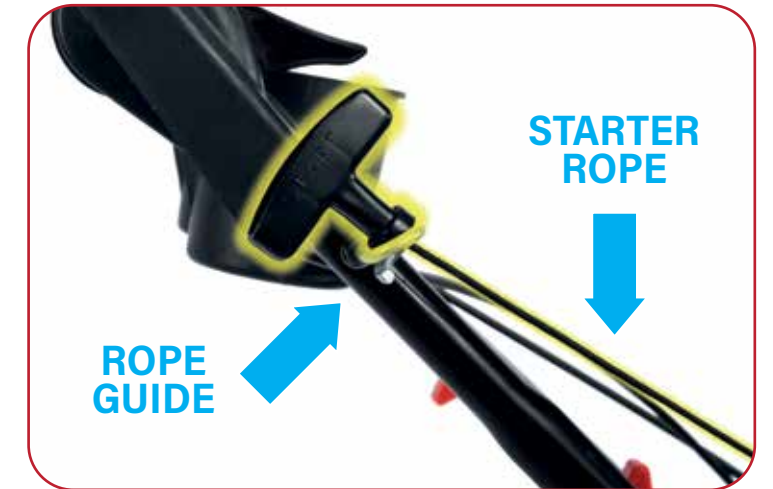

Once the engine is running, put the starter rope into the rope guide



NOTE: If the engine fails to start after three pulls, repeat the process.

NOTE: If the engine won't start after you have operated the starter several times, the engine may be flooded with excess fuel.

FLOODED ENGINE PROCEEDURE

1 START/STOP LEVER



If the engine won't start after you have operated the starter several times, the engine may be flooded with excess fuel.

To unflood the engine first release the engine start/stop lever to stop engine.

2 DISCONNECT COIL PACK



Locate and disconnect the coil pack from the sparkplug. This can be found at the front of the machine next to the exhaust.

3 LOCATE THE SPARKPLUG



The sparkplug is easily accessible with the coil pack removed.

4 REMOVE & DRY SPARKPLUG



Remove the sparkplug using the sparkplug wrench provided. Dry the spark plug and then reinstall it. Follow the starting procedure again carefully



NOTE: Install the spark plug carefully by hand, to avoid cross-threading. After the plug is seated tighten 1/8 to 1/4 turn with a spark plug wrench to compress the washer.

1 STOPPING THE ENGINE



Release the engine start/stop lever, it will return to its Initial position and the engine will automatically switch off.

2 SELF PROPELLED FUNCTION



This unit equipped with self-propelled system. If you press the drive lever (clutch lever), the lawnmower will start to move with the engine running. To stop, simply release the drive lever..

3 CUTTING HEIGHT ADJUSTMENT



The cutting height is adjusted with the cutting height adjusting handle. Pull the handle out and select the desired cutting height. When released the handle snaps into position.

From position 1 to position 7. The cutting height ranges from 25mm to 75 mm

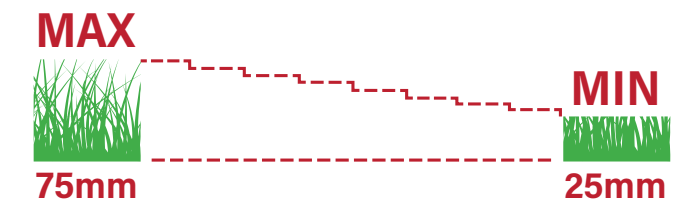

WARNING: Only utilise the cutting height adjustment handle when engine is switched off and the machine is stationary.

MOWING

Select your required setting.
Start the engine and allow it run, and set it to required speed.
Keep a firm grip on the upper handle with engine stop/start lever and drive lever(clutch lever) closed and walk along with it self-propelling to start mowing.

WORKING ADVICES

- Walk, never run with the mower, be very careful when mowing uneven or rough ground.
- Mow across slopes, never up and down.
- Be careful when changing the direction of the mower on a slope.
- Do not mow excessively steep slopes, this includes slopes over 15-20 degrees.
- The best result will be achieved if the grass is dry. Wet grass will tend to clog the blade and the grass collection system.
- Never use the lowest cutting height for the first cut of the season or in drought conditions.
- Only about one thirds of the grass height should be cut.
- When mulching, to ensure that the cut grass can be scattered efficiently, do not cut high or wet grass. When you have been cutting for several minutes, please stop the mower, and clean the blade and the deck.
- Do not remove grass debris in the mower casing or on the blade by hand or with your feet. Instead use suitable tools such as a brush or broom.



WARNING Always observe the strictest safety procedures when using the lawnmower. Carefully read the safety instructions of this manual before proceeding with use.

WARNING! Never open the ejector flap when the grass bag has been detached (to be emptied) and the engine is still running. The rotating blade can cause serious injuries!

THIS PAGE HAS INTENTIONALLY BEEN LEFT BLANK

CLEANING

GENERAL CLEANING

- The lawn mower should be cleaned thoroughly every time after it has been used.
- Do not allow grass cuttings and other debris to become dry and hard on any of the mower surfaces.
- Dried grass remnants and dirt may impair the mowing operation.
- Check that the grass chute is free of any residual grass. Remove any such residue.
- Check the underside of the lawn mower and the blade mount. for this purpose, tilt the Lawn mower onto its left side (opposite the oil filler neck)



WARNING! Before performing any maintenance or cleaning work, switch off the engine and wait until the blade has stopped.

NOTE: Before placing the lawn mower on its side, fully drain the fuel tank using a petrol extraction pump.

NOTE: Do not tilt the lawn mower by more than 90 degrees.

MAINTENANCE SCHEDULE

Performing routine maintenance correctly on your lawnmower will ensure you get years of trouble free use. Please keep this manual safe for future reference. It is recommended that the following maintenance schedule is adhered to. This will ensure the lawn-mower is operated correctly and is safe to use.

	12HOURS OF USE	24HOURS OF USE	36HOURS OF USE
AIR FILTER	CLEAN	CLEAN	REPLACE
SPARK PLUG	CHECK	CLEAN	REPLACE
ENGINE OIL	CHECK	REPLACE	CHECK
ENGINE OIL TO BE CHANGED AFTER 8 HRS			



WARNING! Improper repairs can result in the product functioning unsafely. This can endanger yourself and others!

NOTE: Faults which cannot be rectified please contact ParkerBrand Customer Service on help@parkerbrand.co.uk

CAUTION! Please be aware that any improper repairs will invalidate the warranty and additional costs may be incurred.

CAUTION! Use only genuine spare parts. The use of non genuine spare parts will void your machines warranty!

CHANGING THE ENGINE OIL

- Remove the dipstick, tilt the lawnmower towards the oil filler, have a container ready to catch the oil.
- Once the oil has been emptied replace the dipstick and wipe clean any spillages.
- Refill with 400ml SAE30 oil or equivalent i. e SAE5W/30, SAE10W/30.
- When the dipstick is rested on the filler pipe (i. e. not tightened), the oil level must be between the Min and Max marks on the dipstick.
- Start the engine and allow it to run briefly.
- Stop the engine, wait one minute and check the oil level. top up if necessary.

CAUTION! The engine must be filled with the correct grade of oil and petrol before starting the engine.

NOTE! Running the engine with a low oil level will cause engine damage. It is recommend that high detergent, premium quality 4-stroke engine oil is used. Using non-detergent oil can shorten the engine's service life and using 2-stroke oil will damage the engine.

CAUTION! Always use high quality detergent oil classified SAE30 oil (or equivalent e. g SAE 10W/30, often termed as 4 Stroke lawn mower oil). Never use additives with recommended oil. To prolong the life of your engine it is important that the oil is changed after the first 5 hours of use.

NOTE! To Check the engine oil level ,stop engine and place the mower on a level surface.

NOTE: Do not overfill. Wipe away any spilt oil.

1

LOCATE AND REMOVE DIPSTICK



Locate the oil level dipstick, this will need to be removed to drain oil from the engine.

2

LOCATE HEIGHT ADJUSTMENT LINK BAR



On the opposite side of the machine you will find the height adjustment link bar. Tilt the mower on it's side using the height adjustment link bar as a lifting point.



WARNING! Never change the engine oil whilst the engine is running. This is not only dangerous it will damage the engine beyond repair.

CAUTION: Running the engine without sufficient levels of oil will damage the engine. Use High quality SAE30.

CAUTION: Always clean the mower deck and surrounding areas of any spillages of oil after the oil change proceedure.

NOTE: Always dispose of oil responsibly. Contact your local authority to find a service to help you get rid of hazardous waste.

1

TIP MACHINE ON ITS SIDE



Have a suitable container ready to catch any oil drained from the machine. Carefully tip the machine fully on its side, making sure you follow the correct lifting procedure to prevent injury.

2

DRAIN OIL INTO CONTAINER



Allow the oil to drain from the engine and out of the oil filler neck into a suitable container. Always thoroughly clean the mower deck and any oil spillages before using the mower again.

THIS PAGE HAS INTENTIONALLY BEEN LEFT BLANK



NOTE: Alternatively you can acquire an Oil Extractor/Oil Change Pump to aid in changing the oil. This would circumvent the need to lift the machine and prevent any unnecessary oil spillages.

SPARK PLUG MAINTENANCE

- Once the engine has cooled, twist off the spark plug cover/coil pack lead.
- Carefully Remove the spark plug using a spark plug wrench supplied.
- Clean the spark plug with a wire brush (not supplied) to remove any deposits.
- Using a feeler gauge set the gap to the correct measurement of 0.75mm.
- Install the spark plug carefully by hand being careful not to cross the threads.
- After the spark plug is seated correctly, tighten with the wrench supplied.



WARNING! Never touch the coil pack/sparkplug when the machine is running as there is a risk of electric shock.

AIR FILTER MAINTENANCE

- Remove the air cleaner cover by turning it in an anti-clockwise direction (X).
- Separate the Air Filter element (Y) from the Air Filter Housing (Z).
- Clean the air filter element with warm water and mild soap.
- Allow the air filter element to dry thoroughly before re-installation
- Re-assemble the air filter assembly as shown in the illustration.
- When the air filter is fully re-assembled the machine can be used once again.

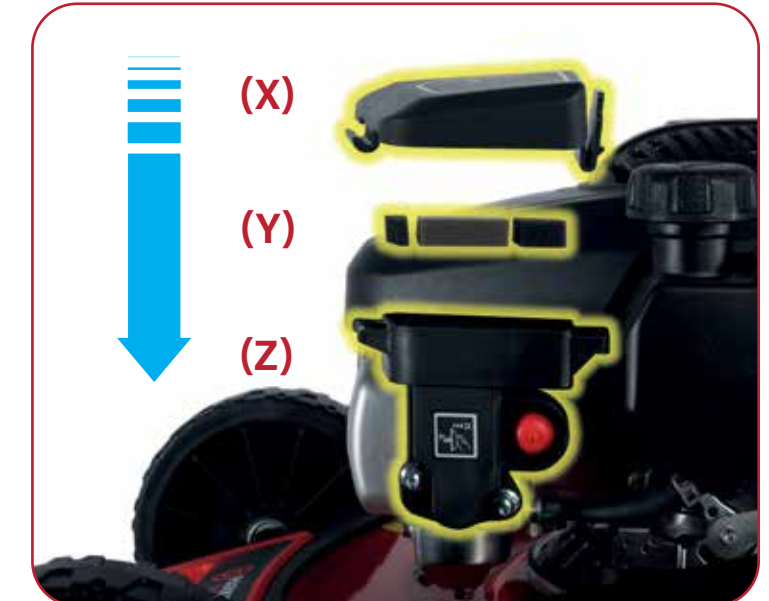

WARNING! Never run the machine without the air filter element installed as this can damage the engine beyond repair.

BLADE REPLACEMENT

FOR SAFETY REASONS YOU SHOULD ONLY EVER HAVE YOUR BLADE SHARPENED , BALANCED AND MOUNTED BY AN AUTHORISED SERVICE WORKSHOP. FOR OPTIMUM RESULTS IT IS RECOMMENDED THAT THE BLADE SHOULD BE INSPECTED ONCE A YEAR.

WARNING! You will need garden gloves (not provided) and a spanner wrench (not provided) to remove the blade.

WARNING! Always handle the blade with care, sharp edges could cause injury

USE GLOVES. Renew your metal blade after 50Hrs mowing or 2yrs whichever is sooner regardless of condition.

WARNING! If the blade is cracked or damaged replace it with a new one.

WARNING! Don't hold the blade by hand directly.

NOTE! Maintain the sharpness of the blade when cutting grass. If the blade has worn excessively and become pitted and blunt, it should be replaced or sharpened. The sharpness of the blade will affect the performance of the lawnmower.



NOTE: For safety reasons we recommend that the blade only be changed by someone qualified and authorized to do so

BLADE REMOVAL/FITTING GUIDE

- Firmly secure the blade and unscrew the bolt using a spanner wrench.
- Remove the metal and plastic washers.
- Remove the blade from the blade adapter.
- Fit a new blade or re-sharpen the blade.
- Locate the new/sharpened blade on to the two studs of the blade adapter
- The up turn of the blade must project into the motor compartment.
- Replace both of the washers and bolt.
- Make sure the blade is located correctly then firmly tighten the bolt.
- DO NOT over tighten.

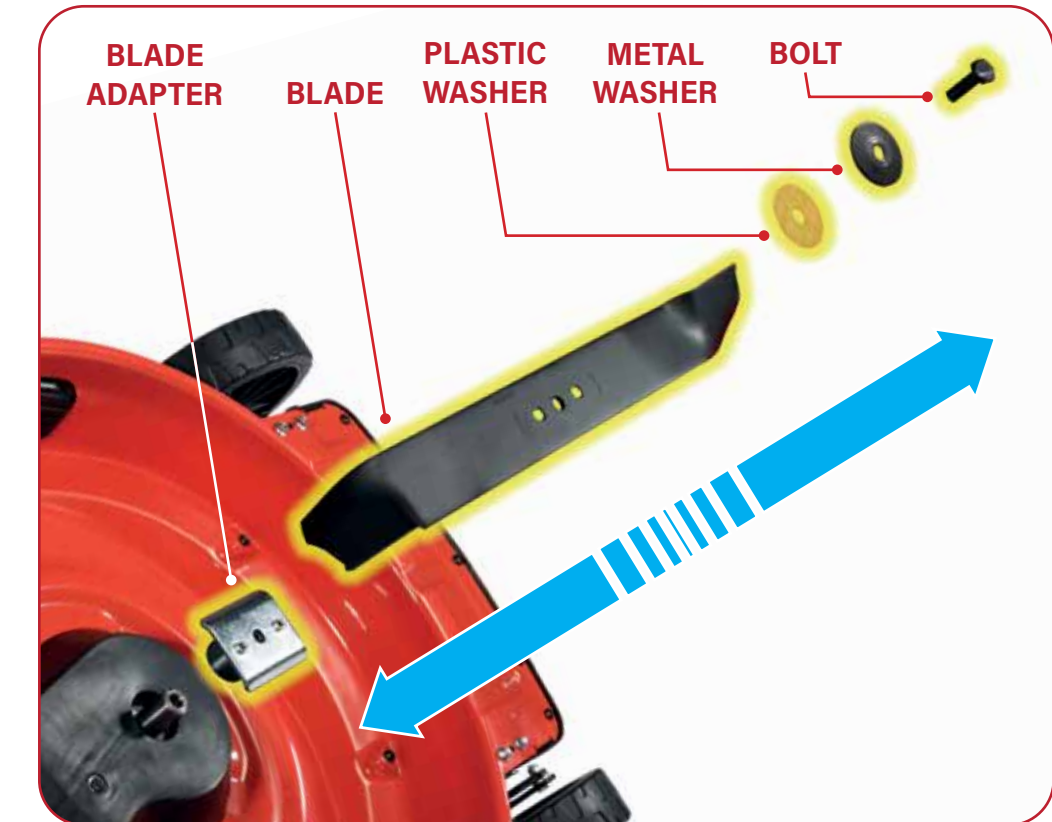

WARNING: Do Not handle the blade with bare hands, to help prevent injury always wear safety gloves when maintaining the blade.

STORING THE LAWNMOWER FOR SHORT PERIODS

The lawnmower can be stored for short periods of time (less than 15 days) without performing any storage maintenance. Before placing the lawnmower into storage always carry out the following:

- Allow the engine to fully cool.
- Ensure the grass bag is empty.
- Clean all debris from under the mower deck.
- Store the lawnmower on flat and level surface with the mower upright.
- Store in a safe place which is not accessible by children or people who are not familiar with operation.

STORING THE LAWNMOWER FOR EXTENDED PERIODS

If the lawnmower is to be placed into storage for more than 15 days, storage maintenance must be performed on the lawnmower. If the following steps are not carried out, when you next operate the lawnmower it may not start correctly and may need to be serviced.

- Empty the petrol tank with a petrol suction pump if available.
- Start the engine and let it run until any remaining petrol has been used up.
- Change the oil at the end of every season. To do so, remove the used engine oil from a warm engine and refill with fresh oil.
- Clean the cooling fins of the cylinder and the housing.
- Be sure to clean the entire machine to protect the paint.
- Store the machine in a well-ventilated place.



CAUTION! Do not empty the petrol tank in enclosed areas, near fire or when smoking. Petrol fumes can cause explosions and fire.

TRANSPORT

- Empty the petrol tank
- Always let the engine run until it has used up the remainder of petrol in the tank.
- Empty the engine oil from the warm engine.
- Remove the spark plug boot from the spark plug.
- Clean the cooling fins of the cylinder and the housing.
- Use the original packaging to ship whenever possible.

TROUBLESHOOTING

PROBLEM	POSSIBLE CAUSE	SOLUTION
Loud while running, machine vibrates heavily	<i>Screws are loose</i>	Check screws
	<i>Blade fasteners are loose</i>	Check blade fasteners
	<i>Blade is unbalanced</i>	Replace blade
Engine does not start	<i>Start/Stop Lever not engaged</i>	Engage Start/Stop Lever
	<i>Spark plug is defective</i>	Replace
	<i>Blade is worn or damaged</i>	Contact Customer Services at help@parkerbrand.co.uk
	<i>Fuel tank is empty</i>	Refill with fuel
	<i>Engine may be flooded</i>	Remove spark plug and dry
Engine runs unsteady	<i>Air filter is soiled</i>	Clean
	<i>Spark Plug is soiled</i>	Clean

TROUBLESHOOTING

PROBLEM	POSSIBLE CAUSE	SOLUTION
Uneven mowing	<i>Blade is blunt</i>	Sharpen blade
	<i>Cutting too low</i>	Adjust height
Grass Bag not filling sufficiently	<i>Blade is worn</i>	Replace
	<i>Grass Bag is clogged</i>	Empty
	<i>Lawn/Grass is wet</i>	Allow to dry
	<i>Discharge chute blocked</i>	Clean
	<i>Underside of mower deck clogged</i>	Clean
	<i>Cutting height is wrong</i>	Adjust height

1

SCAN QR CODE TO ACCESS ONLINE RESOURCES LIBRARY

HELPFUL PRODUCT RESOURCES

Gain access to the ParkerBrand online resource library for this product.

Resources include Detailed descriptions of products, literature, articles and video tutorials.

Simply scan the QR Code with your mobile devices camera.

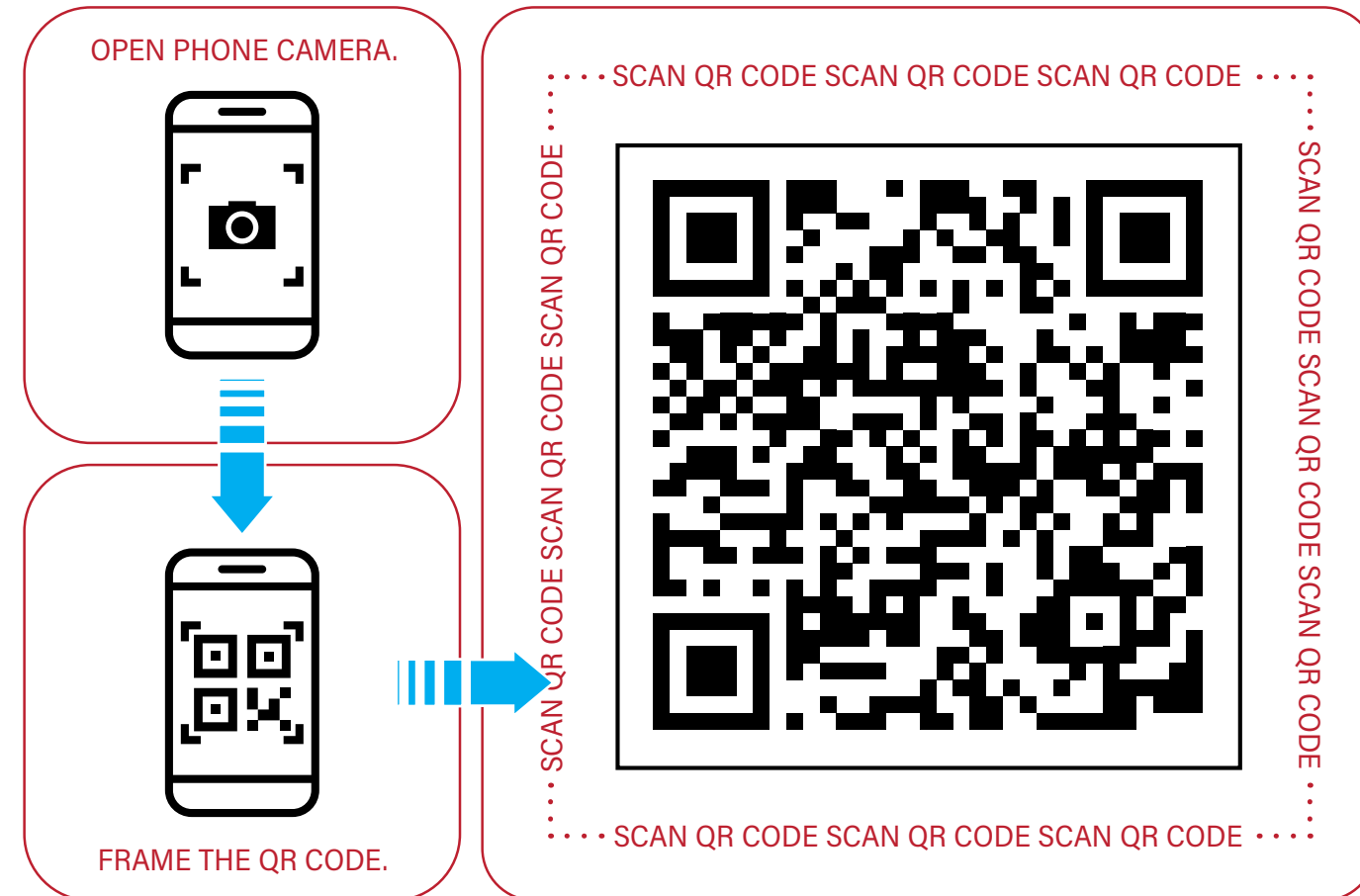

2

TAP POP-UP



Tap the link/pop up that displays after scanning the QR code.

It will take you directly to the product page for this machine on the ParkerBrand website.

3

SCROLL DOWN PRODUCT PAGE

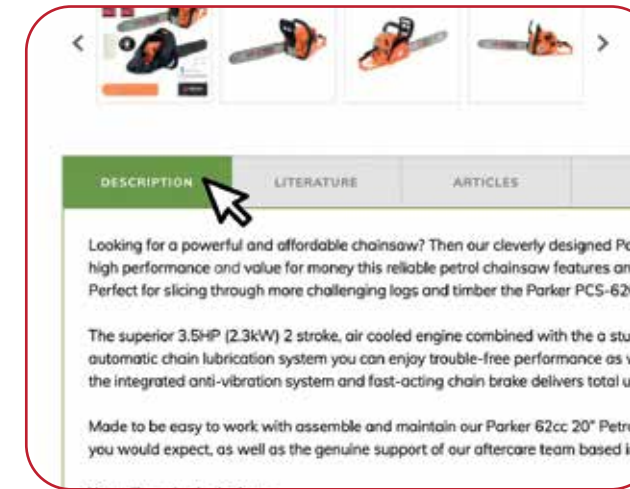

Scroll down the product page to the product description box. Take note of the green tab and the greyed out tabs along the top of the description box

4

SELECT A RESOURCE TO ACCESS

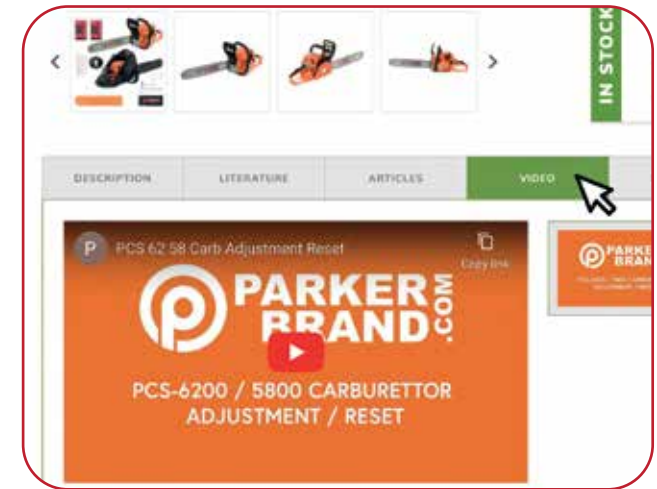

Click on the tab for the resource you'd like to access. Choose from **description**, **literature**, **articles** and **video**.

your chosen resource tab will be highlighted in green.



No resources for your product? Don't worry we are adding new content all the time. If you require help/advice with your product contact us via email at help@parkerbrand.co.uk

PPLM-21196 EXPLODED PARTS DIAGRAM 'A'

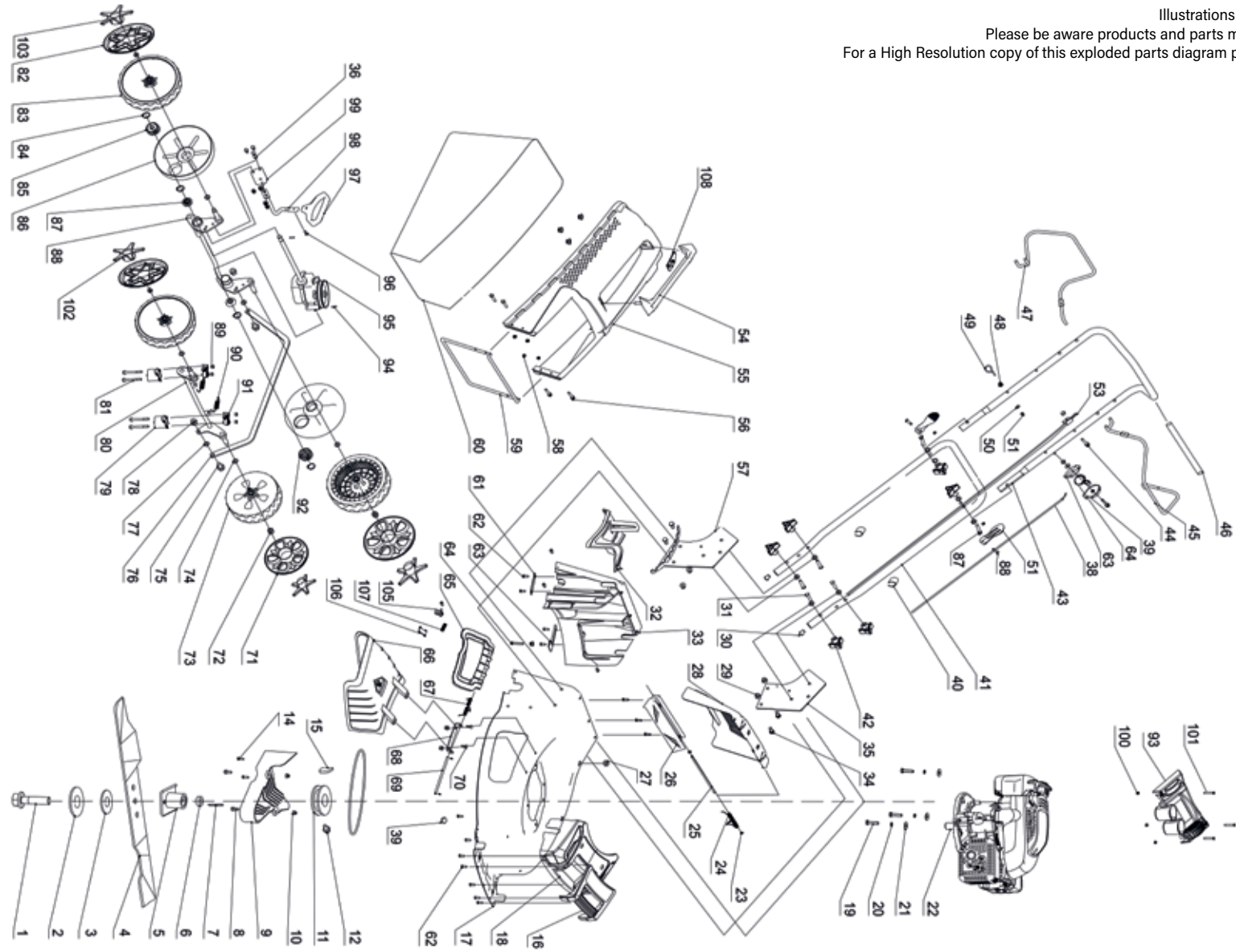

Illustrations accurate at time of going to print.
Please be aware products and parts may change design without notice.
For a High Resolution copy of this exploded parts diagram please visit www.parkerbrand.com

PPLM-21196 PARTS INDEX 'A'

PPLM-21196 PARTS INDEX

1	BOLT 3/8-24UNFX30	19	BOLT M8X30	37	FAST LOCK HANDLE	55	GRASS BOX COVER	73	FRONT WHEEL	91	HOLD HOOP
2	FLAT WASHER	20	SPRING WASHER	38	THROTTLE CABLE	56	SCREW M5X22	74	FLAT WASHER GB955	92	LEFT GEAR ASSEMBLY
3	WASHER	21	WASHER GB96	39	THROTTLE SWITCH COVER (R)	57	RIGHT HANDLE SUPPORT	75	FIXED BOLT	93	CONTROL PANEL
4	BLADE	22	ENGINE	40	CLIP	58	NUT M5	76	HEIGHT ADJUSTMENT LINK BAR	94	GEAR PIN
5	BLADE ADAPTER	23	CIRCLIP	41	LOWER HANDLE	59	FRAME	77	WASHER GB97	95	GEAR BOX
6	BLADE ADAPTER BUSH	24	REAR COVER SPRING	42	LOWER FIXING KNOB	60	FABRIC BAG	78	NUT GB6177 M6	96	SCREW M6X10
7	KEY	25	AXLE REAR COVER	43	UPPER HANDLE	61	REAR AXLE PLANK	79	HOLD LOOP	97	HEIGHT ADJUSTER HANDLE
8	BOLT M6x16	26	PLASTIC PART	44	BOLT	62	SCREW ST6.3X16F	80	FRONT WHEEL AXLE	98	HEIGHT ADJUSTER LEVER
9	BELT COVER	27	CABLE PROTECTION PIPE	45	BRAKE LEVER	63	THROTTLE SWITCH COVER (L)	81	BOLT M6X50	99	HEIGHT ADJUSTER SPRING
10	BOLT GB6318 M6	28	REAR COVER	46	SOFT GRIP	64	THROTTLE LEVER	82	WHEEL COVER	100	NUT M5
11	PULLEY	29	NUT M8	47	CLUTCH LEVER	65	SIDE DISCHARGE COVER	83	REAR WHEEL	101	BOLT M5*30
12	BOLT M6X6	30	STEM	48	PISTON RING	66	SIDE DISCHARGE CHUTE	84	CIRCLIP	102	FRONT WHEEL COVER
13	BELT V Z813	31	BOLT	49	PISTON RING	67	TORSION SPRING	85	RIGHT GEAR ASSEMBLY	103	REAR WHEEL COVER-
14	SCREW ST4.8X12F	32	MULCHING PLUG	50	WASHER GB97	68	SIDE DISCHARGE BRACKET	86	INNER WHEEL COVER	104	LOCKING PIN
15	KEY	33	BACK PANEL	51	NUT GB923 M6	69	SIDE DISCHARGE AXLE	87	BALL BEARING	105	SIDE COVER LOCKING CLIP
16	HOOD HANDLE	34	BOLT M8X20	52	BRAKE CABLE	70	BOLT GB801 M6X14	88	REAR WHEEL AXLE	106	CLOSED POSITION COVER
17	DECK	35	LEFT HANDLE SUPPORT	53	FAST LOCKING BOLTS	71	WHEEL COVER	89	BOLT GB41 M6	107	SIDE COVER LATCHING SPRING
18	FRONT DECORATIVE COVER	36	BOLT GB5783 M6X14	54	CARRY HANDLE	72	NUT M10	90	HEIGHT ADJUSTER SPRING	108	GRASS BOX INDICATOR

PPLM-21196 EXPLODED PARTS DIAGRAM 'B'

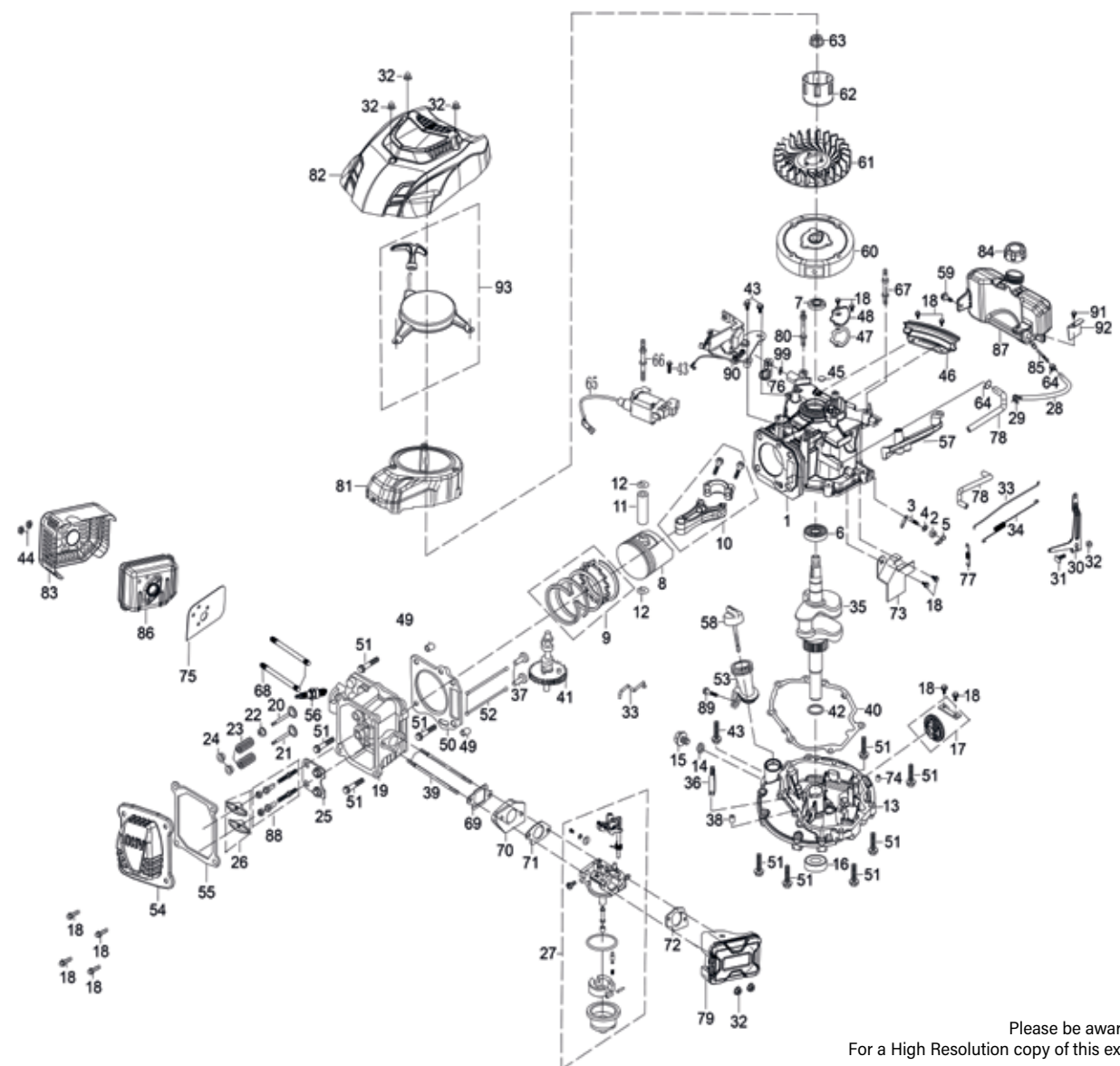

Illustrations accurate at time of going to print.
Please be aware products and parts may change design without notice.
For a High Resolution copy of this exploded parts diagram please visit www.parkerbrand.com

PPLM-21196 PARTS INDEX 'B'

PPLM-21196 PARTS INDEX

1	CRANKCASE	19	CYLINDER HEAD	37	VALVE LIFTER	55	HEADCOVER PACKING	73	UPPER SHROUD ASSEMBLY	91	CROSSING SCREW M4X8
2	GOVERNOR ARM SHAFT SEAL	20	VALVE	38	CASECOVER PIN DOWEL	56	SPARKPLUG	74	CASECOVER DOWEL PIN	92	SHROUD
3	GOVERNOR ARM SHAFT	21	VALVE EXHAUST	39	BOLT	57	SHROUD C	75	EXHAUST PACKING	93	RECOIL STARTER COMP
4	GOVERNOR ARM SHAFT WASHER	22	INTAKE VALVE RETURN	40	CASECOVER PACKING	58	DIPSTICK	76	WIRE HARNESS CLIPPING	-	-
5	LOCK PIN	23	VALVE SPRING	41	CAMSHAFT ASSEMBLY	59	BOLT M6X20	77	GOVERNOR SPRING	-	-
6	BALL BEARING	24	VALVE SPRING SEAT	42	CRANKSHAFT WASHER	60	FLYWHEEL ASSEMBLY	78	BREATHER TUBE	-	-
7	OIL SEAL	25	PUSH ROD GUIDE PLATE	43	BOLT M6X30	61	RECOIL STARTER FAN	79	AIR CLEANER ASSEMBLY	-	-
8	PISTON	26	ROCKER ASSEMBLY	44	NUT M6	62	STARTER PULLEY	80	RECOIL STARTER BOLT STUD	-	-
9	PISTON RING SET	27	CARBURETTOR ASSEMBLY	45	BREATHER VALVE COVER	63	NUT M14	81	FAN HOOD	-	-
10	CONNECTING ROD ASSEMBLY	28	FUEL LINE	46	SHROUD B	64	FUEL LINE CLIP	82	FAN COVER	-	-
11	PISTON PIN	29	FUEL LINE CLIP	47	BREATHER CHAMBER GASKET	65	IGNITION COIL ASSEMBLY	83	OUTER MUFFLER SHIELD	-	-
12	PISTON CLIP	30	GOVERNOR ARM	48	BREATHER CHAMBER CAP	66	IGNITION COIL BOLT STUD	84	FUEL TANK CAP COMP	-	-
13	CRANKCASE COVER ASSEMBLY	31	GOVERNOR ARM BOLT M6X21	49	DOWEL PIN	67	RECOIL STARTER BOLT STUD	85	FILTER	-	-
14	DRAIN PLUG WASHER	32	NUT M6	50	CYLINDER HEAD GASKET	68	BOLT	86	MUFFLER COMP	-	-
15	DRAIN PLUG BOLT	33	TIE ROD	51	BOLT M8X50	69	INTAKE PACKING	87	FUEL TANK -ASSEMBLY	-	-
16	OIL SEAL	34	THROTTLE RETURN SPRING	52	PUSH ROD	70	CARBURETTOR INSULATOR	88	BOLT	-	-
17	GOVERNOR ASSEMBLY	35	CRANKSHAFT ASSEMBLY	53	OIL FILTER EXTENSION	71	CARBURETTOR PACKING	89	BOLT M6X20	-	-
18	BOLT M6X12	36	OIL DEFENCE PIPE	54	CYLINDER HEAD COVER COMP	72	AIR CLEANER GASKET	90	BRAKE COMPONENTS	-	-



ORDER ONLINE

VISIT OUR ONLINE STORE FOR ALL YOUR
SPARE PARTS & CONSUMABLE NEEDS.

OUR PARTS DEPARTMENT IS EXSTENSIVE,
WE STOCK PARTS FOR ALL OF OUR
PRODUCTS.

SCAN THE QR CODE TO ACCESS
SPARE PARTS FOR THIS
PRODUCT.



CUSTOMER SERVICE

ParkerBrand congratulate you on your choice of equipment.

We know that you'll be excited to start using your machine and becoming familiar with it. We take time to produce useful manuals that serve you well. You'll find useful information on the further care and maintenance of your machine in your manual. We'd also like to assure you that we'll take care of you, should you need our assistance.

You will find useful resources on the ParkerBrand website (www.parkerbrand.co.uk) which you will find listed under articles or videos on the product page. Should you wish to speak with someone in person then we are very happy for you to call us.

Our Customer Service team are based in Louth, Lincolnshire and will be happy to speak with you to provide assistance. You can call on **(+44) 01507 499198** during office hours.

You are of course very welcome to email us at any time and a member of the team will respond. You can email us at the following address: help@parkerbrand.co.uk

We know that taking care of our customers in a helpful and straightforward manner is much appreciated, just as you, our customer are appreciated in turn.

Thank you for buying ParkerBrand we are here if you need us, be sure of it.



(+44) 01507 499198



help@parkerbrand.co.uk



www.parkerbrand.co.uk



SPECIFICATIONS

TECHNICAL SPECIFICATION

Drive type	Self-propelled
Displacement	173cc
Engine Max. Power	3.0KW/2800 rpm
Engine speed	2800 rpm
Fuel Tank Capacity	1.0L
Oil Tank Capacity	0.4L
Starting System	Recoil
Cutting width	530mm(21")
Cutting heights	25-75mm with 7 grades
Height adjustment	Centre adjustment
Catcher volume	75L
Deck material	Steel
Front/Rear wheel	8/10 Inch
Gear Box	PRC
Noise Measurement	
Measured sound power level	96 dB(A)
Guaranteed Sound Power Level	98 dB(A)

Grass catcher	Half plastic box
Blade	Straight blade
Ball bearing	Steel
Soft grip on the handle	Yes
Accessories	Spark Plug Wrench

Description & Function: Petrol Lawn Mower

Model/Type: PPLM-21196

Manufacturing Date/Serial Number: 2023

Conforms to the following Directives:

- ☒ 2006/42/EC Machine Directive (MD)
- ☒ 2014/30/EU Electromagnetic Compatibility Directive (EMC)
- ☒ 2000/14/EC + 2005/88/EC Noise Emission Directive (NED)

Manufacturer's authorised representative within the EC:

Parker Products Ltd.
Richmond Park, Richmond Road
Louth, LN11 0FU

Conforms to the requirements of the Directives, as indicated, and the following harmonised standard(s):

- ☒ EN ISO 5395-1:2013/A1:2018
- ☒ EN ISO 5395-2:2013/A2:2017
- ☒ EN ISO 14982:2009;

DECLARATION OF CONFORMITY

Conformity assessment procedure: 2000/14/EC amended by 2005/88/EC - Annex VI

Measured level of the acoustic output: 96 dB(A)

Guaranteed level of the acoustic output: 98 dB(A)

Technical file complied by: Parker Products Ltd

Being the responsible person appointed by the manufacturer.

Signed:



Date: 01/03/23

Name: Jason Parker

Position: Managing Director

Company: Parker Products Ltd.



PPLM-21196

April 2023

Rev 1.7