



# BRUSH CUTTER

PGBC-5200

OWNERS MANUAL

**This manual has been produced by Parker Products Ltd. and should be kept with the product and referenced for operation, maintenance and troubleshooting.**

This manual contains an overall description of the product, together with all the necessary information for using the product correctly and safely. It is highly recommended that this manual is read prior to any operation or maintenance of this product. The safety precautions and warnings are to ensure your safety and protect you from harm or damage to the product.

All photographs and drawings in this manual are supplied by Parker Products Ltd. to help you with the operation and maintenance of the product. The information contained in this manual was accurate at the time of production, however Parker Products Ltd. may make modifications to the product without notification.

This Brush Cutter has been designed for blowing / vacuuming areas in private house and hobby gardens.

The machine is to be used only for its prescribed purpose, any other use is deemed to be a case of misuse. The user / operator and not the manufacturer will be liable for any damage or injuries of any kind caused as a result of this.

Please note that our equipment has not been designed for use in commercial, trade or industrial applications. Our warranty will be voided if the machine is used in commercial, trade or industrial businesses or for equivalent purposes.

**Thank you  
ParkerBrand**

GENERAL SAFETY .....	4-5	FLOODED ENGINE PROCEDURE.....	42
SAFETY SYMBOLS .....	6-9	STOPPING THE ENGINE .....	43
FOR SAFE OPERATION .....	10-13	ADJUSTING THROTTLE CABLE & IDLING SPEED .....	44-45
WHAT'S IN THE BOX .....	14-15	OPEN & REPLACE SPOOL LINE .....	46-49
PRODUCT FEATURES .....	16-19	OPERATION .....	50-53
BEFORE USING THE BRUSH CUTTER .....	20-21	TROUBLESHOOTING .....	54-57
ASSEMBLY .....	22-27	ONLINE RESOURCE LIBRARY .....	58-59
 INSTALLING 3 TOOTH BLADE ( <i>PLEASE READ CAREFULLY!</i> ).....	28-31	MAINTENANCE & CARE .....	60-63
INSTALLING SPOOL .....	32-33	SPECIFICATIONS .....	66
WEARING THE HARNESS .....	34-36	GUARANTEE .....	67
FILLING THE FUEL TANK .....	38-39	DECLARATION OF CONFORMITY .....	69
 STARTING THE ENGINE ( <i>PLEASE READ CAREFULLY!</i> ).....	40-41		

## GENERAL SAFETY

- **WARNING!** - Never allow children or anyone who does not fully understand the directions given in the manual to use the machine.
- **ALWAYS USE** - Safety equipment; appropriate footwear, eye protection, ear protection, head protection, trousers and gloves.
- **DO NOT** - Wear loose clothing, jewellery, short trousers, sandals, or go barefoot.
- **NEVER** - Start the engine inside a closed room or building.
- **NEVER** - Use the product when ground is slippery, at night, during rain storms, lightning storms, or at times of strong wind.
- **DO NOT** - Start the engine within 3m of the fuelling point.
- **REMOVE** - All sources of sparks and flames before mixing and pouring fuel.
- **DO NOT** - Let anyone with in 15m of the product while in operation.
- **INSPECT** - The entire unit for loose fasteners and fuel leakages, Make sure that the cutting attachment is properly installed.
- **DO NOT** - Start cutting until you have a clear cutting area and a secure footing.
- **ALWAYS** - Use the harness supplied while operating the machine.
- **NEVER** - Smoke while operating the unit or refilling its fuel tank.
- **ALWAYS** - Keep the handles dry, clean and free of oil and fuel mixture.
- **ALWAYS** - Shut off the engine before putting the product down.
- **MAKE SURE** - All fuel is removed before transportation.
- **ALL MAINTENANCE** - Other than that listed in this manual should be carried out by professionally trained and certified personnel.



**WARNING!** • Always read and understand all safety and warning notices throughout the manual and on the machine.

## GENERAL SAFETY



### WARNING

To reduce the risk of injury, user must read instruction manual.



### GLOVES

Gloves should be worn where appropriate.



### HEAD, EYE & EAR PROTECTION

Approved head, eye & ear protection should be worn at all times during operation.



### BOOTS

Wear sturdy, non-slip boots.



### CLOTHING

Appropriate clothing should be worn during operation. Ensure clothing is made of strong fabric and is not baggy or loose.

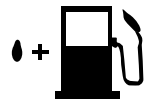

### FUEL FILLER POINT



### CLOSED CHOKE



### OPEN CHOKE



### ON

### STOP



**NOTICE** • For safe operation and maintenance symbols are moulded in relief on the machine or shown on a label.

SAFETY SYMBOLS



**WARNING!** To reduce the risk of injury, user must read instruction manual.



**DANGER!** Petroleum spirit is highly flammable. No smoking or naked light.



**NO SMOKING!**  
**DANGER!** Keep away from all sources of ignition.



**FLAMMABLE.**



This symbol indicates a **PRECAUTION**, a **WARNING** or a **DANGER**. Ignoring this warning can lead to an accident for yourself or for others. To limit the risk of injury, fire, or electrocution always apply the recommendations indicated.



**RISK OF FIRE** - Do not add fuel when operating.



**EXPLOSION HAZARD.**



Fuel/2-stroke oil mixture ratio.



Keep all children, bystanders & helpers 15 metres away from the machine.



**KEEP BY STANDERS AWAY.**

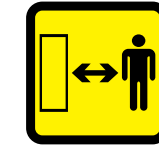

**BEWARE OF THROWN OBJECTS.**



**BEWARE OF SHARP BLADES.**



**DO NOT TOUCH THE MOVING PARTS OF THE MACHINE UNTIL THEY ARE COMPLETELY STOPPED.**



**RISK OF INJURY. DO NOT OPEN OR REMOVE SAFETY SHIELDS WHILE ENGINE IS RUNNING.**

SAFETY SYMBOLS



**WARNING!** Danger of kickback.



**WARNING!** Risk of entanglement.



**WARNING!** Protect feet from risk of injury.



**HOT SURFACES WILL BURN FINGERS OR PALMS.**



**WARNING!** Spinning cutting line.



**WARNING!** Use of this product can pose a danger to wildlife. Check areas, particularly long grass and under bushes for signs of life. If necessary relocate.

**NOTE:** Not all animals will be deterred by the noise of the product alone.



**WARNING!** Do not use the in an enclosed space. Exhaust fumes contain dangerous carbon monoxide.

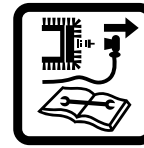

**REMOVE SPARK PLUG LEAD BEFORE MAINTENANCE.**



**WARNING!** Never to touch the spark plug or plug cord while the engine is in operation. Doing so may result in being subjected to an electrical shock.



.....Maximum speed of the applicable cutting unit.



**GUARANTEED SOUND POWER LEVEL.**



**WASTE ELECTRICAL PRODUCTS SHOULD NOT BE DISPOSED OF WITH HOUSEHOLD WASTE. PLEASE RECYCLE WHERE FACILITIES EXIST CHECK YOUR LOCAL AUTHORITY OR RETAILER FOR RECYCLING ADVICE.**

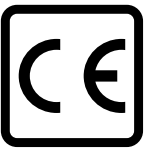

**CONFORMS TO CURRENT SAFETY STANDARDS**

## FOR SAFE OPERATION

### IMPORTANT

- Read this manual carefully until you completely understand and can follow all safety and operating instructions.
- Keep this manual handy so that you may refer to it later whenever questions arise. Also note, if you have any questions which cannot be answered herein, contact Parker Brand.
- Always be sure to include this manual when selling, lending or otherwise transferring ownership of this product.
- Never allow children or anyone unable to fully understand the directions given in the manual to use the machine.

### WORKING CIRCUMSTANCE

- Never start the engine inside a closed room or building. Exhaust gases contain dangerous carbon monoxide.
- **Never use the product:**
  1. *When the ground is slippery or when you can't maintain a steady posture.*
  2. *At night, at times of heavy fog, or at any other times when your field of vision might be limited and it would be difficult to gain a clear view of the working area.*
  3. *During rain or lightening storms, at times of strong gale-force winds, or at any other time when weather conditions might make it unsafe to use the product.*

### WORKING PLAN

- You should never use this product when under the influence of alcohol, when suffering from exhaustion or lack of sleep, when suffering from drowsiness as a result of taking cold medicine or at any other time when a possibility exists that your judgment might be impaired or that you might not be able to operate the product properly and in a safe manner.
- When planning your work schedule, allow plenty of time to rest. Limit the amount of time over which the product is to be used continuously to somewhere around 30-40 minutes per session, and take 10-20 minutes of rest between sessions. Also try to keep the total amount of work performed in a single day under 2 hours.
- If you don't observe the working time or working manner repetitive strain injury could occur,
- If you feel discomfort, redness and swelling of your fingers or any other part of your body, see a doctor before getting worse.
- To avoid noise complaints operate product between 9am and 5pm.

### BEFORE STARTING THE ENGINE

- The area within a perimeter of 15m of the person using the product should be considered a hazardous area into which no-one should enter. If necessary, yellow warning rope and warning signs should be placed around the perimeter of the area. When work is performed simultaneously by two or more persons, care should be taken to constantly look around or otherwise check for the presence and locations of other people working so as to maintain a distance between each person sufficient to ensure safety.
- Check the condition of working area to avoid any accident by hitting hidden obstacles such as stumps, stones, cans or broken glass.
- Inspect the entire unit for loose fasteners and fuel leakage. Make sure that the cutting attachment is properly installed and securely fastened.
- Be sure to attach the cutting attachment guard securely in place, or you may injure yourself.
- Always use the harness. Adjust the harness for comfort before starting the engine. The harness should be adjusted so the left hand can comfortably hold the handlebar grip approximately waist high.

### STARTING THE ENGINE

- Keep bystanders and animals at least 15m (50ft) away from the operating point. If you are approached, immediately stop the engine.
- The product is equipped with a centrifugal clutch mechanism, so the cutting attachment begins to rotate as soon as the engine is started by putting the throttle trigger into the start position. When starting the engine, place the product onto the ground in a flat clear area and hold it firmly in place so as to ensure that neither the cutting attachment nor the throttle trigger come into contact with any obstacle when the engine starts.
- After starting the engine, check to make sure that the cutting attachment stops rotating when the throttle trigger is moved fully back to its original position. If it continues to rotate even after the throttle trigger has been moved fully back, turn off the engine contact Parker Brand.

## FOR SAFE OPERATION

## FOR SAFE OPERATION

### USING THE PRODUCT

- Grip the handles firmly with both hands using your whole hand. Place your feet slightly apart (slightly further apart than shoulder width) so that your weight is distributed evenly across both legs, and always be sure to maintain a steady, even posture while working.
- Keep cutting attachment below waist level.
- Maintain the speed of the engine at the level required to perform cutting work, and never raise the speed of the engine above the level necessary.
- If the unit starts to shake or vibrate, turn off the engine and check the whole unit. Do not use until the problem has been properly corrected.
- Keep all parts of your body away from rotating cutting attachment and hot surfaces.
- Never touch the muffler, spark plug, or other metallic parts of the engine while the engine is in operation or immediately after shutting down the engine. Doing so could result in serious burns or electrical shock.

### BE CAREFUL OF SURROUNDING PEOPLE

- Guard against hazardous situations at all times. Warn adults to keep pets and children away from the area. Be careful if you are approached. Injury may result from flying debris.

### MAINTENANCE

- In order to maintain your product in proper working order, perform the maintenance and checking operations described in the manual at regular intervals.
- Always be sure to turn off the engine before performing any maintenance or checking procedures.
- In the event that any part must be replaced or any maintenance or repair work not described in this manual must be performed please contact ParkerBrand.
- Under no circumstances should you ever take apart the product or alter it in any way. Doing so might result in the product becoming damaged during operation or the product becoming unable to operate properly.

### HANDLING FUEL

- The engine of our product is designed to run on a mixed fuel, which contains highly flammable gasoline. Never store cans of fuel or refill the tank of the unit in any place where there is a boiler, stove, wood fire, electrical sparks, welding sparks, or any other source of heat or fire which might ignite the fuel.
- Never smoke while operating the unit or refilling its fuel tank.
- When refilling the tank, always turn off the engine and allow it to cool down. Take a careful look around to make sure that there are no sparks or open flames anywhere nearby before refuelling.
- Wipe spilled fuel completely using a dry rag if any spillage occurs during refuelling.
- After refuelling, screw the fuel cap back tightly onto the fuel tank and then carry the unit to a spot 3m or more away from where it was refuelled before turning on the engine.

### TRANSPORTATION

- When hand-carrying the product, cover over the cutting attachment if necessary, lift up the product and carry it paying attention to the cutting attachment.
- Never transport the product over rough roads or long distances by vehicle without removing all fuel from the fuel tank. If doing so fuel might leak from the tank during transport.



WHAT'S IN THE BOX - PGBC - 5200

ENGINE / THROTTLE / HANDLE BAR



UPPER & LOWER SHAFTS

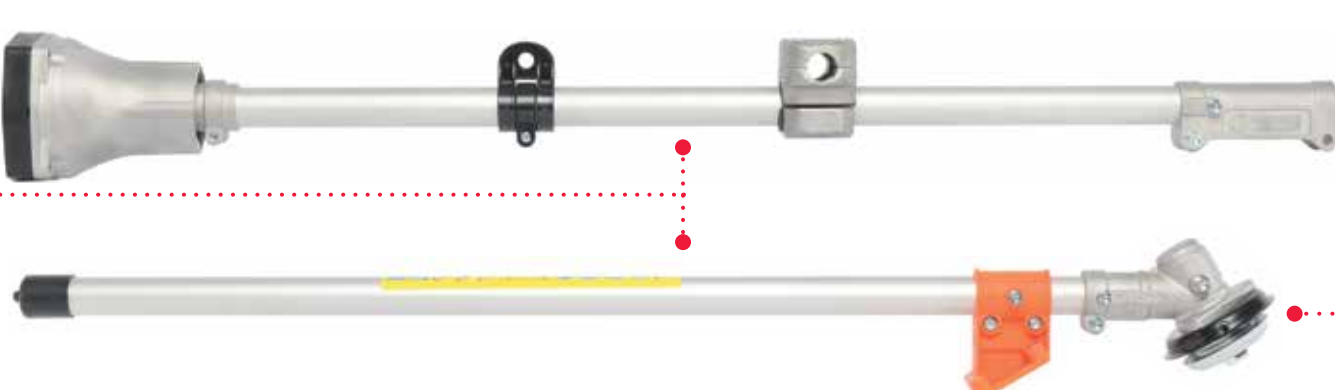

HUB WASHERS



HUB NUT



WASHER 'C'



WASHER 'B'



WASHER 'A'



Washers pre-installed on Lower Shaft and Hub.

PARTS PROVIDED WITH ALL PGBC-5200 MODELS

\*Products depicted on this page are for illustration purposes only, models may vary slightly.

PGBC - 5200 - WHAT'S IN THE BOX

LOWER GUARD



3 TOOTH BLADE



SPOOL



HARNESS



FUEL MIX BOTTLE



TOOL KIT

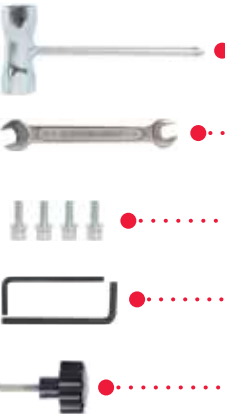

WRENCH / SCREWDRIVER



10 / 8mm SPANNER



CLUTCH CONE BOLTS X4



ALLEN KEYS X2



LOCKING KNOB

PARTS PROVIDED WITH ALL PGBC-5200 MODELS

\*Products depicted on this page are for illustration purposes only, models may vary slightly.





\*Products depicted on this page are for illustration purposes only, models may vary slightly.



\*Products depicted on this page are for illustration purposes only, models may vary slightly.

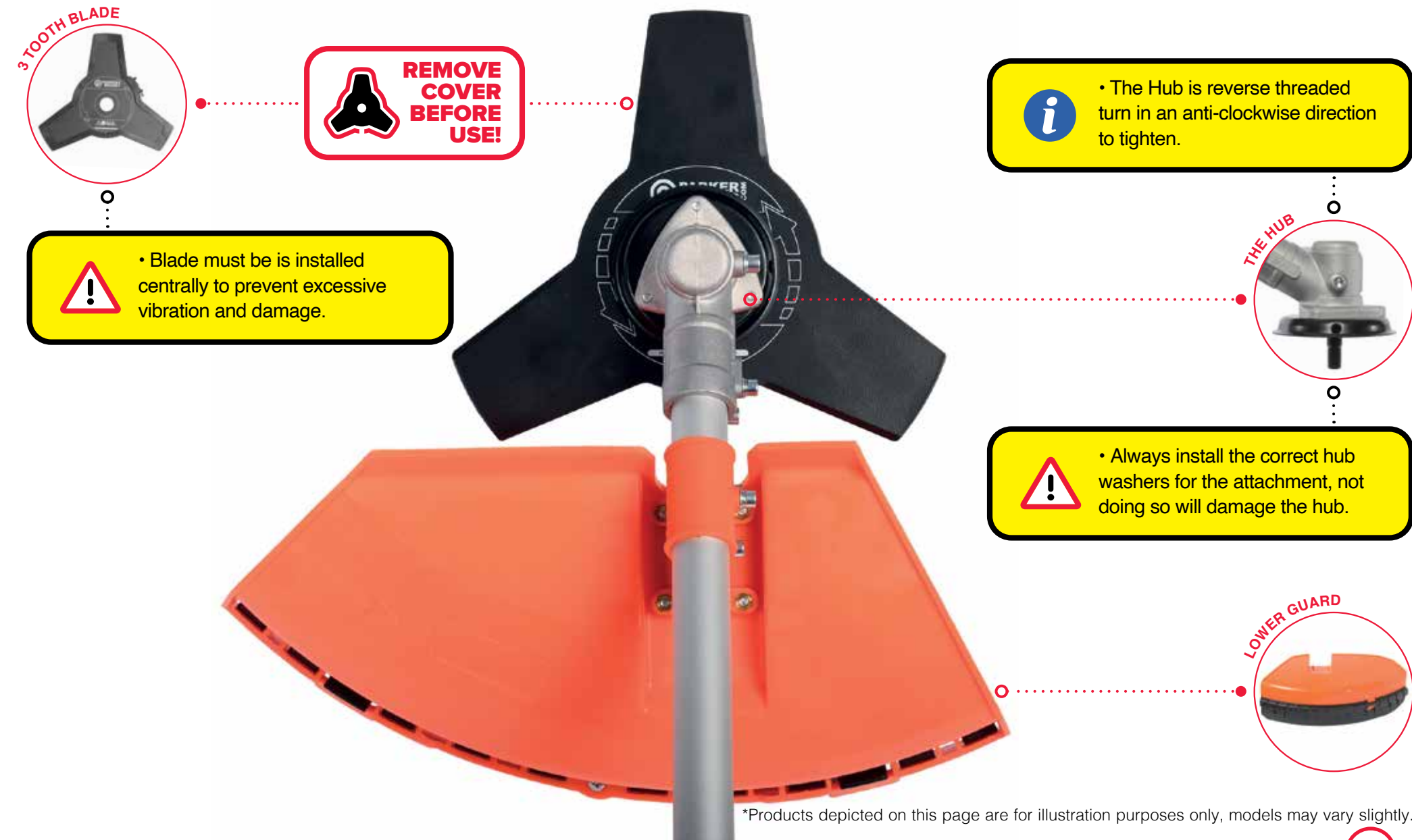
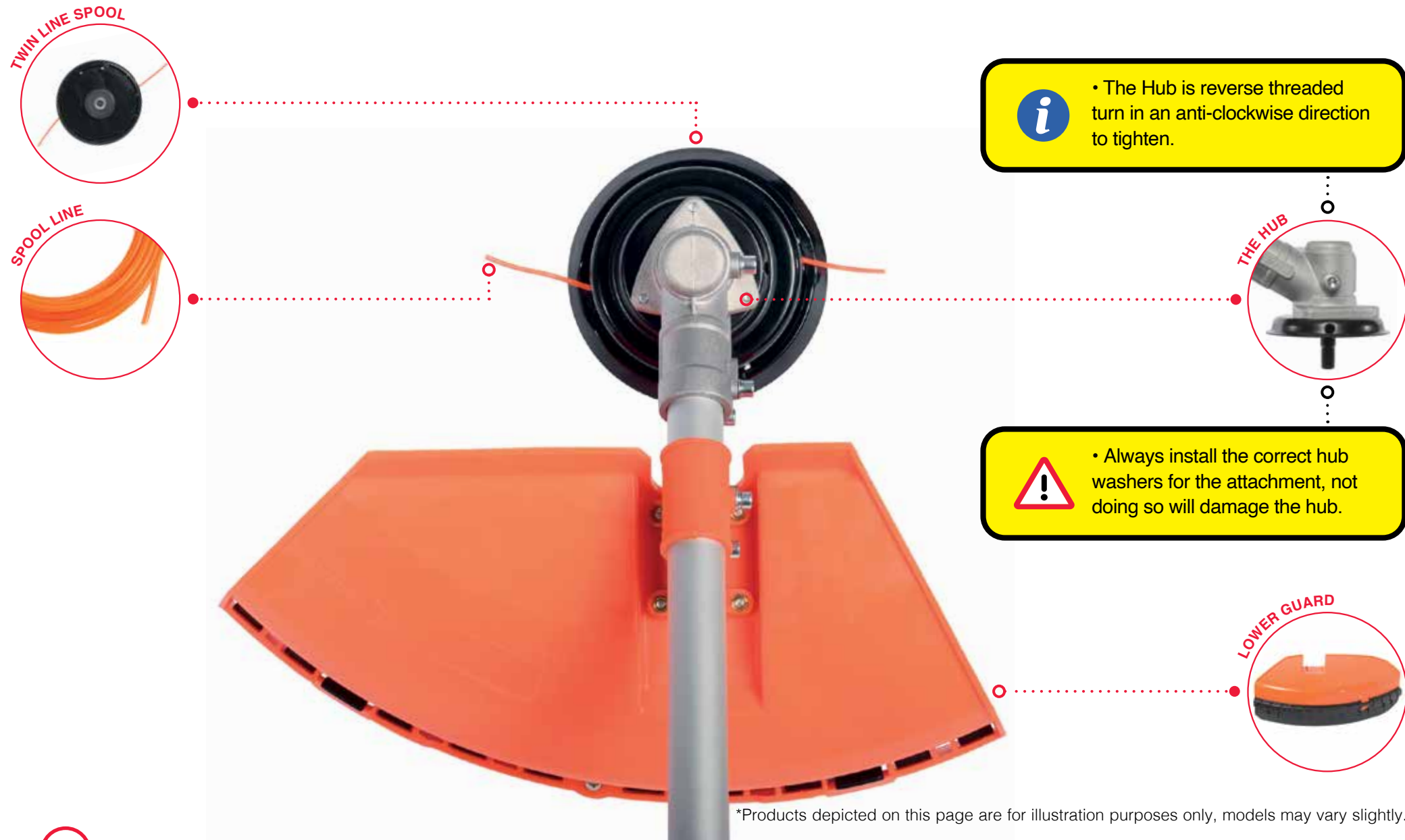



## NOTICE

**THIS FUEL MUST BE  
MIXED WITH 2 STROKE  
OIL AT A 40:1 RATIO  
(PETROL:OIL)**



### NOTICE

- This Brush Cutter is not supplied with any fuel or oil within the engine, there is only trace left from testing.
- The fuel for this machine must be mixed with 2 stroke oil at a **40:1** ratio (**Petrol:Oil**)
- Do not start without adding a **40:1** ratio (**Petrol:Oil**) first, failure to do so will damage the engine.

1

### INSPECT THE BRUSH CUTTER



Check the Brush Cutter is not damaged and all components are in good working order before use. Regular periodic inspection is required to ensure the Brush cutter is suitable for the task. Before using the Brush Cutter a risk assessment should be carried out respecting the legislation in the country of use.

2

### LOCKING WASHERS



The locking washers may come pre-installed on the hub of the machine. The hub will need assembling in different configurations to fit the appropriate attachments. Washer 'A' needs to be in place to attach both the Spool and the 3 tooth blade.

## NOTICE

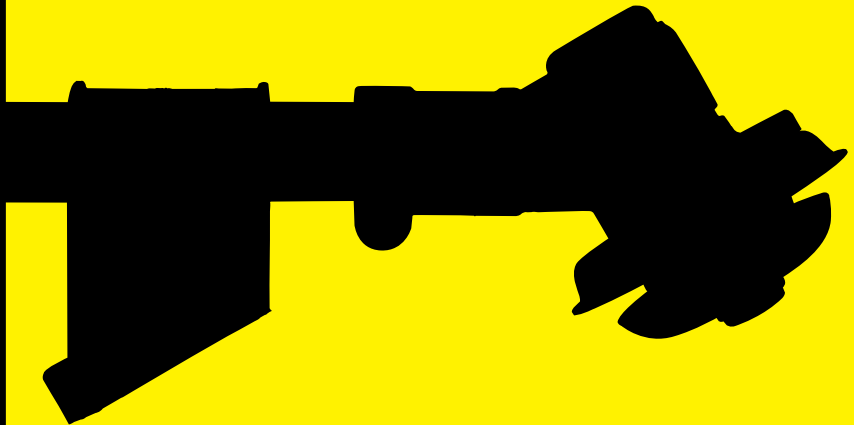

**THE HUB ON THIS MACHINE  
COMES PRE-ASSEMBLED**



### WARNING!

- Please follow all instructions carefully when fitting the various cutting attachments
- Do not start the Brush Cutter without making sure the cutting attachments are fitted properly.

# ASSEMBLY

## 1 TOOL KIT



Everything required to carry out the following procedure can be found in your PGBC-5200 tool kit, Including the 4 clutch cone bolts.

## 2 REMOVE PROTECTOR

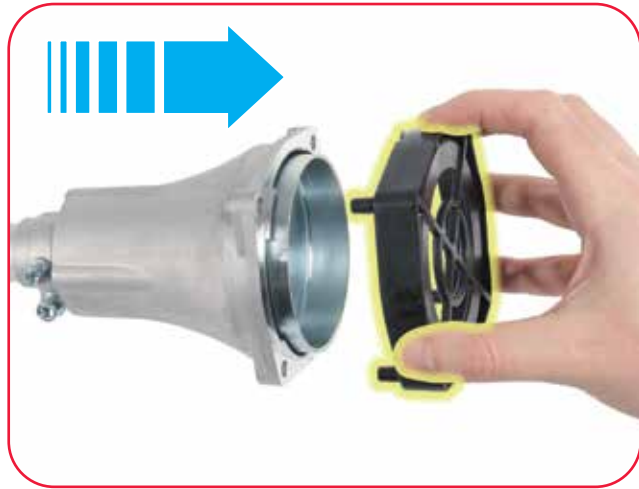

First remove the clutch cone protector. This is placed on to the clutch cone to protect it during shipping.

You can not attach the clutch cone to the main body of the machine with it in place.

## 3 MAIN BODY & CLUTCH CONE

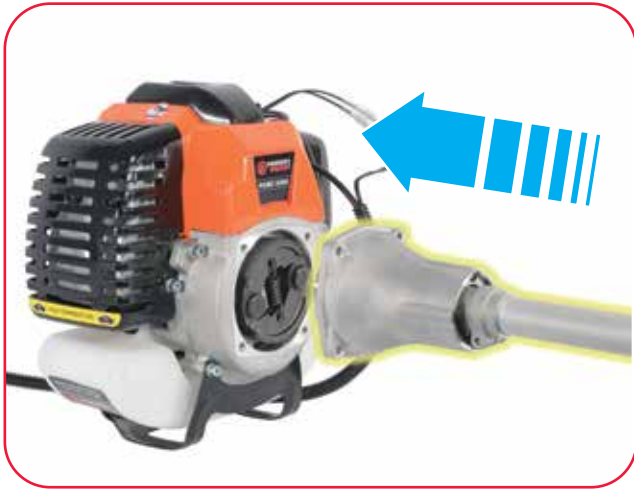

Locate the Main Body of the machine and the clutch cone from your PGBC-5200 box.

The clutch cone comes with the lower shaft attached.

## 4 ALIGN CLUTCH CONE TO BODY



Align the Clutch Cone and main body ensuring the bolt holes line up.

It may be easier if you lay the main body on its rear side whilst doing this.

## 5 FINGER TIGHTEN BOLTS



Finger tighten a bolt in one of the top bolt holes, then one in the diagonal opposing bottom hole.

Repeat this proces with the other two bolts.

## 6 TIGHTEN BOLTS



Tighten all the bolts with the allen key provided in the tool kit.

The clutch cone is now secured in place.

**NOTICE**

- To prevent damage to the product in transit the clutch cone has been removed from the machine.
- Please follow the instructions provided carefully for successful installation of the clutch cone assembly.

**WARNING!**

- Only use the bolts provided for the clutch cone. These are located in the PGBC-5200 toolkit.
- Do not use the bolts from the handle clamp, these are too long and will damage the clutch.
- Using the brush cutter with the wrong bolts attached may damage the clutch beyond repair.

## ASSEMBLY

### 1 ALIGN THE LOWER GUARD



Align the lower guard to the lower guard attachment bracket located at the end of the lower shaft next to the hub.

### 2 ATTACH THE LOWER GUARD



Attach the guard to the guard attachment bracket using the screws which are already installed in the lower guard, use the tools provided within the tool kit.

### 3 ATTACH THE HANDLE

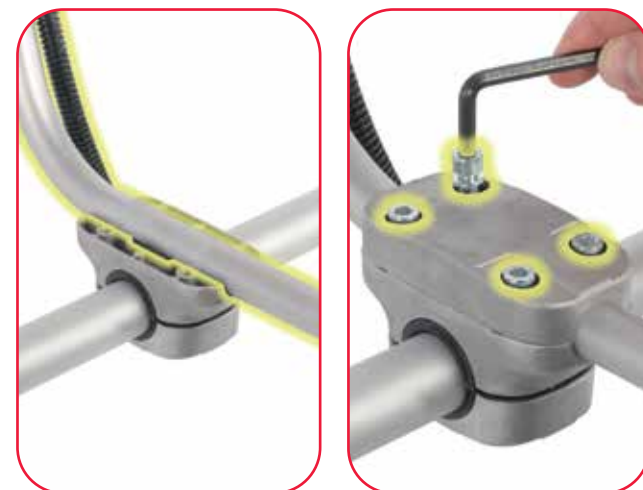

Loosen the four screws on the upper cap. Remove the upper cap and place the bull horn handle inside the recess.

Replace the upper cap and re-tighten the four securing screws. The bullhorn handles are now secured in place.



## CAUTION!

- Over-tightening the bolts can cause damage to the screw and/or the machine.

## ASSEMBLY

### 4 SHAFT TO JOINT ASSEMBLY

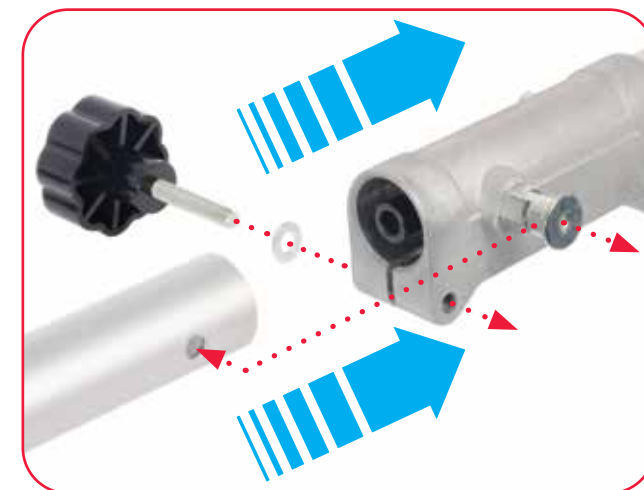

Insert the locking knob into the shaft connector.

Pull and twist the locating pin to lock it into the open position before inserting the lower shaft into the joint.

### 5 ALIGN THE SPLINES

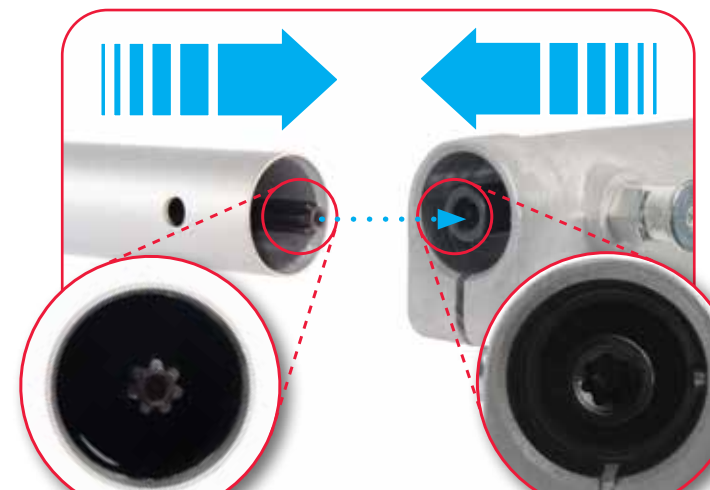

When inserting the shaft into the joint pay particular attention to the splines within the shaft.

It is essential that the splines are connected correctly for the machine to operate.

### 6 JOIN THE SHAFTS

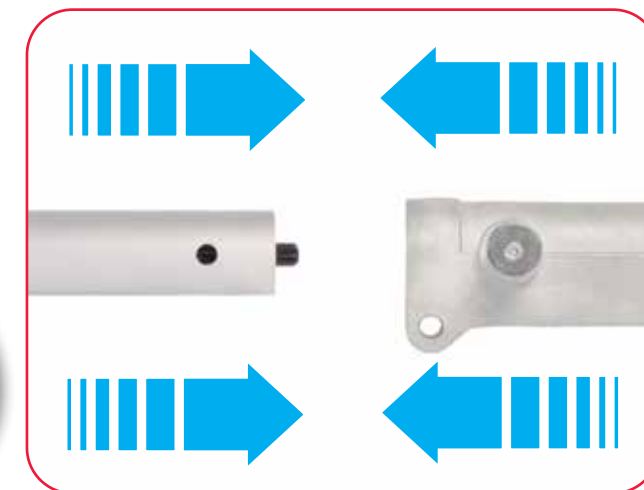

Once you are satisfied that the splines and the locating pin hole are aligned sufficiently, connect the shaft to the joint.



## WARNING!

- Do not use the machine without the locking knob attached and tightened to the shaft connector.
- It is essential that the locking knob is secured when using the machine, failure to do so can damage the machine.
- Take care aligning the splines, if the splines are not connected correctly the machine will not function correctly.



7

RELEASE LOCATING PIN



Twist to release the pin and rotate the lower shaft until the pin locates into the location hole.

8

TIGHTEN KNOB



Secure the joint by tightening the knob. To tighten the knob turn in a clockwise direction.

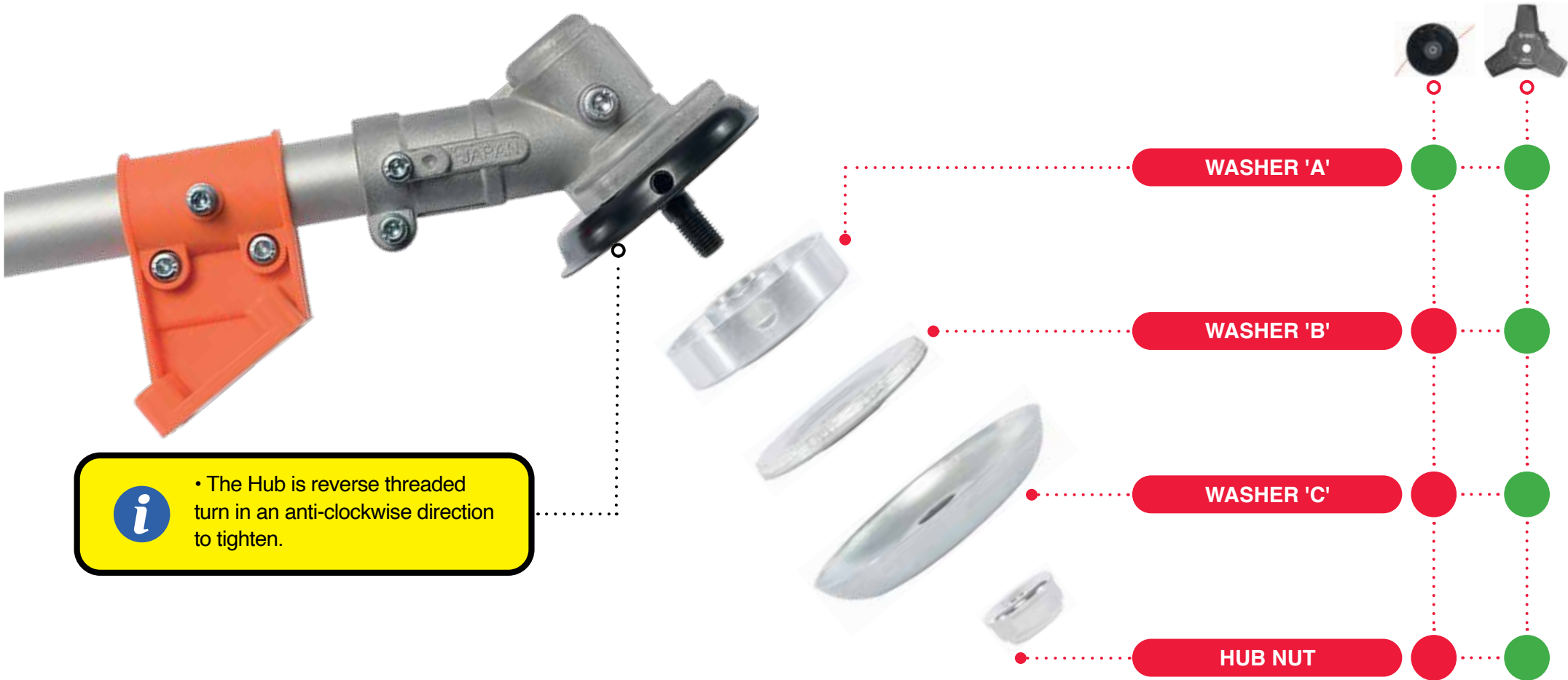

**i** • The Hub is reverse threaded turn in an anti-clockwise direction to tighten.

**!** • Always install the correct hub washers for the attachment, not doing so will damage the hub.

## ⚠️ INSTALLING THE 3 TOOTH BLADE - PLEASE FOLLOW THE INSTALLATION GUIDE CAREFULLY!

### 1 INSTALL WASHER 'A'



Install washer "A" as illustrated above. Align the hole in the washer with the hole in the spool collar. This is to help you lock the hub with an allen key later on in the process.

### 2



Place the three tooth blade so the centre hole sits on the protrusion on washer "A".



Above is an image of the 3 tooth blade seated in the correct position on the protrusion on washer "A".

## PLEASE FOLLOW THE INSTALLATION GUIDE CAREFULLY! - INSTALLING THE 3 TOOTH BLADE ⚠️

### ATTACH 3 TOOTH BLADE



It is important that the 3 tooth blade sits correctly on washer "A" and not in an off-centered position. Having the 3 tooth blade installed incorrectly can cause excessive vibration and premature damage to the lower shaft and the blade itself. It can also be incredibly dangerous to the user and any bystanders nearby the work area.



### 3 INSTALL WASHER 'B'



Install washer "B" as illustrated. Washer "B" sits on top of the three toothed blade.



### **i NOTICE**

- Please be aware that Washer "A", "B", "C" and the Hub Nut may come pre-installed on the hub of the machine.
- Always remove the 3 tooth blades protective cover before use.

### **⚠️ WARNING!**

- Ensure the 3 tooth blade is installed correctly, not doing so will damage the machine.
- Using the 3 tooth blade whilst installed incorrectly is dangerous and could potentially cause serious injury.



**⚠ INSTALLING THE 3 TOOTH BLADE - PLEASE FOLLOW THE INSTALLATION GUIDE CAREFULLY!**

**4 INSTALL WASHER 'C'**



Install washer "C" as illustrated above. Washer "C" sits on top of washer "B".

**5 INSTALL HUB NUT**



Install the hub nut as illustrated above to secure the blade to the shaft. The hub is reverse threaded so turn in an anti-clockwise direction to tighten.

**6 TIGHTEN HUB NUT**



Place the allen key through the locating hole of the collar, through the hole of washer "A" and into the hub. Tighten the nut using the wrench provided, turning anti-clockwise until secured tightly.



**i NOTICE**

• The hub is reverse threaded so to tighten the nut you will have to turn it in an anti-clockwise direction to ensure that it is secured in place along with the chosen cutting attachment. To loosen the nut use the allen key to lock the hub first then the wrench provided and turn it in a clockwise direction.



**PLEASE FOLLOW THE INSTALLATION GUIDE CAREFULLY! - INSTALLING THE 3 TOOTH BLADE ⚠**

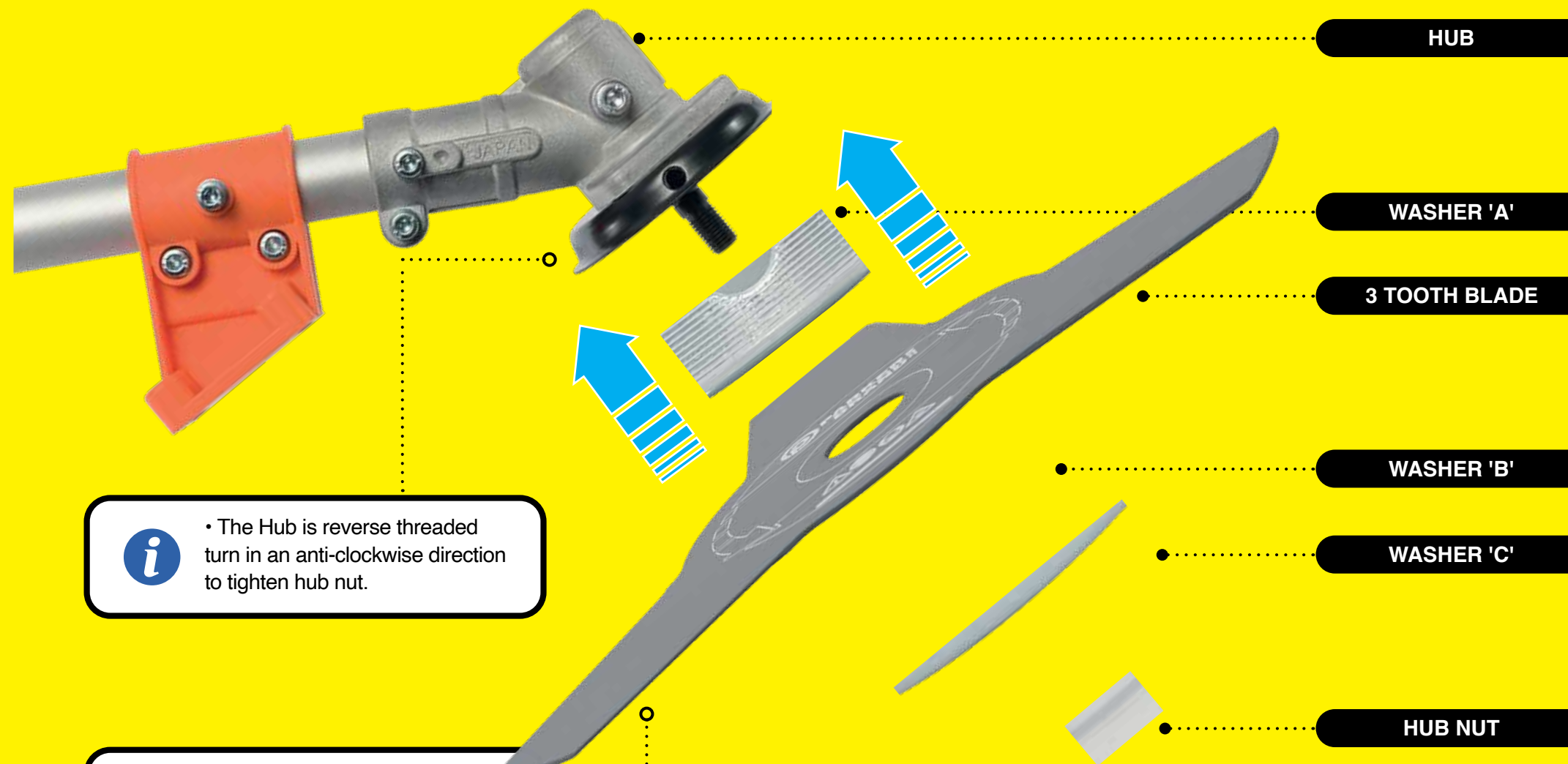

• The Hub is reverse threaded turn in an anti-clockwise direction to tighten hub nut.



• Always install the **3 TOOTH BLADE** centrally, not doing so will cause excessive vibration.

INSTALLING THE SPOOL

1 INSTALL WASHER 'A'



Install washer 'A' as illustrated above. Align the washer with the hole on the spool collar. The purpose of this washer is to enable tightening of the nut by locking the hub.

2 LOCK HUB



Lock the hub by inserting the allen key through the hole in the spool collar and into the hole in washer 'A'.

3 ATTACH SPOOL HOUSING



Wind the spool onto the thread by turning anti-clockwise.  
Please ensure that the spool is secure and closed correctly prior to use.

**NOTICE**

• Please be aware that Washer "A", "B", "C" (Locking Washers) and Hub Nut may come pre-installed on the hub of the machine.



• To remove the spool follow the above directions in reverse.

INSTALLING THE SPOOL

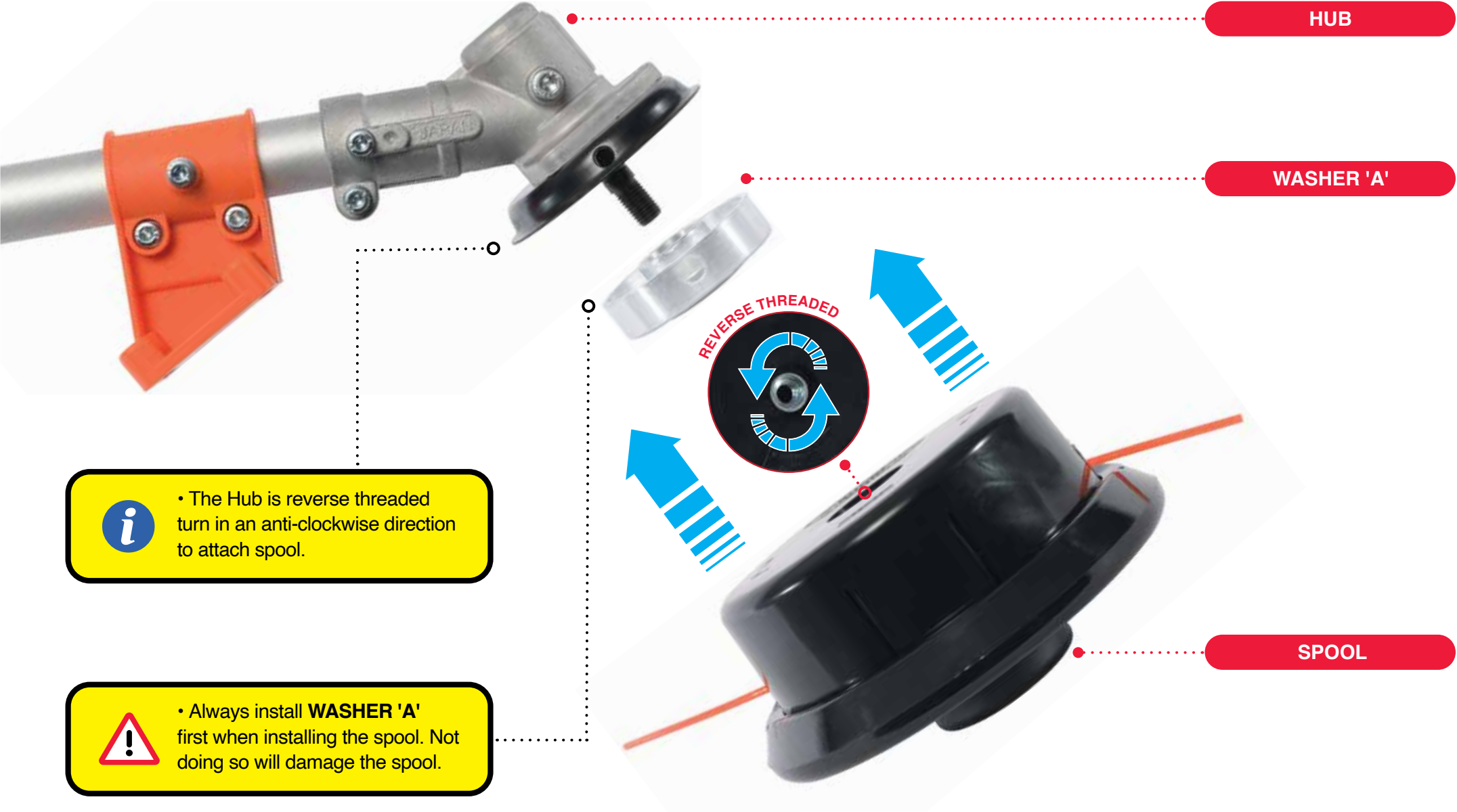

**HUB**

**WASHER 'A'**

**SPOOL**

**REVERSE THREADED**

• The Hub is reverse threaded turn in an anti-clockwise direction to attach spool.

• Always install **WASHER 'A'** first when installing the spool. Not doing so will damage the spool.



WEARING THE HARNESS

1 THE HARNESS



Included with your PGBC-5200 is the harness. The harness ensures you can work both safely and comfortably whilst using your machine.

It features padded straps for extra comfort, protective thigh pad, fully adjustable straps and a quick release hook.

2 PLACE OVER HEAD



Place the Harness over your head ensuring that the padded shoulder straps are placed on to your shoulders.

3 SNAP BUCKLE

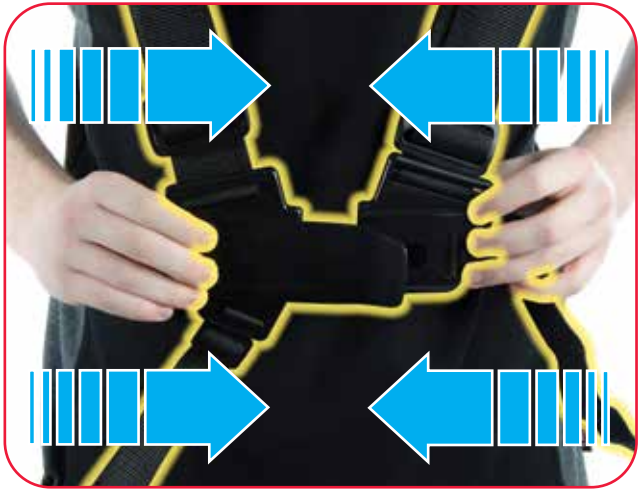

Lock the snap buckle to secure the harness loosely in place

4 ADJUST TO FIT

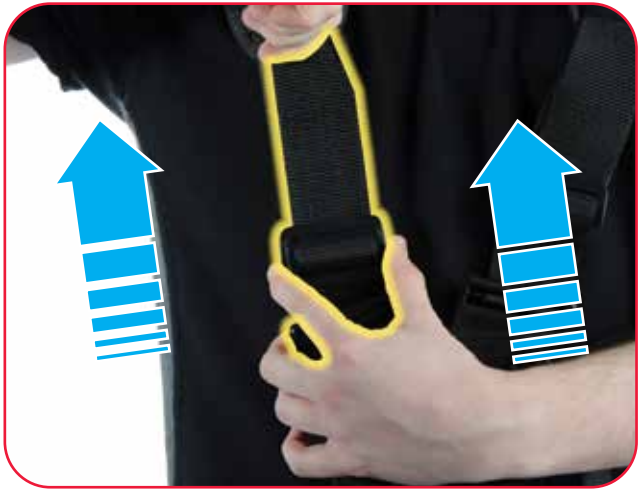

The harness is fully adjustable with 8 strap adjusters to ensure the best possible fit. Be sure to evenly spread the weight over both shoulders using the strap adjusters.

Tighten or loosen the harness to best suit your frame. Please be aware you may need to re-adjust to ensure the harness is in the most comfortable position to suit you.

5 THIGH PAD



Ensure the thigh pad is located in the correct position so it protects you fully from pressure points created from contact with the machine during use.

The thigh pad is normally positioned on the right hand side, this is the same side that the machine will be positioned.

6 FRONT VIEW & REAR VIEW



Your harness is designed to be worn with the snap buckle at the front.

The Multi Tool should hang on the right and rest against the thigh pad.

The back plate should sit centrally on your back. Adjust the harness so it is secured against your body in the most comfortable position.

The harness is easily adjusted by utilizing the strap adjusters.

**CAUTION!** • For your own safety, comfort and for best results always use the PGBC-5200 with the harness provided

# WEARING THE HARNESS

7

## QUICK RELEASE HOOK

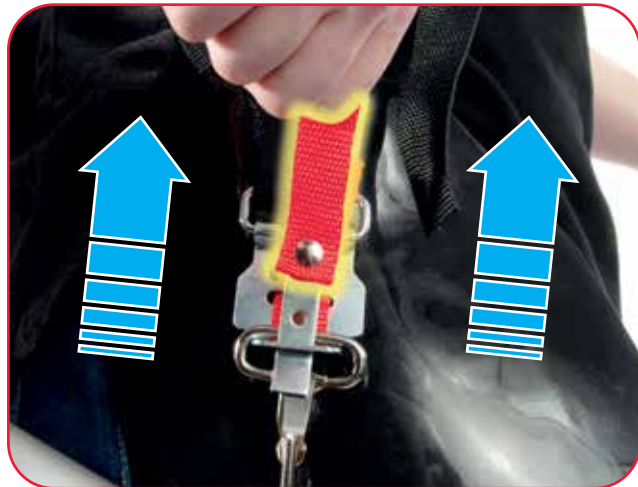

Easily attach and release the machine from the harness using the quick release hook.

To release the unit from the hook pull the orange tab upwards.

Please make sure the machine is properly secured or supported before releasing the quick release hook to prevent damage.

8

## REPLACE LOWER HOOK



After use of the quick release hook it will need to be re-assembled.

Place the lower hook over the upper hook with orange tab attached.

9

## INSERT RELEASE PIN



Place the release pin through the slot in the upper hook making sure that the pin passes over the lower hook.

The quick release hook is now re-assembled and ready to be used again when needed.

THIS PAGE HAS INTENTIONALLY BEEN LEFT BLANK



## WARNING!

- Ensure engine is turned off before using the quick release hook
- Before using quick release hook place machine on a solid surface, dropping the machine will cause damage to the unit.

FILLING THE FUEL TANK

1 REMOVE FUEL CAP



The engine of our product is designed to run on a mixed fuel of petrol and 2-stroke which is highly flammable. Never smoke while refilling its fuel tank. Place on the ground or on a sturdy work surface, and wipe any debris from around the fuel cap.

Remove the fuel cap and fill the tank to no more than 80% capacity. The fuel cap must be secure and tight for the carburettor to prime.

**WARNING!**

- Danger of fire and burn injury! Always use extreme care when handling petrol. It is highly flammable.
- Never operate this Brush Cutter if fuel system components are damaged or are leaking.
- Don't smoke or light any fires near the blower or stored fuel.

**ALWAYS MIX FUEL TO CORRECT 40:1 RATIO (PETROL:OIL)**

**40:1**

**+**

Always ensure your petrol is mixed with 2-stroke oil at a ratio of **40:1(PETROL:OIL)** so the machine runs at its optimum performance. Too much 2-stroke oil and the machine will smoke, too little and premature engine damage will occur. Please use the table above when calculating your **40:1(PETROL:OIL)** mix if you need to mix a larger quantity than the fuel mix bottle provided with this product.

40:1 RATIO	
PETROL (L)	OIL (ML)
1	25
2	50
3	75
4	100
5	125
7.5	188
10	250
15	375
20	500
25	625

2 FILL THE FUEL TANK



Always turn off the engine and allow it to cool down first . Fill the tank with the clean, fresh pre-mixed petrol and 2-stroke oil. Use a funnel if required to prevent any unnecessary spillages. Wipe up all spilled fuel completely. When refilling the tank, take a careful look around to make sure that there are no sparks or open flames anywhere nearby before refuelling. After refilling the tank replace the fuel cap.

**WARNING!**

- Never refuel when the engine is running.
- Allow engine to cool before attempting to refill the fuel tank.
- Do not store the machine with any fuel left in the fuel system..

FILLING THE FUEL TANK

i DRAIN THE FUEL AFTER USE

Allow the engine to cool then thoroughly clean the machines exterior before storage.

Inspect the entire machine especially the fuel lines for damage, including loose or missing components and repair / replace as necessary.

Never store the machine with fuel left inside the fuel tank, fuel lines and carburettor. Petrol is corrosive and can and will corrode the fuel lines over time. Petrol also evaporates quickly but 2-stroke does not, this will block the jets of the carburettor causing starting issues when you next want to use the machine at a later date.

Always drain the fuel tank and clear the carburettor and fuel lines by emptying the fuel tank, starting the machine and running until the machine stops.

Never transport the product over rough roads or long distances by vehicle without removing all fuel from the fuel tank. If doing so fuel might leak from the tank during transportation and create unnecessary fire hazards.



**⚠ STARTING THE ENGINE - PLEASE FOLLOW THE STARTING GUIDE CAREFULLY!**

**1 PRIME THE CARBURETTOR**



The engine switch is spring loaded. The default position of the switch is the 'ON' position.

Prime the fuel system by repeatedly pressing the fuel primer bubble at least 6 times or until the bubble is full of fuel.

**ONLY PRIME BEFORE A COLD START.**

**2a COLD START PROCEDURE STEP 1**

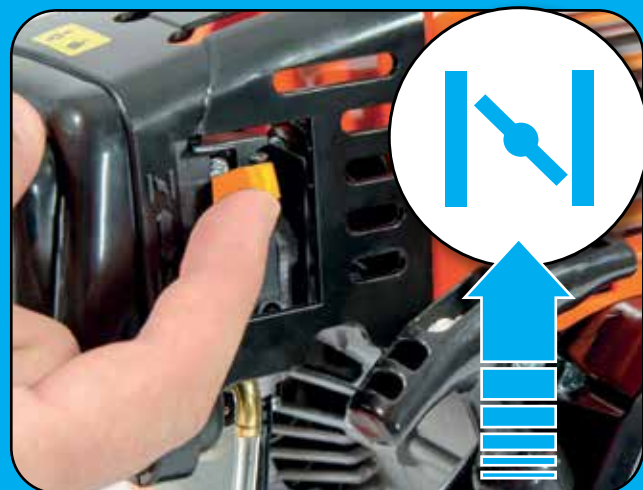

Perform a 'Cold Start' when the engine is cold. Move the choke lever into the upward position.

If the engine is cold  
proceed directly to  
step **2b**

If the engine is warm  
proceed directly to  
step **3**

**2b COLD START PROCEDURE STEP 2**



Pull the recoil starter firmly **TWICE ONLY!**

**BE AWARE THE ENGINE MAY OR MAY NOT START AFTER THE FIRST TWO PULLS.**

Regardless of the outcome proceed to step **3**

**PLEASE FOLLOW THE STARTING GUIDE CAREFULLY! - STARTING THE ENGINE ⚠**

**3 OPEN CHOKE**

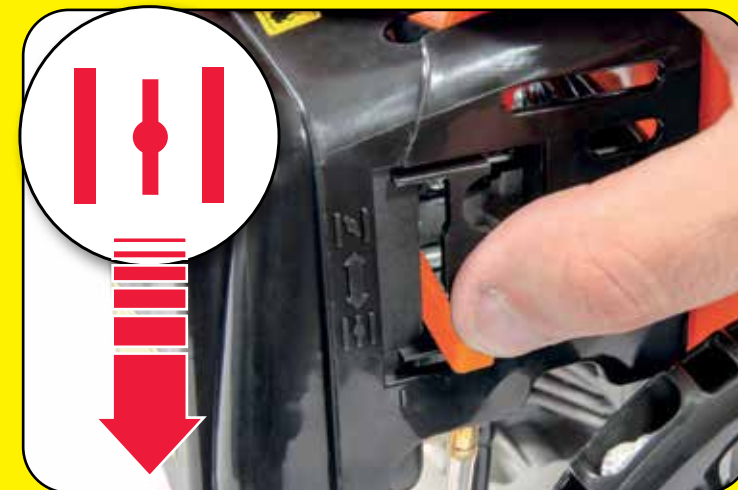

At this stage the choke must be **OPEN**.

Move the choke lever into the downward position.

**4 PULL RECOIL STARTER**



Pull the recoil starter continually until the engine starts.

Allow the engine to idle for 2 to 3 minutes before use.

If the engine still does not start return to step **2a**  
and follow the cold start procedure.



**WARNING!**

- Only operate the Brush Cutter after ensuring the exhaust is functioning properly.
- Never operate the Brush Cutter unless it is properly assembled and in good working condition.
- Only perform a cold start when the engine is cold / the machine has not been used recently.



**WARNING!**

- Do not pull the recoil more than twice with the choke in the closed position it will flood the engine!
- To perform the flooded engine procedure turn to page **42** before attempting to start the machine again.

## FLOODED ENGINE PROCEDURE

### 1 DISCONNECT THE COIL PACK



Disconnect the spark plug lead carefully by pinching the top and pulling away from the engine.

### 2 REMOVE SPARK PLUG



Remove the spark plug using the spark plug wrench. If the spark plug is fouled or is soaked with fuel, clean or replace.

Clean excess fuel from the combustion chamber by pulling the starter cord several times with the spark plug removed.

### 3 INSTALL SPARK PLUG



Install the spark plug and firmly tighten up with the spark plug wrench.

If a torque wrench is available, torque the spark plug to 148-165 inch-pounds. Reconnect the spark plug lead.



## WARNING!

- The machine must be turned off while carrying out any maintenance!

## STOPPING THE ENGINE

### 1 STOPPING THE ENGINE



- **LET THE ENGINE COOL.**  
Allow the engine to cool by running it at idle for 2 or 3 minutes.
- **TURN THE POWER OFF.**  
Press the **ON/OFF** switch into the '**OFF**'(**O**) position. This will stop the engine. The switch is spring loaded and will return to the default '**ON**'(**I**) position.
- **NEVER ATTEMPT TO REFUEL A HOT ENGINE!**  
Always allow the Brush Cutter engine to cool before refuelling!
- **NEVER STORE A MACHINE WITH A HOT EXHAUST!**  
Always allow the exhaust to cool before storing and transporting. Storing a machine with a hot exhaust near anything flammable is extremely dangerous!



## WARNING!

- The exhaust gets extremely hot during use, hot surfaces will burn fingers or palms.
- When storing the Brush Cutter for long periods ensure all fuel is drained from the machine.
- Storing a machine with a hot exhaust near anything flammable is extremely dangerous!



## ADJUSTING THROTTLE CABLE & IDLING SPEED

### 1 LOCATE AIR FILTER COVER



Locate the air filter cover on the machine. It is attached to the carburettor with an allen head bolt. Use the allen key provided in the tool kit to loosen the bolt.

### 2 REMOVE AIR FILTER COVER



Remove the air filter cover. You will need to do this to gain access to the throttle cable and idle adjustment screw located on top of the carburettor.



## WARNING!

- Always reinstall the air filter after carrying out any maintenance.
- Be aware running the engine with no air filter can damage the engine.

## ADJUSTING THROTTLE CABLE & IDLING SPEED

### 3 ADJUSTING THROTTLE CABLE



Your throttle cable may become slack after prolonged use and adjustment may be required.

To adjust the throttle cable loosen or tighten the nuts highlighted above. Use the 10mm spanner provided in the tool kit to do so. Always allow 1-2mm of play to ensure the cable is not under load at all times.

### 4 ADJUSTING IDLING SPEED



⌚  
⊕ When the engine tends to stop frequently at idling mode, turn the idle speed adjuster screw clockwise. The idle speed adjuster screw is highlighted above.

⌚  
⊕ When the cutting head keeps rotating after releasing the trigger, turn the idle speed adjuster counter clockwise.

OPEN & REPLACE SPOOL LINE

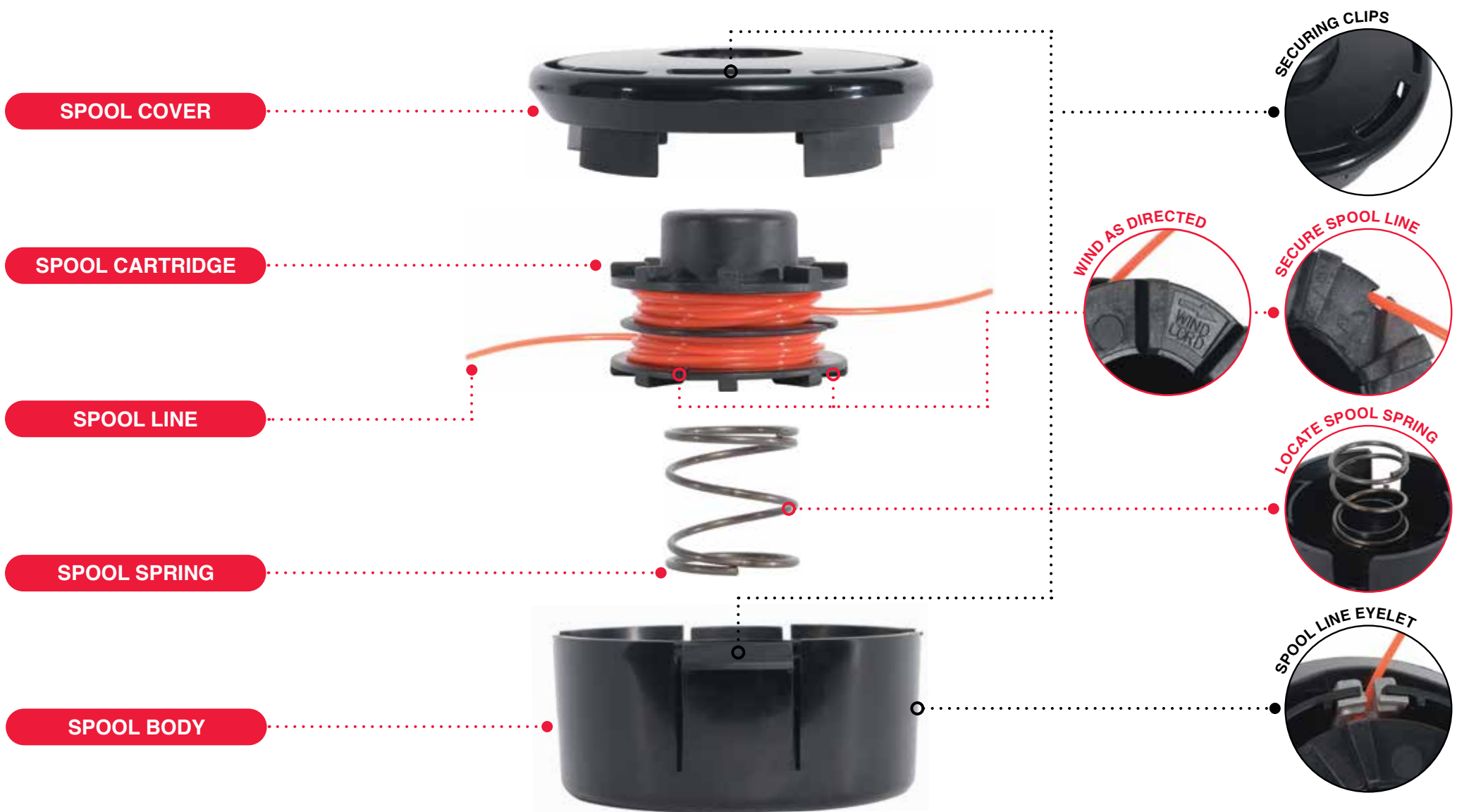

OPEN & REPLACE SPOOL LINE

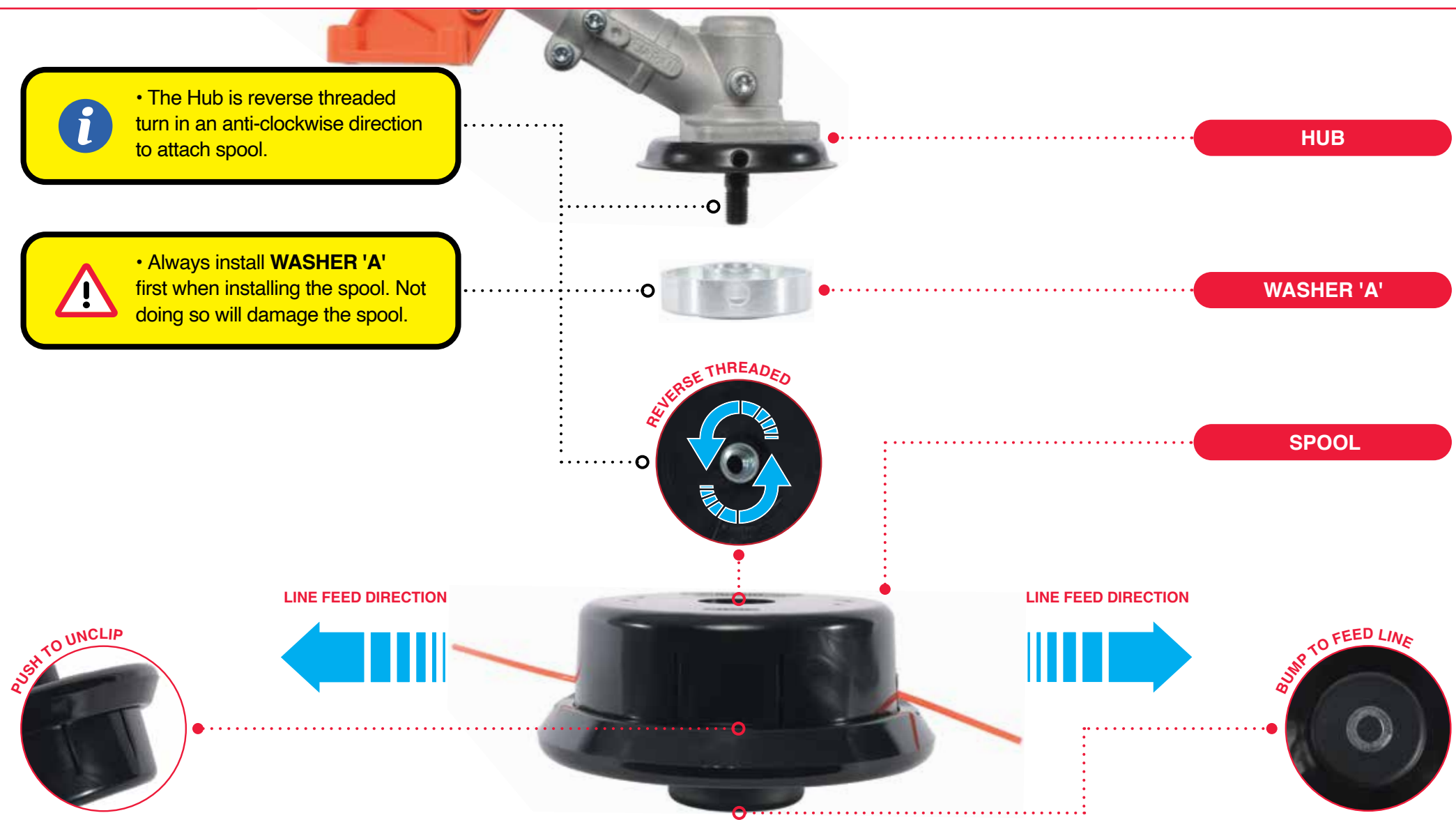

## OPEN & REPLACE SPOOL LINE

### 1 OPEN THE SPOOL



Open the spool by pressing one of the two clips to loosen the cover. Once loose firmly press the second clip and remove the spool cartridge from inside the housing.

### 2 REPLACE SPOOL LINE

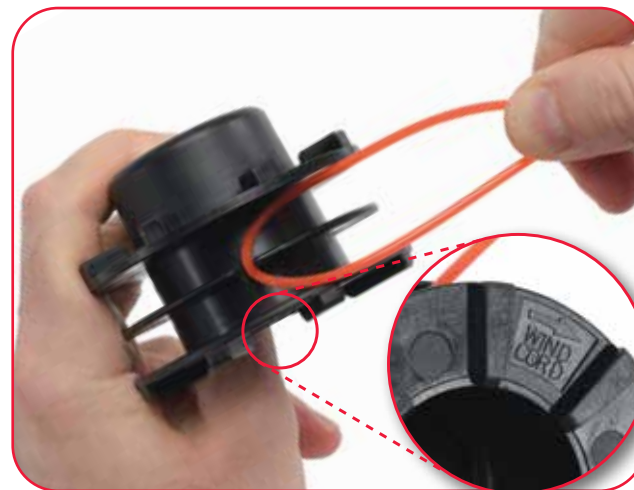

Secure the replacement spool line to the cartridge as shown. The cartridge consists of two compartments in which the spool line needs to be wound. Wind in the direction shown on the body of the cartridge.

### 3 SECURE SPOOL LINE

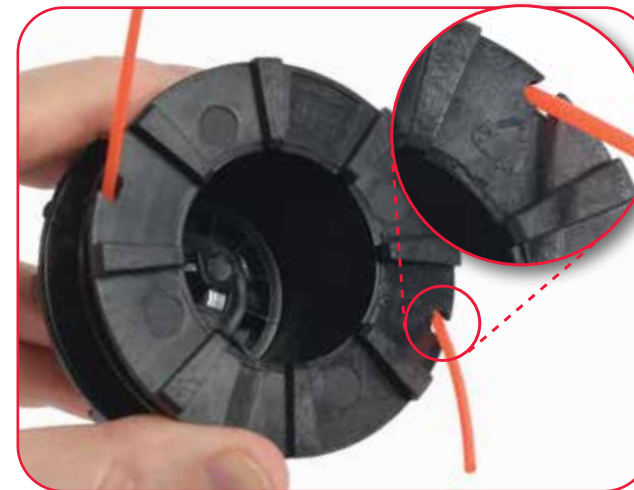

Secure the spool line inside one of the two lugs on the body of the cartridge to prevent it unwinding.

### 4 REPLACE CARTRIDGE



Place the cartridge into the spool cover and line up the ends of the spool line with the metal eyelets. Remove the spool line from the lugs on the spool cartridge and position them into the metal eyelets on the the spool cover.

### 5 REATTACH SPOOL COVER



With the the spool line now replaced and the cartridge placed within the spool cover carefully attach the spool cover to the spool body

### 6 REPLACEMENT COMPLETE



Having sucessfully replaced the spool line and the unit reassembled correctly you are now free to start using the spool again.

**i NOTICE** • Replacement trimmer wire should be 2.4mm in diameter.



TRIMMING GRASS AND WEEDS

1. Hold the unit so the head is off the ground and is tilted about 20 degrees toward the sweep direction.
2. Sweep from left to right to avoid thrown debris.
3. Use a slow, deliberate action to cut heavy growth.
4. Never swing the unit hard as you are in danger of losing your balance or control of the unit.
5. Try to control the cutting motion with your hip rather than placing the full workload on your arms and hands.
6. Take precautions to avoid wire, grass and dead, dry, long-stem weeds from wrapping around the shaft head.

Such materials can stall the head and cause the clutch to slip, resulting in damage to the clutch system if repeated frequently.

CUTTING METHOD

1. Use the front left side for optimal cutting.
2. Guide the blade from your right to left with it tilted slightly to your left.
3. When mowing a wide area, start working from your left end to avoid interference of cut grass.
4. The blade may be seized by weeds if the engine speed is too low, or the blade cuts too deep into weeds. Adjust the engine speed and cutting depth according to the type of material being cut.

**!** If grass or other object get caught in the blade, or if the unit starts to shake or vibrate, turn off the engine and check the whole unit. Change the blade if it has been damaged.

**!** Turn off the engine and make sure the blade has completely stopped before checking the blade and removing any object that has got caught in.



**WARNING!**

- Always wear eye protection during operation.
- Never lean over rotating cutting head.
- Never swing the unit hard as you are in danger of losing your balance or control of the unit.

CHOOSE THE BLADE

Choose the suitable recommended cutting attachment according to the object to be cut

When replacing blade always be sure to use Parker Brand products.

When sharpening, removing, or attaching the blade, be sure to wear thick, sturdy gloves and use only proper tools and equipment to prevent injury.

ADJUSTING THE LINE LENGTH

Your brush cutter is equipped with a semi-auto type nylon trimmer head that allows the operator to advance the line without stopping the engine. When the line becomes short, lightly tap the head on the ground while running the engine at full throttle.

Each time the head is bumped, the line advances about 1 inch (25.4mm). For better effect, tap the head on bare ground or hard soil. Avoid bumping in thick, tall grass as the engine may stall by overload.

**TWIN LINE SPOOL** ● ..... ○  
Use this for light trimming.

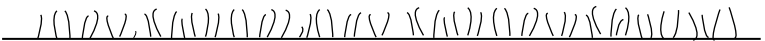

**3 TOOTH BLADE** ● ..... ○  
Use this blade for dense growth.



CONTROLLING BLADE THRUST

Blade thrust can cause serious personal injury. Carefully study this section. It is important that you understand what causes blade thrust, how you can reduce the chance of it, and how you can remain in control of the unit if blade thrust occurs.

WHAT CAUSES BLADE THRUST?

- Blade thrust can occur when the moving blade come in contact with an object that it cannot cut. This contact causes the blade to stop for an instant and then suddenly move or "bounce" away from the object that was hit. The operator can lose control of the unit and the blade can cause serious personal injury to the operator, or any person nearby if the blade contacts any part of the body.

HOW YOU CAN REDUCE THE CHANCE OF BLADE THRUST?

- Recognise that the blade thrust can happen. By understanding and knowing about blade thrust you can help eliminate the element of surprise

- Cut fibrous weeds and grass only. Do not let the blade contact materials it cannot cut such as hard, woody vines, and bushes or rocks, fences, metal etc.
- Be extra prepared for thrust if you must cut where you cannot see the blade making contact such as in areas of dense growth.
- Keep the blade sharp. A dull blade increases the chance of thrust.
- Avoid feeding the blade too rapidly. The blade can bounce away from material being cut if the blade is fed faster than its cutting capability.
- Cut only from your right to your left.

HOW YOU CAN MAINTAIN CONTROL?

- Keep a good, firm grip on the unit with both hands. A firm grip can help neutralise thrust. Keep your right and left hands completely around the respective handles.
- Keep both feet spread apart in a comfortable stance and yet braced for the possibility that the unit could bounce. Do not overreach. Keep firm footing and balance.

OPERATION

1. Check the bolt to fasten the blade and be sure the bolt has no faults or damage.
2. Be sure that the blade and the holder have been fastened according to instruction and that the blade turns smoothly without abnormal noise.

The rotating parts fastened incorrectly may cause serious injury to the operator.

Make sure that the blade is not bent, warped, cracked, broken or damaged.

If you find any error to the blade, discard it and replace with a new one.

Make sure to use the harness and cutting attachment guard. If not, it is very dangerous when you slip or lose your balance.

TRANSPORTING THE UNIT

- When you finish cutting in one location and wish to continue work in another spot, turn off the engine, lift up the unit and carry it, paying attention to the blade.
- Never forget to place the protective cover over the blades while transporting.
- When transporting the unit over long distances, detach the blade and fasten the unit by ropes.

STORING THE UNIT

- Always drain the machine of fuel before long or short term storage.
- Run dry by emptying the fuel tank, starting the engine and running until the machine stops.
- Running the machine dry of any fuel will prevent blockages within the fuel system and ensure an easy start when next in use.

TROUBLESHOOTING

PROBLEM	POSSIBLE CAUSE	SOLUTION
Engine will not start	No spark	To check for spark: Disconnect the spark plug wire. Reattach the spark plug wire and lay spark plug on metal cylinder. Pull the starter rope and watch for spark at spark plug tip. If there is no spark, repeat test with a new spark plug
	No fuel	Push primer bulb until bulb is full of fuel. If bulb does not fill, primary fuel delivery system is blocked. Contact a service dealer. If primer bulb fills, engine may be flooded (see next item)
	Flooded engine	Remove spark plug, turn trimmer so spark plug hole is aimed at the ground. Move choke lever to “RUN” and pull starter cord 10 to 15 times. This will clear excess fuel from engine. Clean and reinstall spark plug. Pull starter three times with choke lever at “RUN”. If engine does not start, move choke lever to “CHOKE” and repeat normal starting procedure. If engine still fails to start, repeat procedure with a new spark plug
	Starter rope pulls harder now than when new	Contact: help@parkerbrand.co.uk
Engine starts but will not accelerate	Carburettor requires adjustment	Contact: help@parkerbrand.co.uk
Engine starts but will cut out when the throttle is pressed	Choke is in start/closed position	When the engine is running the choke should remain open (the downwards position)

TROUBLESHOOTING

PROBLEM	POSSIBLE CAUSE	SOLUTION
Engine starts but will only run at high speed at half choke	Carburetor requires adjustment	Contact: help@parkerbrand.co.uk
Engine does not reach full speed and emits excessive smoke	Check oil fuel mixture	Use fresh fuel and the correct 2-cycle oil mix
	Air filter dirty	Clean air filter in warm soapy water. Fully dry and replace in filter housing
	Carburettor requires adjustment	Contact: help@parkerbrand.co.uk
Engine starts, runs, and accelerates but will not idle	Carburettor requires adjustment	Contact: help@parkerbrand.co.uk
Spool will not unwind	String welded to itself	Lubricate with silicone spray
	Not enough string on spool	Install more string. Refer to “Open & Replace Spool Line” earlier in this manual

TROUBLESHOOTING

PROBLEM	POSSIBLE CAUSE	SOLUTION
Spool retainer hard to turn	<i>Screw threads dirty or damaged.</i>	Clean threads and lubricate with grease - if no improvement, replace spool retainer
Oil drips from muffler	<i>Operating trimmer at part throttle</i>	Operate trimmer at full throttle
	<i>Check oil/fuel mixture</i>	Use fresh fuel and the correct 2-cycle oil mix
	<i>Air filter dirty</i>	Clean air filter in warm soapy water. Fully dry and replace in filter housing
	<i>Carburettor requires adjustment</i>	Turn mixture needle clockwise 1/16 turn
Spool / Three Tooth Blade does not rotate when engine speed is increased	<i>Top and bottom shafts are not correctly engaged.</i>	Remove the bottom shaft and re-insert ensuring the joint is correctly connected and engaged.
Excessive vibration is felt when using the three tooth blade	<i>Top and bottom shafts are not correctly engaged</i>	Remove the bottom shaft and re-insert ensuring the joint is correctly connected and engaged.
	<i>Three tooth blade is not installed centrally</i>	Reinstall the three tooth blade ensuring the blade is installed centrally and with the correct washers

TROUBLESHOOTING

PROBLEM	POSSIBLE CAUSE	SOLUTION
Spool will not unwind	<i>String welded to itself</i>	Lubricate with silicone spray
	<i>Not enough string on spool</i>	Install more string. Refer to “Open & Replace Spool Line” earlier in this manual
Grass wraps around shaft housing and string-head	<i>Cutting tall grass at ground level</i>	Cut tall grass from the top down
	<i>Operating trimmer at part throttle</i>	Operate trimmer at full throttle



1

SCAN QR CODE TO ACCESS ONLINE RESOURCES LIBRARY

HELPFUL PRODUCT RESOURCES

Gain access to the ParkerBrand online resource library for this product.

Resources include Detailed descriptions of products, literature, articles and video tutorials.

Simply scan the QR Code with your mobile devices camera.

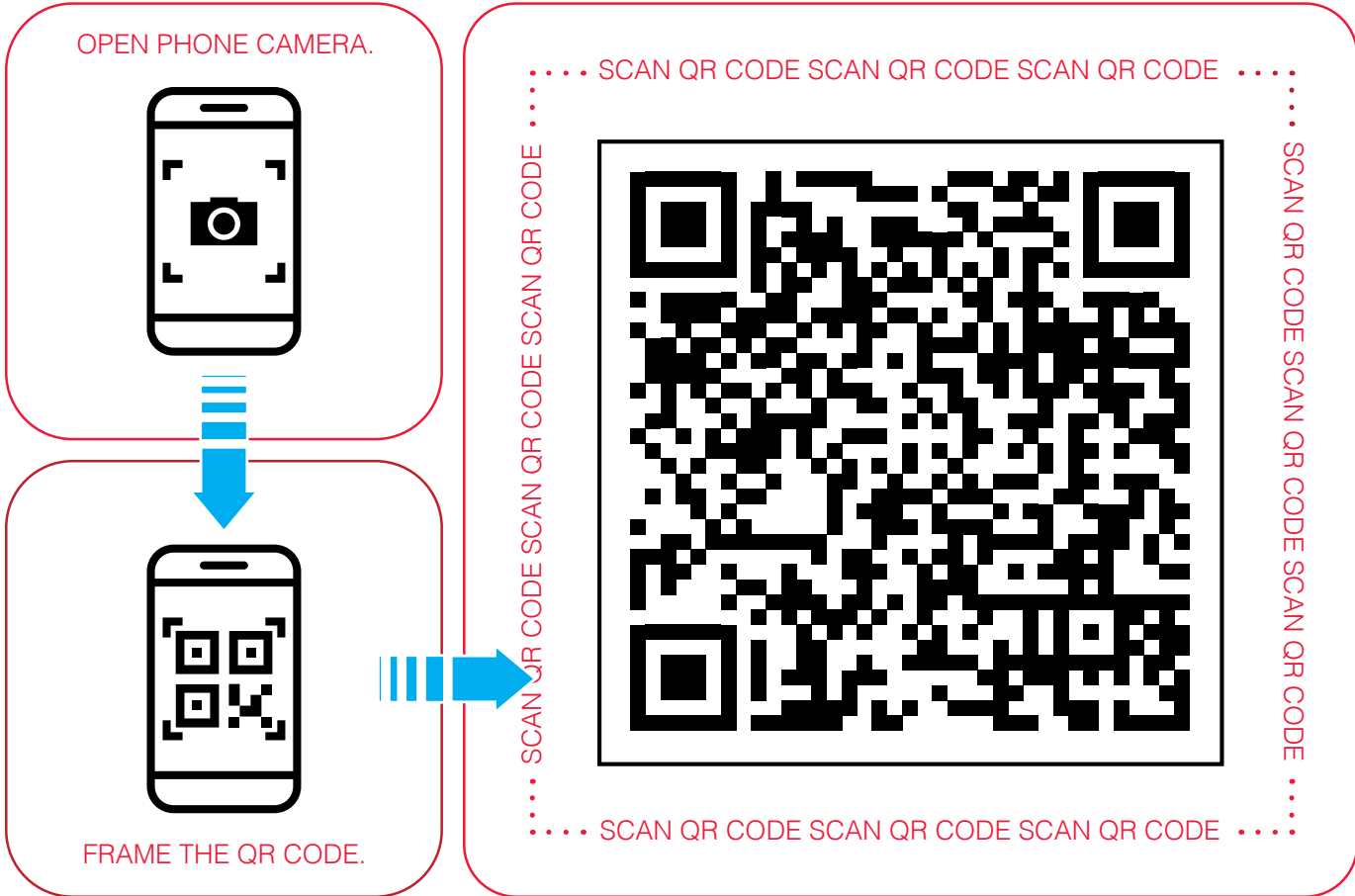

2

TAP POP-UP



Tap the link/pop up that displays after scanning the QR code. It will take you directly to the product page for this machine on the ParkerBrand website.

3

SCROLL DOWN PAGE

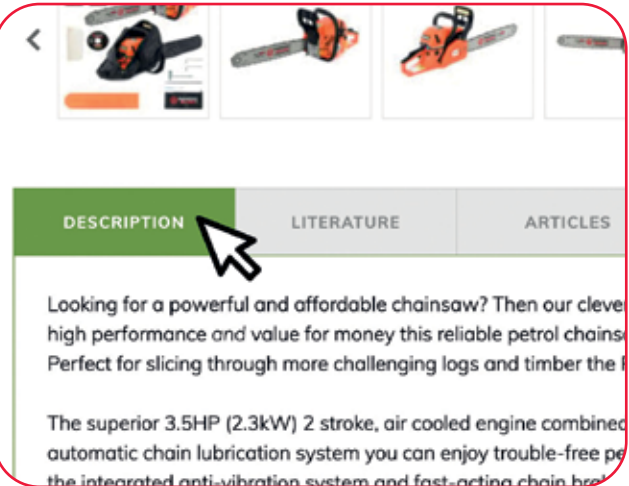

Scroll down the product page to the product description box. Take note of the green tab and the greyed out tabs along the top of the description box.

4

SELECT A RESOURCE

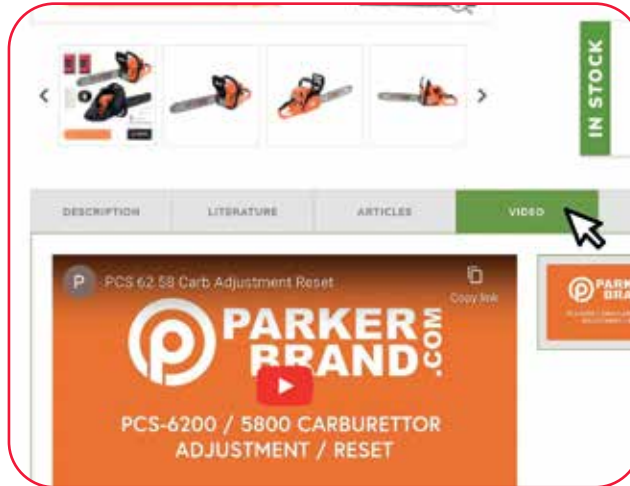

Click on the tab for the resource you'd like to access. Choose from **description**, **literature**, **articles** and **video**. your chosen resource tab will be highlighted in green.



NOTICE

- No resources for your product? Don't worry we are adding new content all the time.
- If you require help/advice with your product contact us via email at [help@parkerbrand.co.uk](mailto:help@parkerbrand.co.uk)

MAINTENANCE & CARE

ENGINE			Before starting work	After finishing work or daily	After each refuelling stop	Weekly	Monthly	Yearly	If problem	If damaged	As required
	Air Filter	Clean							X		X
		Replace								X	
	Manual fuel pump (if fitted)	Check									
		Have repaired by servicing dealer									
	Pickup body in fuel tank	Check							X		
		Replace					X			X	X
	Gearbox Lubrication	Check				X			X		X
		Replenish								X	

MAINTENANCE & CARE

ENGINE			Before starting work	After finishing work or daily	After each refuelling stop	Weekly	Monthly	Yearly	If problem	If damaged	As required
	Carburettor	Check idle adjustment – the cutting attachment must not rotate	X		X						
		Adjust idle speed									X
	Spark Plug	Readjust electrode gap							X		
		Replace after every 100 operating hours									
	Cooling Inlets	Visual inspection		X							
		Clean									X
	Fuel Tank	Clean	X						X		
	Air Filter	Clean	X								
	Fuel Filter	Clean	X								

OTHER			Before starting work	After finishing work or daily	After each refuelling stop	Weekly	Monthly	Yearly	If problem	If damaged	As required
	Complete machine	Visual inspection (condition, leaks)	X		X						
		Clean		X							
	Cutting Attachment	Visual inspection	X		X						
		Replace								X	
		Check tightness	X		X						
	Cutting Attachment Guard	Attach	X								
	Control Handle	Check operation	X		X						
	Metal Cutting Attachment	Sharpen	X								X
	All accessible screws and nuts	Re-tighten	X								X
	Anti-vibration Elements	Check	X						X		X

SPARK PLUG MAINTENANCE

- Once the engine has cooled, twist off the spark plug cover/coil pack lead.
- Carefully remove the spark plug using the spark plug wrench supplied.
- Clean the spark plug with a wire brush (not supplied) to remove any deposits.
- Using a feeler gauge set the gap between 0.5 of 0.7mm.
- Install the spark plug carefully by hand being careful not to cross the threads.
- After the spark plug is seated correctly, tighten with the wrench supplied.

1 SET SPARK PLUG GAP



SET THE SPARK PLUG GAP BETWEEN

0.5mm - 0.7mm



**WARNING!**

• Never touch the coil pack/spark plug when the machine is running as there is a risk of electric shock.





**ORDER ONLINE**

VISIT OUR ONLINE STORE FOR ALL YOUR  
SPARE PARTS & CONSUMABLE NEEDS.

OUR PARTS DEPARTMENT IS EXSTENSIVE,  
WE STOCK PARTS FOR ALL OF OUR  
PRODUCTS.

SCAN THE QR CODE TO ACCESS  
SPARE PARTS FOR THESE  
PRODUCTS.

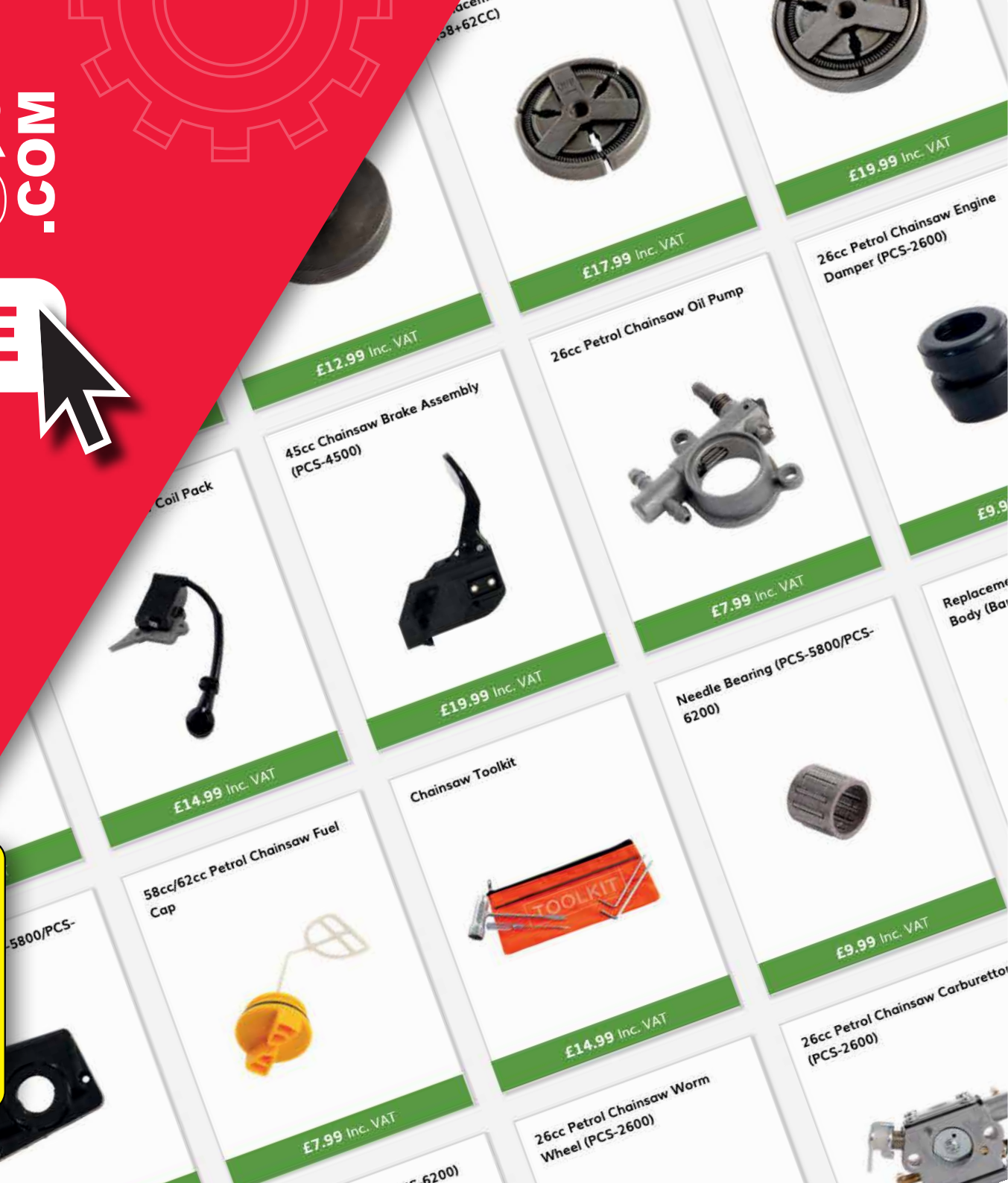
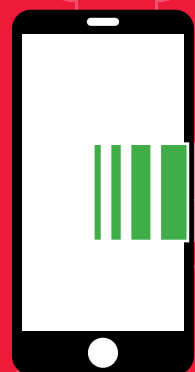

# CUSTOMERSERVICE

**PARKERBRAND CONGRATULATE YOU ON YOUR CHOICE OF EQUIPMENT.**

We know that you'll be excited to start using your machine and becoming familiar with it. We take time to produce useful manuals that serve you well. You'll find useful information on the further care and maintenance of your machine in your manual. We'd also like to assure you that we'll take care of you, should you need our assistance.

You will find useful resources on the ParkerBrand website ([www.parkerbrand.co.uk](http://www.parkerbrand.co.uk)) which you will find listed under articles or videos on the product page. Should you wish to speak with someone in person then we are very happy for you to call us.

Our Customer Service team are based in Louth, Lincolnshire and will be happy to speak with you to provide assistance. You can call on **(+44) 01507 499198** during office hours.

You are of course very welcome to email us at any time and a member of the team will respond. You can email us at the following address: [help@parkerbrand.co.uk](mailto:help@parkerbrand.co.uk)

We know that taking care of our customers in a helpful and straightforward manner is much appreciated, just as you, our customer are appreciated in turn.

Thank you for buying ParkerBrand we are here if you need us, be sure of it.



**(+44) 01507 499198**



**[help@parkerbrand.co.uk](mailto:help@parkerbrand.co.uk)**



**[www.parkerbrand.co.uk](http://www.parkerbrand.co.uk)**



ENGINE:	10mm
<i>Model</i>	1E44FA
<i>Displacement</i>	52,0cm3
<i>Fuel</i>	Mixture (Gasoline 40: Oil 1)
<i>Carburettor</i>	Diaphragm type
<i>Ignition system</i>	Transistor Controlled Flywheel Magneto
<i>Spark plug</i>	LD BM6A
FUEL TANK CAPACITY (CM)	1.2 Litres
STARTER	Recoil
CLUTCH	Centrifugal
CUTTING HEAD ROTATING DIRECTION	Counter-Clockwise (Operator View)
3 TOOTH BLADE SIZE	1.4 x 255 x 254
SPOOL WIRE SIZE	2.4mm
OVERALL SIZE (L X W X H)	1860 x 610 x 520mm
DRY WEIGHT	8.5kg

Parker Products Ltd Guarantees the product against defective material or damage for period of 12 months from the date of purchase. A proof of purchase must be provided with the product.

In case of any fault please return the product to Parker Products Ltd or an authorised repair agent.

If any fault is caused by defective materials or quality of build, repair will be carried out free of charge. However, this guarantee does not apply in the case of normal wear and tear, nor any damage caused by misuse, accident or any repair from an unauthorised agency.

**NOTE:** In order for you to effect this guarantee you must provide proof of purchase in the form of a dated receipt or invoice within a 12 month period of purchase. If repairs are outside of the warranty period a quote will be made accordingly.

Parker Products Limited

THIS PAGE HAS INTENTIONALLY BEEN LEFT BLANK

**Description & Function:** 52cc Petrol Brush Cutter

**Model/Type:** PGBC-5200

**Manufacturing Date/Serial Number:** 2023

**Conforms to the following Directives:**

- ☒ 2006/42/EC Machine Directive (MD)
- ☒ 2014/30/EU Electromagnetic Compatibility Directive (EMC)
- ☒ EU 2016/1628 Directive of Emission
- ☒ 2000/14 EC & 2005 /88 EC Directive of EU Noise

**Manufacturer’s authorised representative within the EC:**

Parker Products Ltd.  
Richmond Park, Richmond Road  
Louth, LN11 0FU

**Telephone:** 01507 499198

**Email:** help@parkerbrand.co.uk

**Web:** www.parkerbrand.com

DECLARATION OF CONFORMITY

**Conforms to the requirements of the Directives, as indicated, and the following harmonised standard(s):**

- ☒ EN ISO 11681 - 1:2011
- ☒ EN ISO 14982 - 2009
- ☒ EN ISO 3744 - 1995
- ☒ EN ISO 9207 - 1995

**EC type-approved No:**

e24\*2016/1628\*2018/989SHB1/P\*0376\*00 (EU-V emission)

**Technical file complied by:** Parker Products Ltd

Being the responsible person appointed by the manufacturer.

**Signed:**



**Date:** 01/01/24

**Name:** Jason Parker

**Position:** Managing Director



**PGBC-5200**

*January 2024*

*Rev 2.0*